

FOR LEASE
3,900 SF

**PRIME END-CAP
RETAIL SPACE**

NWC SCRIPPS POWAY PKWY
& SCRIPPS SUMMIT DR.
SAN DIEGO, CA 92131



SUBJECT



VIC GAUSEPOHL
Senior Vice President
Lic. No. 01070105
+1 760 930 7912
vic.gausepohl@colliers.com

KIRK ALLISON
Senior Vice President
Lic. No. 01049184
+1 760 930 7922
kirk.allison@colliers.com

SCRIPPS RANCH
PRIME RETAIL END-CAP SPACE

12030 SCRIPPS SUMMIT DR., SAN DIEGO, CA 92131

PROPERTY FEATURES

- › Prime corner location shopping center at the intersection of Scripps Poway Parkway and Scripps Summit Drive
- › Services the affluent Scripps Ranch/Poway trade area
- › Tenant's include: Panda Express, Subway, Santana's Restaurant and others
- › Protected from retail competition
- › Traffic: Scripps Poway Parkway: 48,600 ADT
- › Excellent mix of retail, restaurant and service tenants
- › Located at the main entrance into Scripps Northridge Technology Plaza featuring, Home Depot (Regional HQ) Titan, etc.

AVAILABILITIES

	Size	Comments
Suite A	3,900	High exposure end-cap location



FOR LEASE > 3,900 SF

**NWC SCRIPPS POWAY PKWY & SCRIPPS SUMMIT DRIVE
SAN DIEGO, CA 92131**

VIC GAUSEPOHL
Senior Vice President
Lic. No. 01070105
+1 760 930 7912
vic.gausepohl@colliers.com

KIRK ALLISON
Senior Vice President
Lic. No. 01049184
+1 760 930 7922
kirk.allison@colliers.com



Scripps Poway Parkway

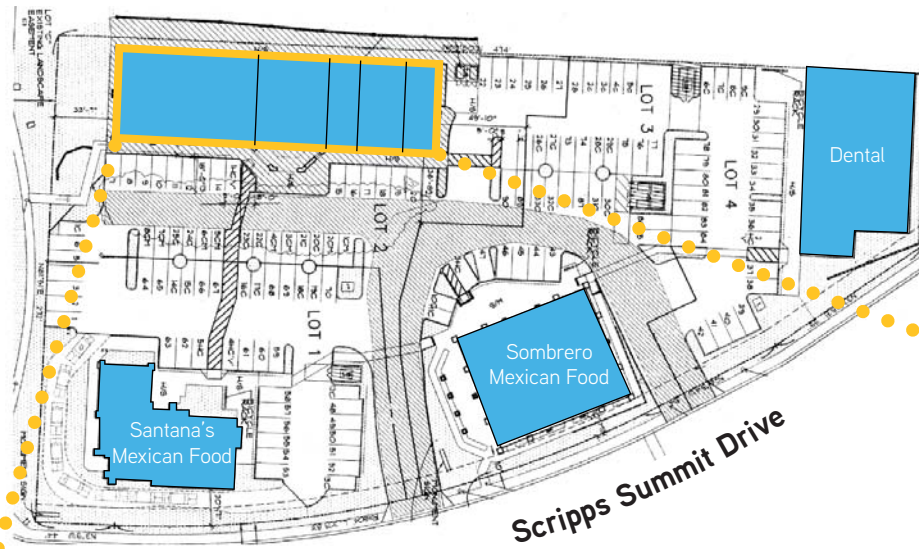

Scripps Summit Drive

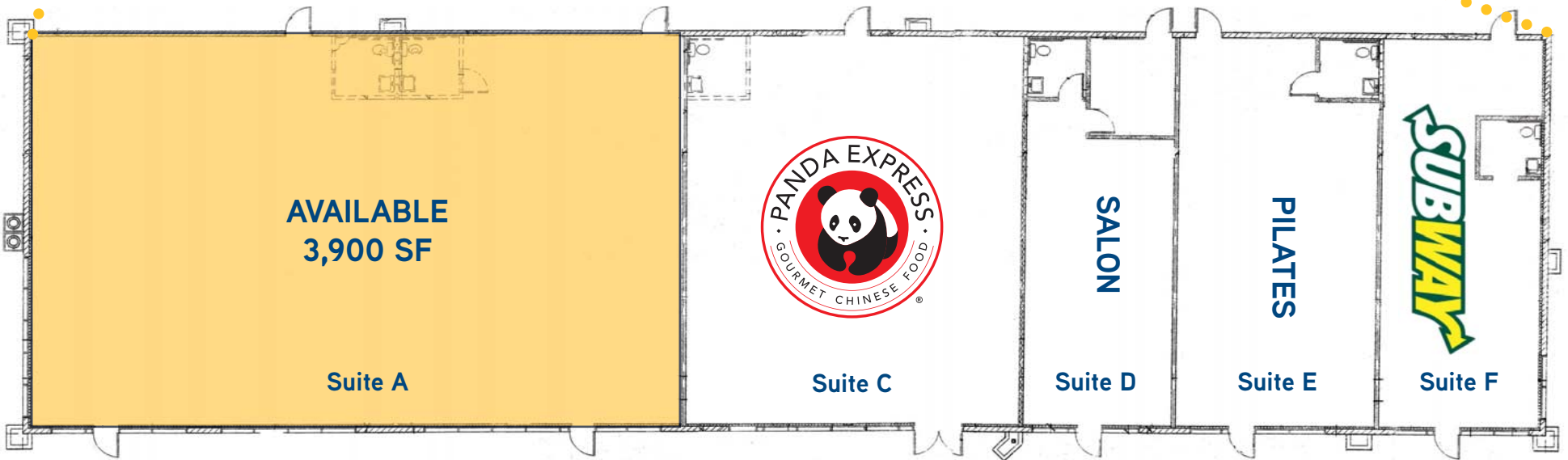

FOR LEASE > 3,900 SF

NWC SCRIPPS POWAY PKWY & SCRIPPS SUMMIT DRIVE
SAN DIEGO, CA 92131

VIC GAUSEPOHL
Senior Vice President
Lic. No. 01070105
+1 760 930 7912
vic.gausepohl@colliers.com

KIRK ALLISON
Senior Vice President
Lic. No. 01049184
+1 760 930 7922
kirk.allison@colliers.com

