

# 215 W 131ST ST

Unincorporated LA County, (Gardena P.O.)

# For Lease

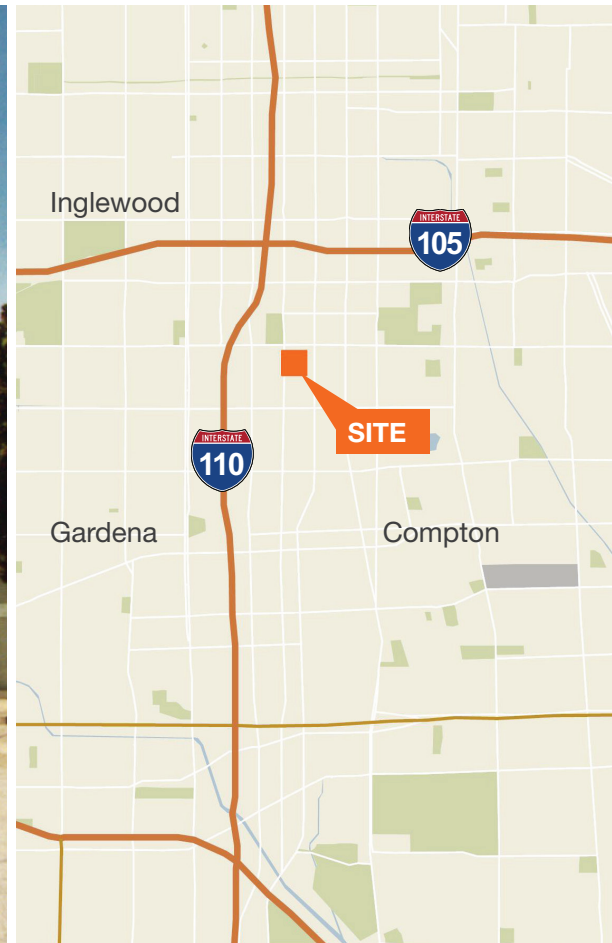

Property is located in Unincorporated Los Angeles County within the 2nd District Cannabis Users Area.

## FEATURES

SITE		BUILDING	
APN	6132-040 & 021	Size	17,698 SF
Year Built	1961, Refurbished 2017	Construction	Brick
Zoning	M1LA	Clear Height	14'
Thomas Guide	734-D2	Power	400 A, 240 V, 3 Phase

## CONTACT

**John Bowman, SIOR**  
562.472.0235  
jbowman@kiddermathews.com  
Lic# 00477934

**Elliot Harkness, CCIM, GLS**  
562.472.0232  
elliioth@kiddermathews.com  
Lic# 01785170

[kiddermathews.com](http://kiddermathews.com)

This information supplied herein is from sources we deem reliable. It is provided without any representation, warranty or guarantee, expressed or implied as to its accuracy. Prospective Buyer or Tenant should conduct an independent investigation and verification of all matters deemed to be material, including, but not limited to, statements of income and expenses. Consult your attorney, accountant, or other professional advisor.



215 W 131st St

For Lease

SITE PLAN

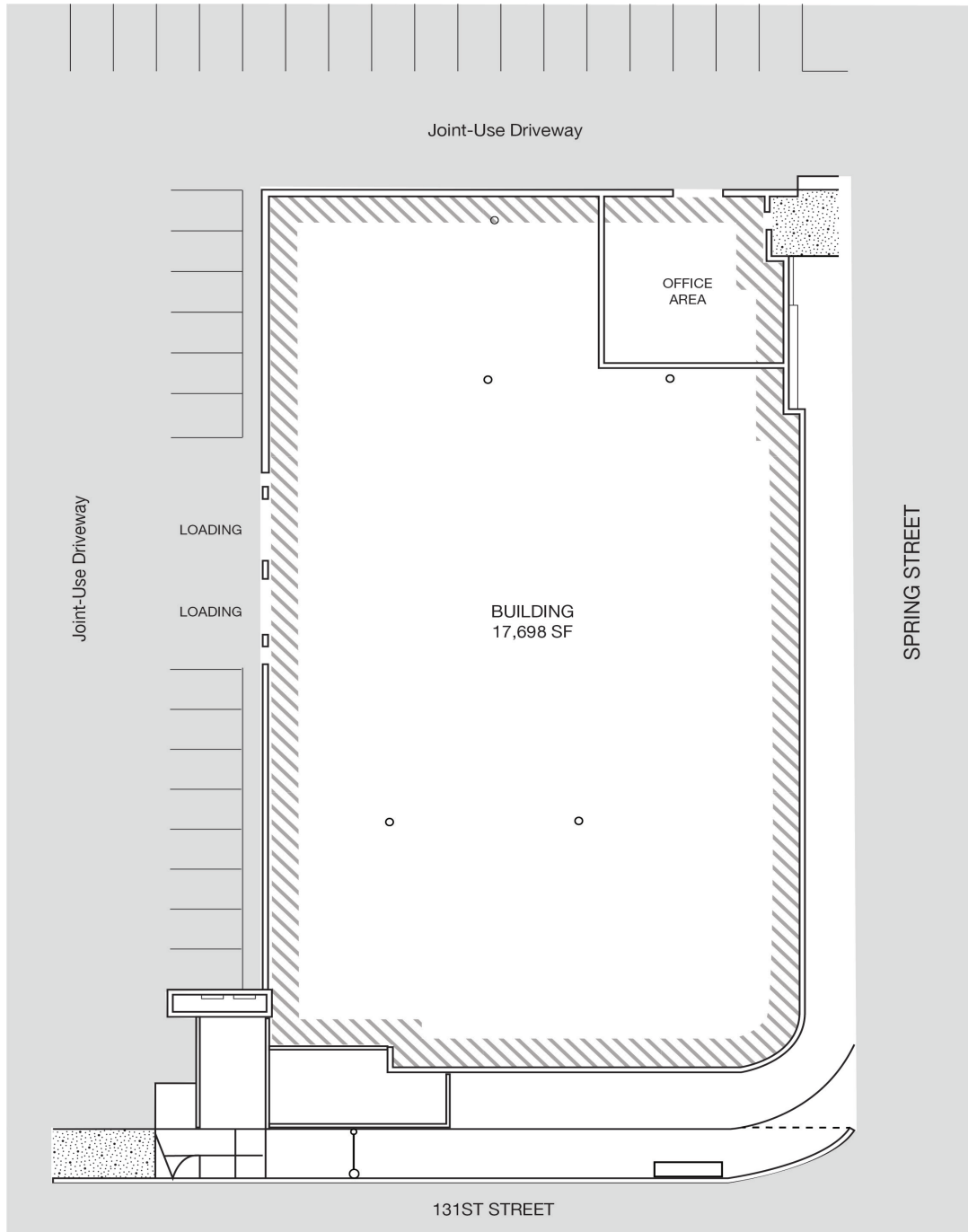

CONTACT

**John Bowman, SIOR**  
562.472.0235  
jbowman@kiddermathews.com  
Lic# 00477934

**Elliot Harkness, CCIM, GLS**  
562.472.0232  
elliioth@kiddermathews.com  
Lic# 01785170

This information supplied herein is from sources we deem reliable. It is provided without any representation, warranty or guarantee, expressed or implied as to its accuracy. Prospective Buyer or Tenant should conduct an independent investigation and verification of all matters deemed to be material, including, but not limited to, statements of income and expenses. Consult your attorney, accountant, or other professional advisor.

