

839

EMERSON STREET
PALO ALTO, CALIFORNIA



DOWNTOWN PALO ALTO SMALL OFFICE BUILDING



CHERIE WITTRY 650.688.8523 cwittry@ngkf.com CA RE License #00863251

245 Lytton Avenue, Suite 150, Palo Alto, CA 94301

The distributor of this communication is performing acts for which a real estate license is required. The information contained herein has been obtained from sources deemed reliable but has not been verified and no guarantee, warranty or representation, either express or implied, is made with respect to such information. Terms of sale or lease and availability are subject to change or withdrawal without notice. 20-0471.08 /20



- ◆ ±1,080 SF - Available Now
- ◆ Great Building Identity and Signage
- ◆ All Open Office Floorplan - Room Area for Conferencing
- ◆ HVAC
- ◆ Seven (7) Parking Spaces (Includes 2 on Side of Building)
- ◆ Secure Bike Cage
- ◆ Downtown Palo Alto Location
- ◆ Contact Agent to Tour

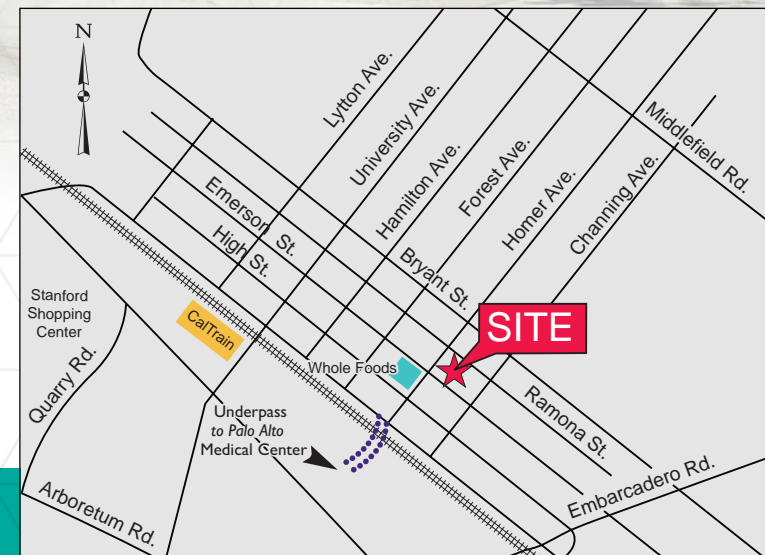

839
EMERSON STREET

CHERIE WITTRY 650.688.8523 cwittry@ngkf.com CA RE License #00863251

FLOORPLAN (NOT TO SCALE)

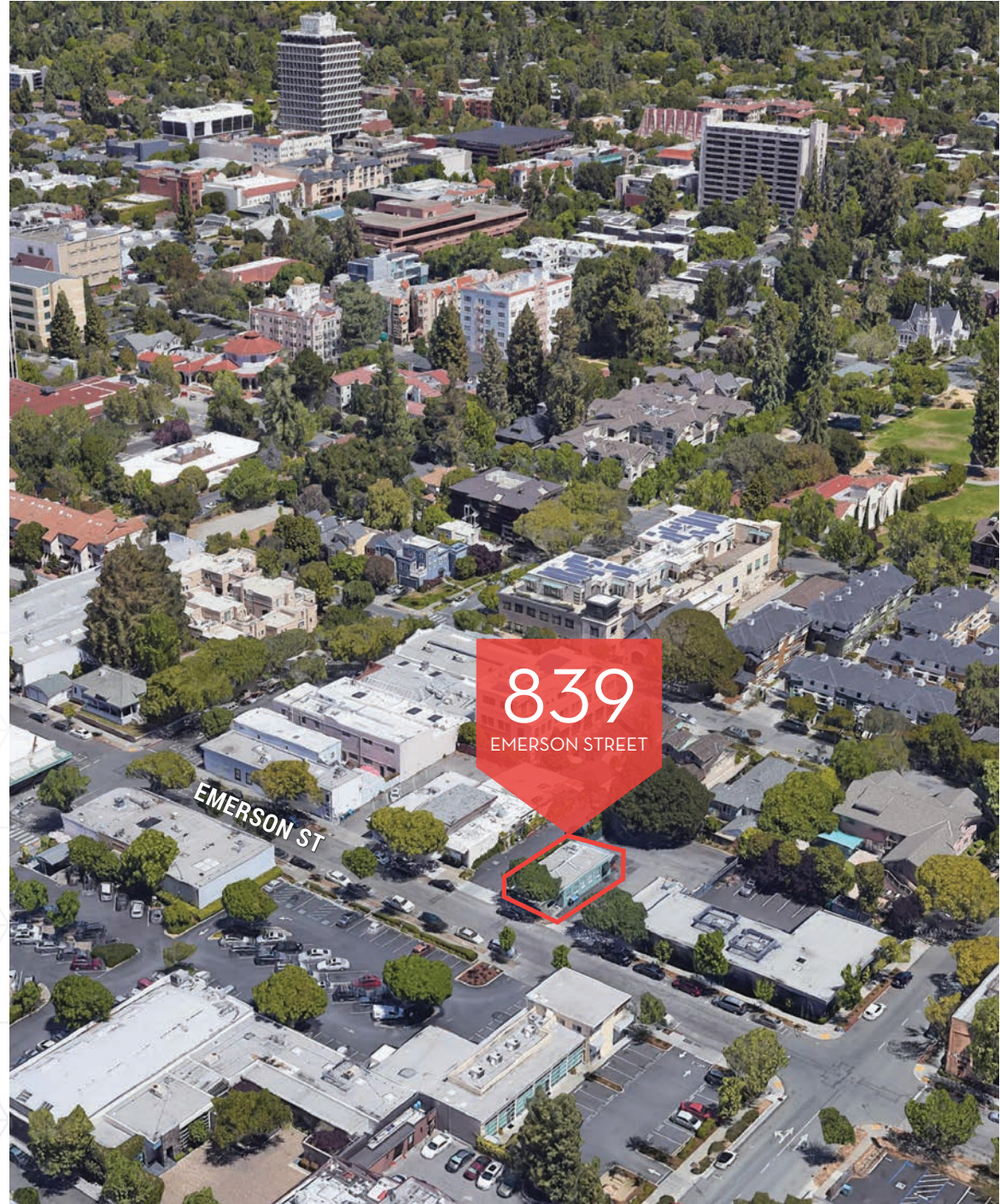
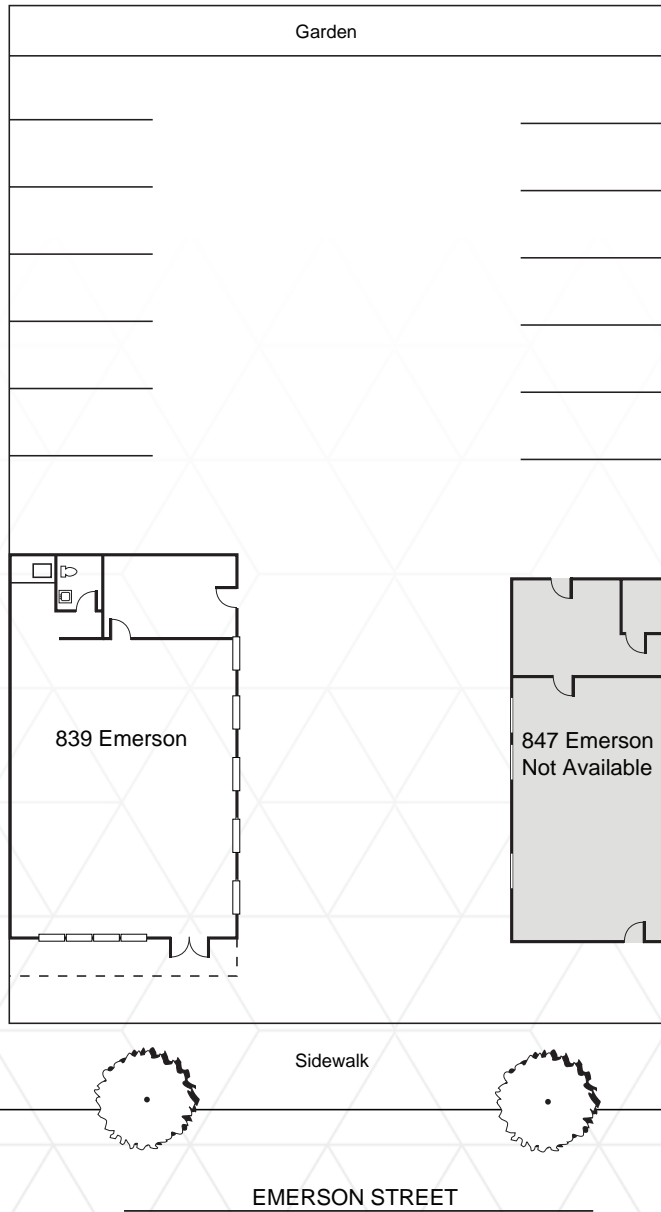

839
EMERSON STREET



839
EMERSON STREET

CHERIE WITTRY 650.688.8523 cwittry@ngkf.com CA RE License #00863251