

Mercury Tech Center

8125 Mercury Ct
Suite 100
San Diego, CA

Flex/R&D/Industrial
Business Park



Contact

Mickey Morera
858.369.3030
mmorera@kiddermathews.com
LIC #00950071

James Duncan
858.369.3015
jduncan@kiddermathews.com
LIC #01253770

Greg Kelly
858.369.3035
gkelly@kiddermathews.com
LIC #01754010

Features

- 7,411 SF end cap suite available
- 100% drop ceiling open area
- Potential for two grade level roll up doors
- Oversized skylight provides natural light throughout
- Fully sprinklered
- Robust fiber to project
- Abundant on-site and street parking
- \$3 million project renovation recently completed with new suites designed by Ware-Malcomb, new parking lots, new landscaping, new HVAC, upgraded exterior, new ADA upgrades
- IL-2-1 zoning allows a variety of uses
- Lease rate: \$1.20 NNN

Location

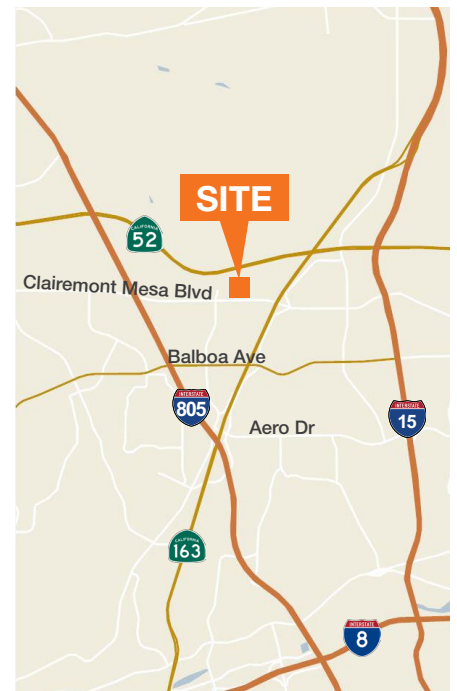

PROFESSIONALLY MANAGED BY



Mercury Tech Center

Site Plan

8125-8195 Mercury Court | Buildings 7, 8 & 9

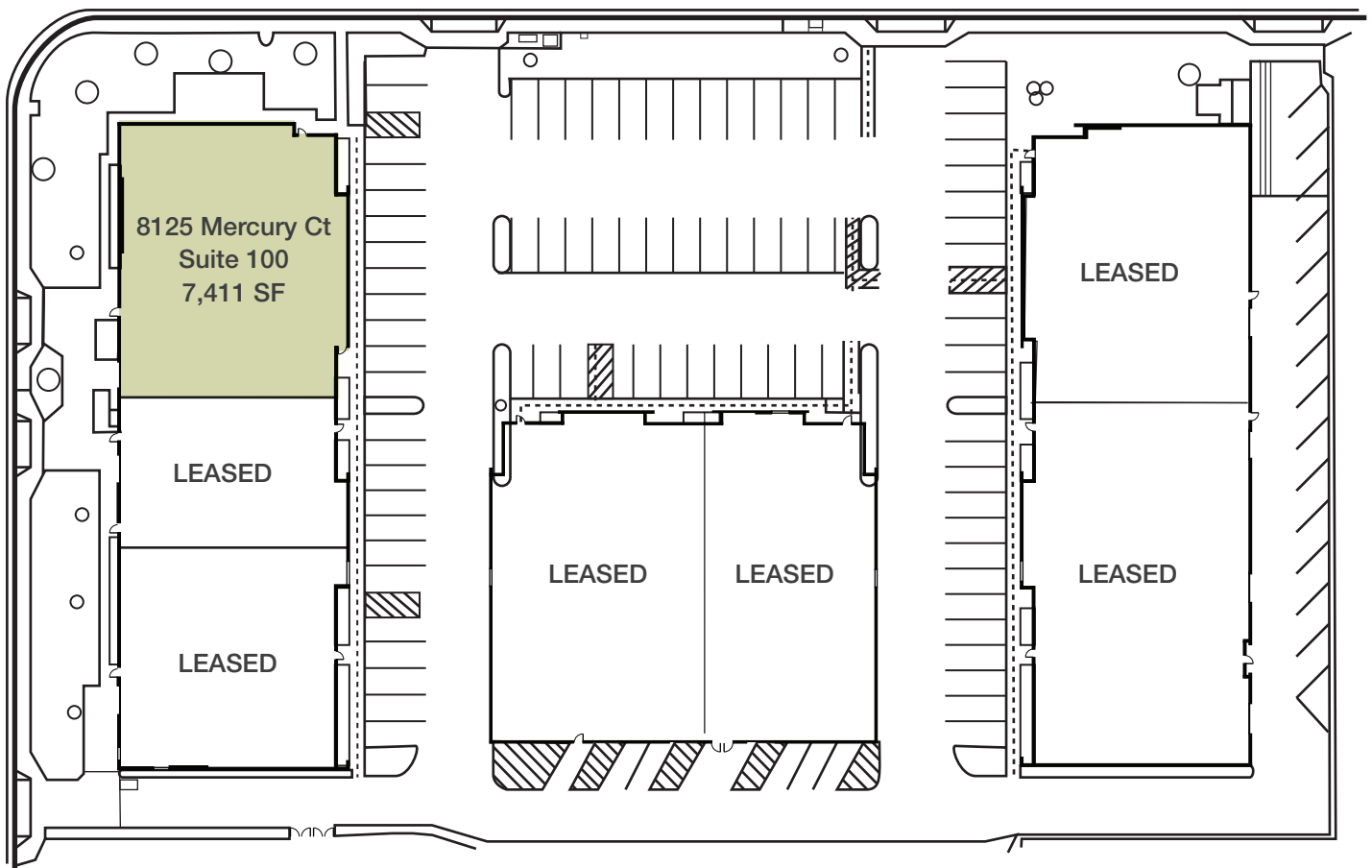

Contact

Mickey Morera

858.369.3030

mmorera@kiddermathews.com

LIC #00950071

James Duncan

858.369.3015

jduncan@kiddermathews.com

LIC #01253770

Greg Kelly

858.369.3035

gkelly@kiddermathews.com

LIC #01754010



Mercury Tech Center

Floor Plan

8125 Mercury Court

Suite 100
7,411 SF

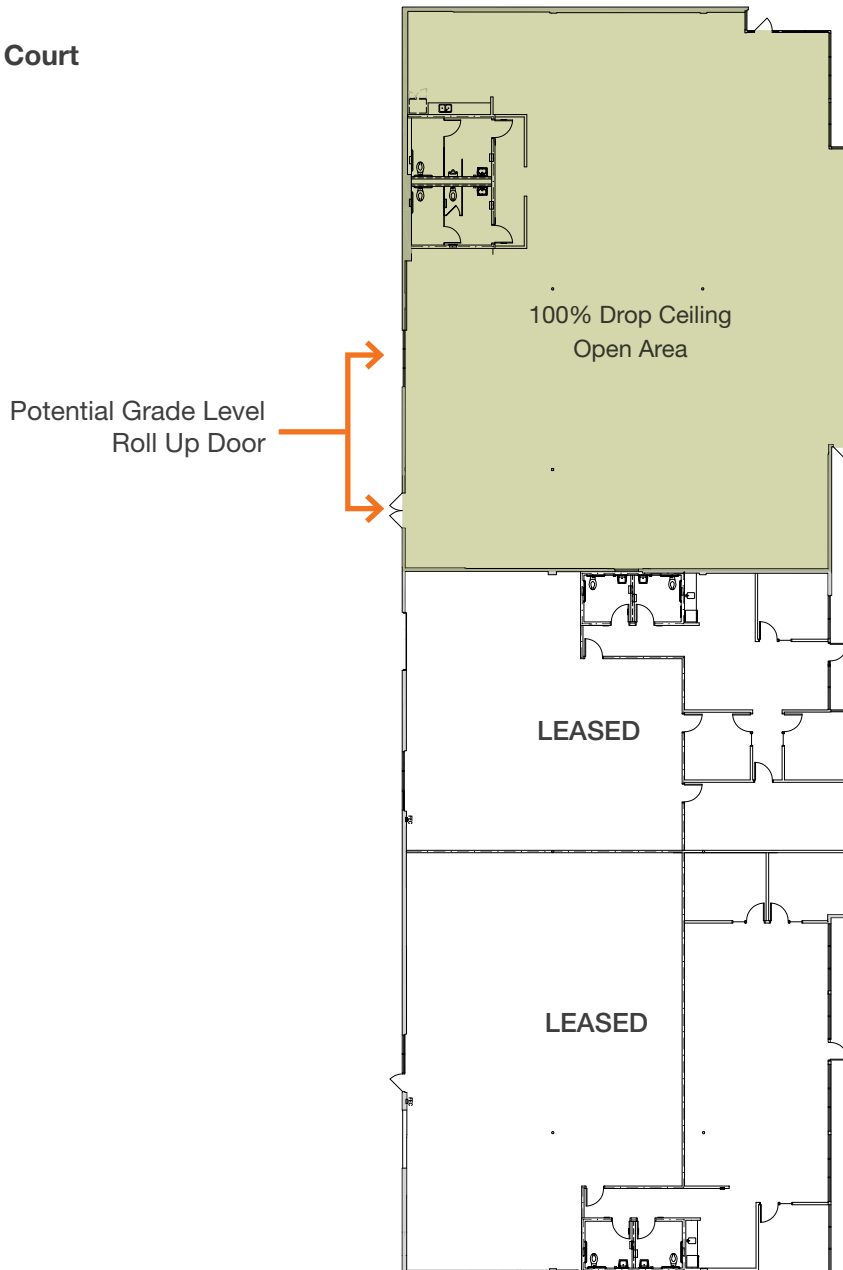

Contact

Mickey Morera

858.369.3030

mmorera@kiddermathews.com

LIC #00950071

James Duncan

858.369.3015

jduncan@kiddermathews.com

LIC #01253770

Greg Kelly

858.369.3035

gkelly@kiddermathews.com

LIC #01754010

PROFESSIONALLY OWNED
AND MANAGED BY



Mercury Tech Center

8125 Mercury Court, Suite 100



Contact

Mickey Morera

858.369.3030

mmorera@kiddermathews.com

LIC #00950071

James Duncan

858.369.3015

jduncan@kiddermathews.com

LIC #01253770

Greg Kelly

858.369.3035

gkelly@kiddermathews.com

LIC #01754010

PROFESSIONALLY OWNED
AND MANAGED BY

CIP REAL ESTATE

Mercury Tech Center



1. Chevron
2. Shell
3. 7-Eleven Gas Station
4. The Godfather Restaurant
5. Pho Fusion, Subway, Gualbertos Mexican Food, Sushi Hut, AT&T Express, Fast Keys, Chase ATM, Chaba Thai Kitchen, Crab Town
6. Burger King
7. Bull Pen Bar & Grill, Szechuan Taste, Yesenias Mexican Food, Korean BBQ (Do-Re-Mi)
8. Societe Brewing
9. Perky's
10. Mobil
11. California Bank & Trust
12. Residence Inn

Easily accessible location, just off Clairemont Mesa Blvd., and minutes from Freeways 52, 163, I-5 and I-805

Walking distance to abundant retail amenities

Contact

Mickey Morera

858.369.3030

mmorera@kiddermathews.com

LIC #00950071

James Duncan

858.369.3015

jduncan@kiddermathews.com

LIC #01253770

Greg Kelly

858.369.3035

gkelly@kiddermathews.com

LIC #01754010

PROFESSIONALLY OWNED
AND MANAGED BY

