

# For Sublease

2840 Guilder Drive, Suite 200, Plano, TX 75074  
± 10,500 SF AVAILABLE



## PROPERTY OVERVIEW

**County:** Collin  
**Market:** Northeast Dallas Industrial  
**Sub Market:** Plano Industrial

## BUILDING DATA

**Total Building SF:** 21,000 SF  
**Clear Height:** 20'  
**Sprinklered:** Fully Sprinklered  
**Year Built:** 2006

## LISTING DATA

**Available SF:** 10,500 SF  
**Warehouse SF:** 8,840 SF  
**Office SF:** 1,660 SF  
**Loading Docks:** 1 Dock High Door  
1 Ramped Door  
**Comments:** Excellent drive up appeal  
Easy access to I-75 & George Bush  
Sublease expires January 31, 2020

## ECONOMIC DATA

Contact Broker for Pricing

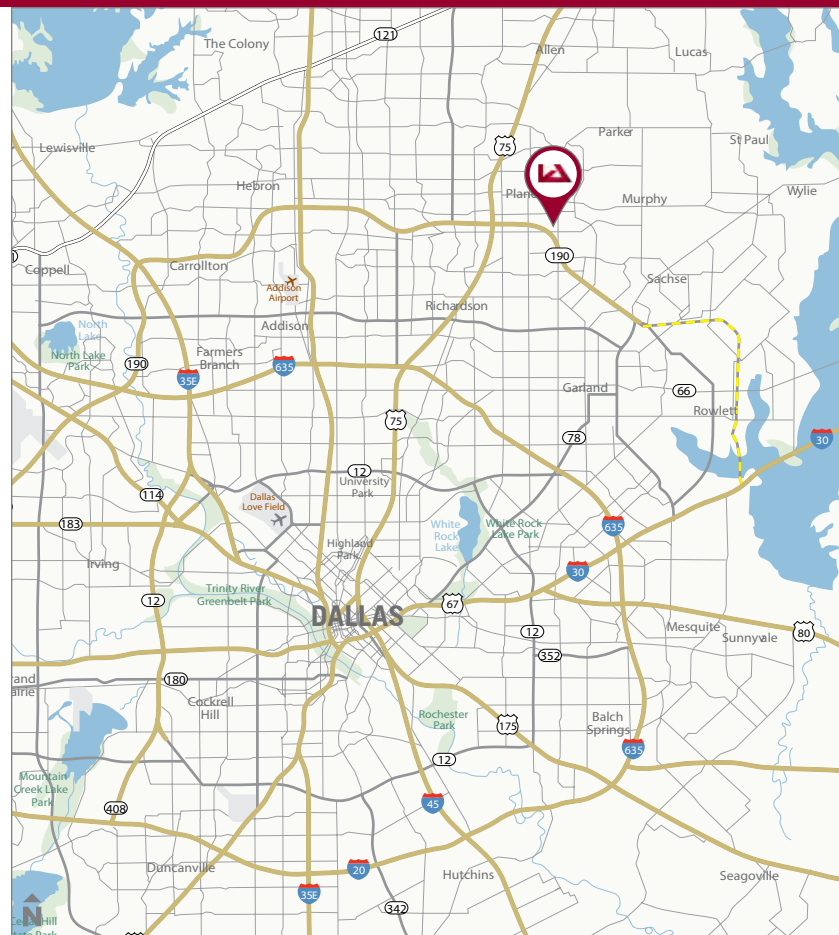

For more information contact:

**George Tanghongs, Principal** | **Brett Lewis, Principal**  
georget@lee-associates.com | blewis@lee-associates.com  
D 972.934.4008 | D 972.934.4018

**LEE & ASSOCIATES**  
COMMERCIAL REAL ESTATE SERVICES

lee-associates.com



# For Sublease

## 2840 Guilder Drive, Suite 200, Plano, TX 75074

± 10,500 SF AVAILABLE

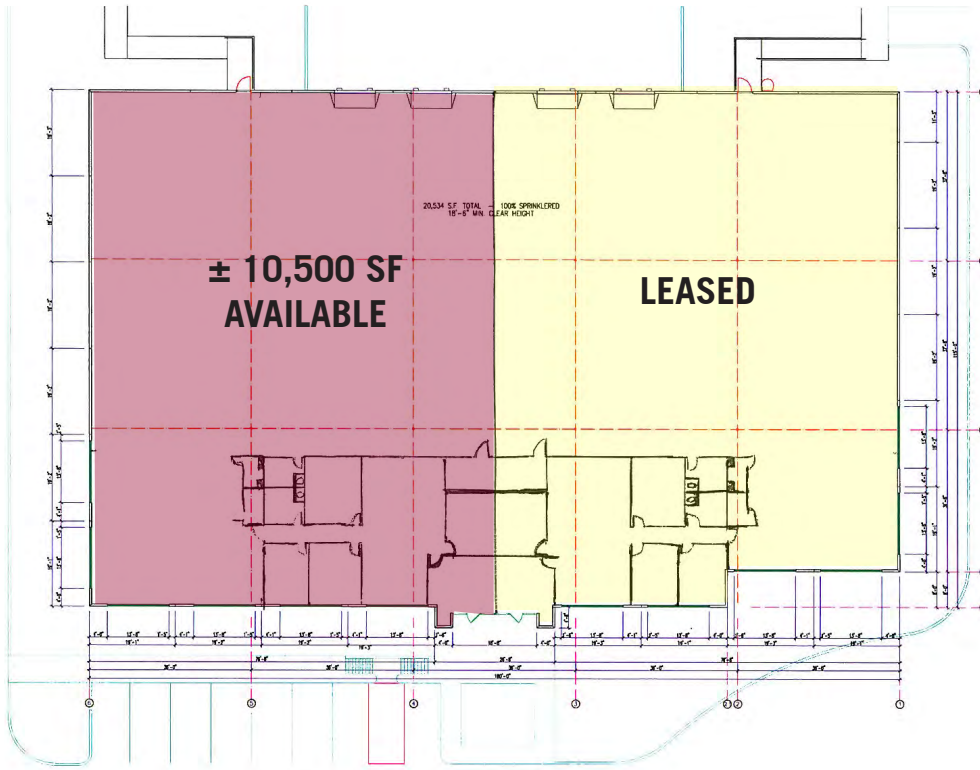

The property information/detail contained herein has been obtained from other sources believed to be reliable, and DFW Lee & Associates, LLC has not independently verified such information's accuracy. DFW Lee & Associates, LLC makes no representations, guarantees, or express or implied warranties of any kind regarding the accuracy or completeness of the information provided herein nor the condition of the property and expressly disclaims all such warranties, including but not limited to the implied warranty of suitability and fitness for a particular purpose. Buyer/Lessee should perform its own due diligence regarding the accuracy of the information upon which buyer/lessee relies when entering into any transaction with seller/lessor herein. Furthermore, the information provided herein, including any sale/lease terms, are being provided subject to errors, omissions, changes of price or conditions, prior sale or lease, and withdrawal without notice.

For more information contact:



**George Tanghongs, Principal**  
georget@lee-associates.com  
D 972.934.4008

**Brett Lewis, Principal**  
blewis@lee-associates.com  
D 972.934.4018

lee-associates.com

