

±30,455 SF WAREHOUSE SPACE

1021 CADILLAC COURT - MILPITAS, CA 95035



PSBUSINESSPARKS.



OVERVIEW

This ±30,455 SF warehouse space in Milpitas offers excellent access to I-880, I-680, Highway 237, and the San Jose International Airport. This ideal warehouse provides abundant dock level loading on two sides, ±10% of office space, and potential freeway signage on I-880.

FEATURES

- ±10% Office, Balance Warehouse
- 2 Private Offices
- 1 Conference Room
- 13 Dock High Doors
- 2 Grade Level Doors
- ±22'-24' Clear Height
- ±200 Amps @ 480 Volts
- Potential Freeway Signage

GET IN TOUCH

Kevin Lazzini
Leasing Director
T 408.453.9921
F 408.453.8238
klazzini@psbusinessparks.com

Janet Yin
Associate Leasing Director
T 408.453.9921
F 408.453.8238
jyin@psbusinessparks.com

LOCATION

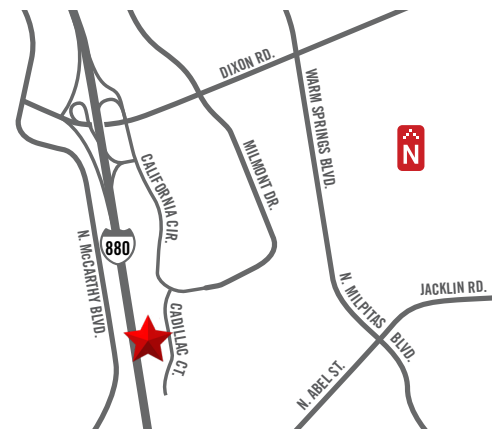

psbusinessparks.com
| industrial | flex | office |

±30,455 SF INDUSTRIAL SPACE

1021 CADILLAC COURT - MILPITAS, CA 95035



PSBUSINESSPARKS.

FLOOR PLAN

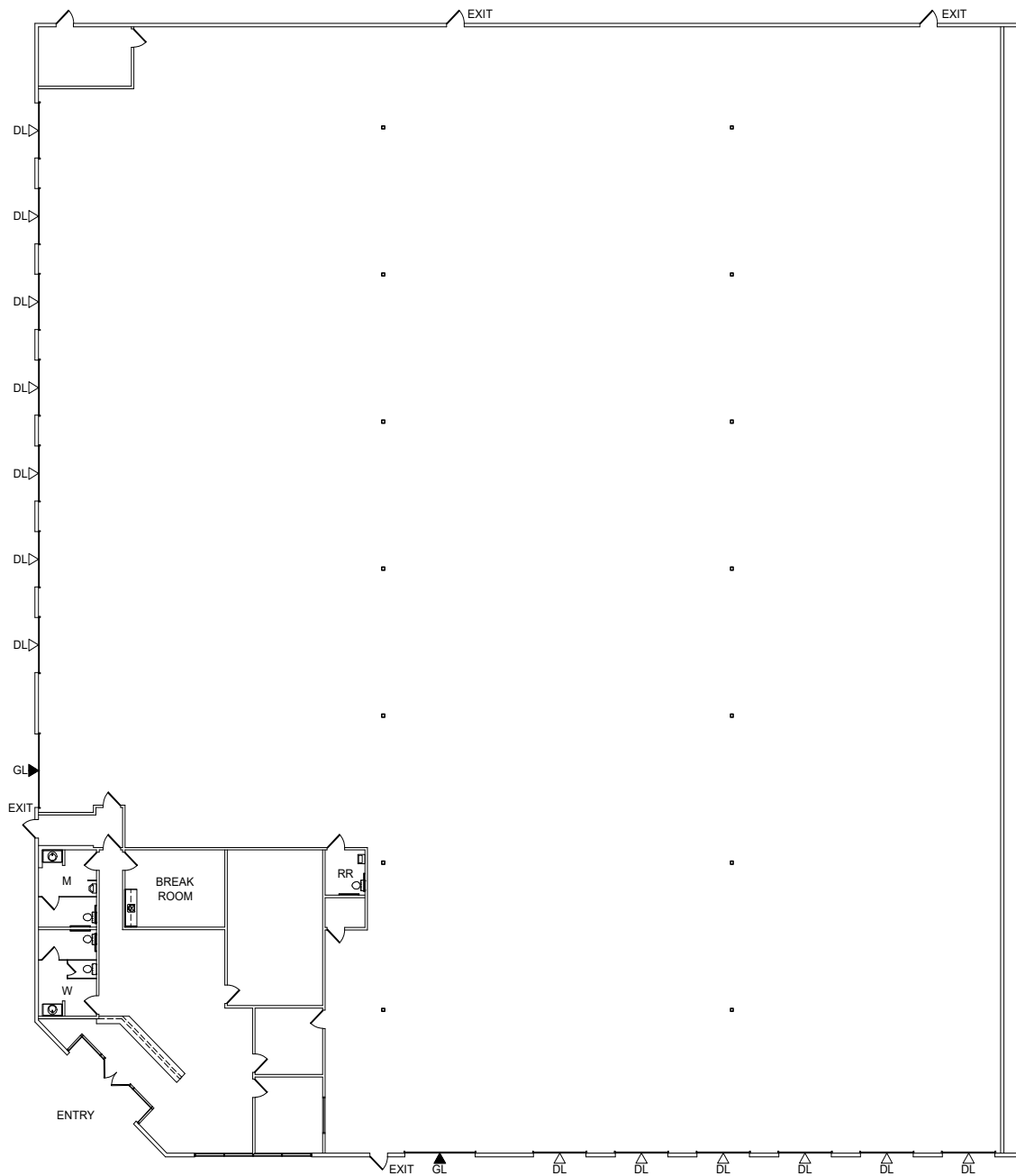

GET IN TOUCH

Kevin Lazzini
Leasing Director
T 408.453.9921
F 408.453.8238
klazzini@psbusinessparks.com

Janet Yin
Associate Leasing Director
T 408.453.9921
F 408.453.8238
jyin@psbusinessparks.com

psbusinessparks.com
| industrial | flex | office |