

1607 Mountain Industrial Boulevard

Stone Mountain, GA 30083 | Stone Mountain Industrial Park

ON THE WEB AT
STONEMOUNTAININDUSTRIAL.COM



INDUSTRIAL WAREHOUSE SPACE FOR LEASE

SPACE AVAILABLE 60,000 SF
LEASE RATE Call for details

HIGHLIGHTS

- 16' ceiling height
- T-5 Lighting
- 6 DHD
- 2 DID
- 3 miles from I-285
- Within Community Improvement District
- 100% Freeport Tax Exemption

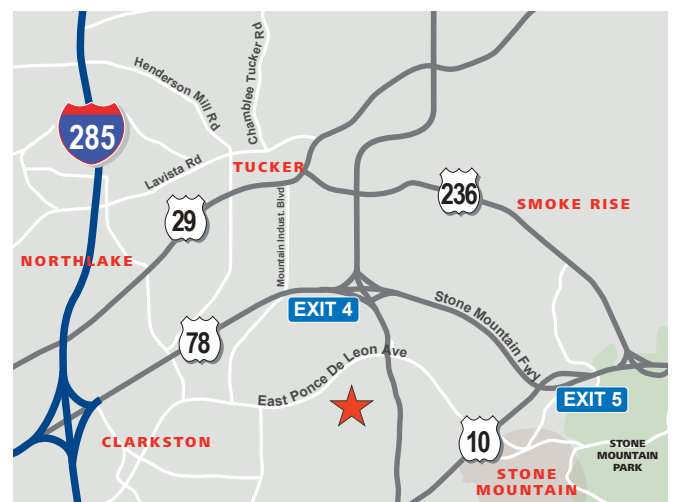

BRETT BUCKNER, CCIM, SIOR
770.913.3923 | 770.827.0041
bbuckner@ackermanco.net

JIMMY STEVENS
770.913.3983
jstevens@ackermanco.net

MAJOR MARTIN
404.906.4155
mmartin@ackermanco.net

Ackerman & Co.

www.stonemountainindustrial.com

©2018 Ackerman & Co. All rights reserved. While we have no reason to doubt the accuracy of the information provided from sources we deem reliable, we cannot guarantee it and therefore assume no liability for errors, omissions or changes to this content.

1607 Mountain Industrial Boulevard

Space Available For Lease: 60,000 SF

Stone Mountain, GA 30083
Stone Mountain Industrial Park

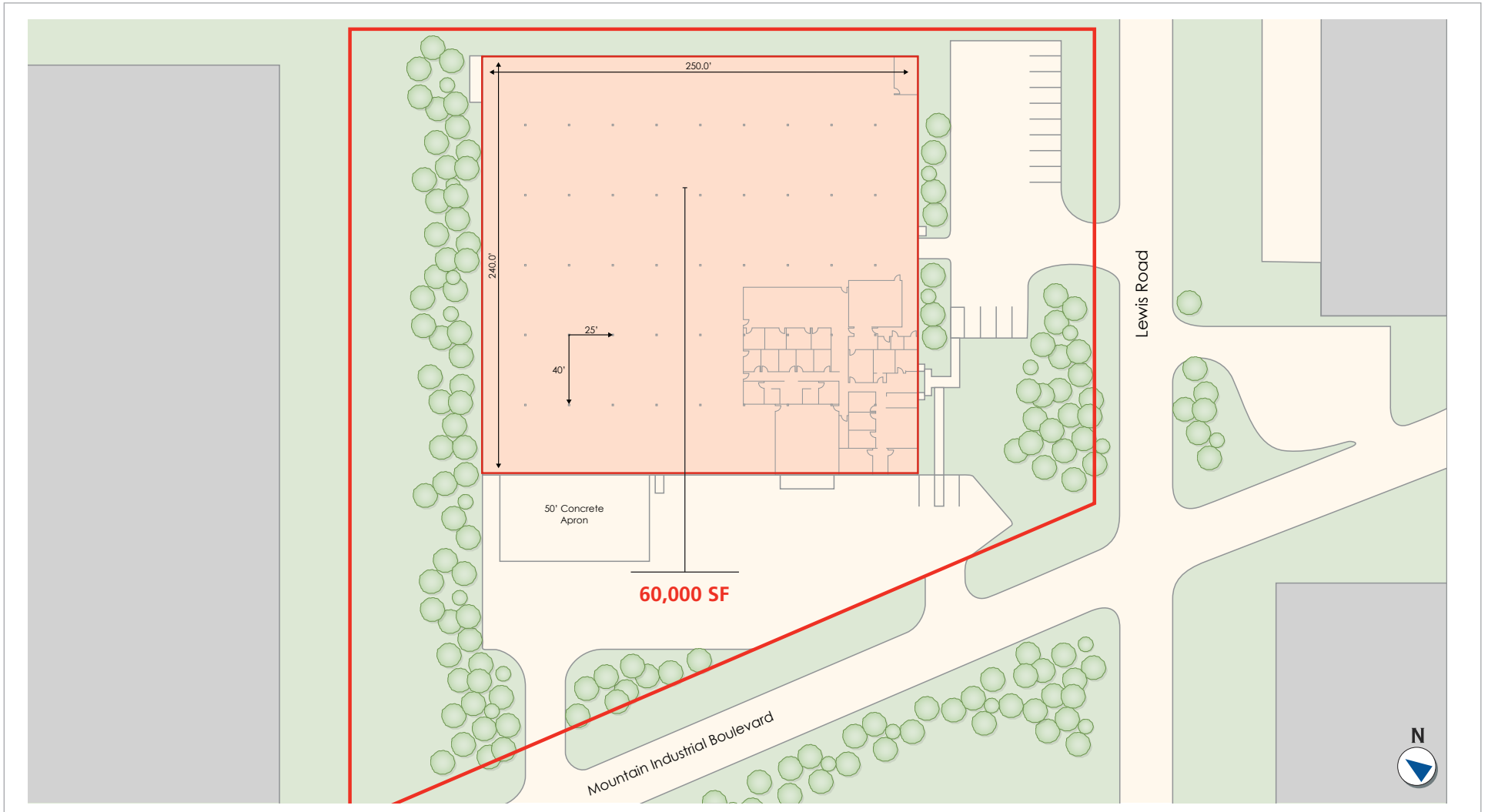

BRETT BUCKNER, CCIM, SIOR
770.913.3923 | 770.827.0041
bbuckner@ackermanco.net

JIMMY STEVENS
770.913.3983
jstevens@ackermanco.net

MAJOR MARTIN
404.906.4155
mmartin@ackermanco.net

Ackerman & Co.

1607 Mountain Industrial Boulevard

Space Available For Lease: 60,000 SF

Stone Mountain, GA 30083
Stone Mountain Industrial Park

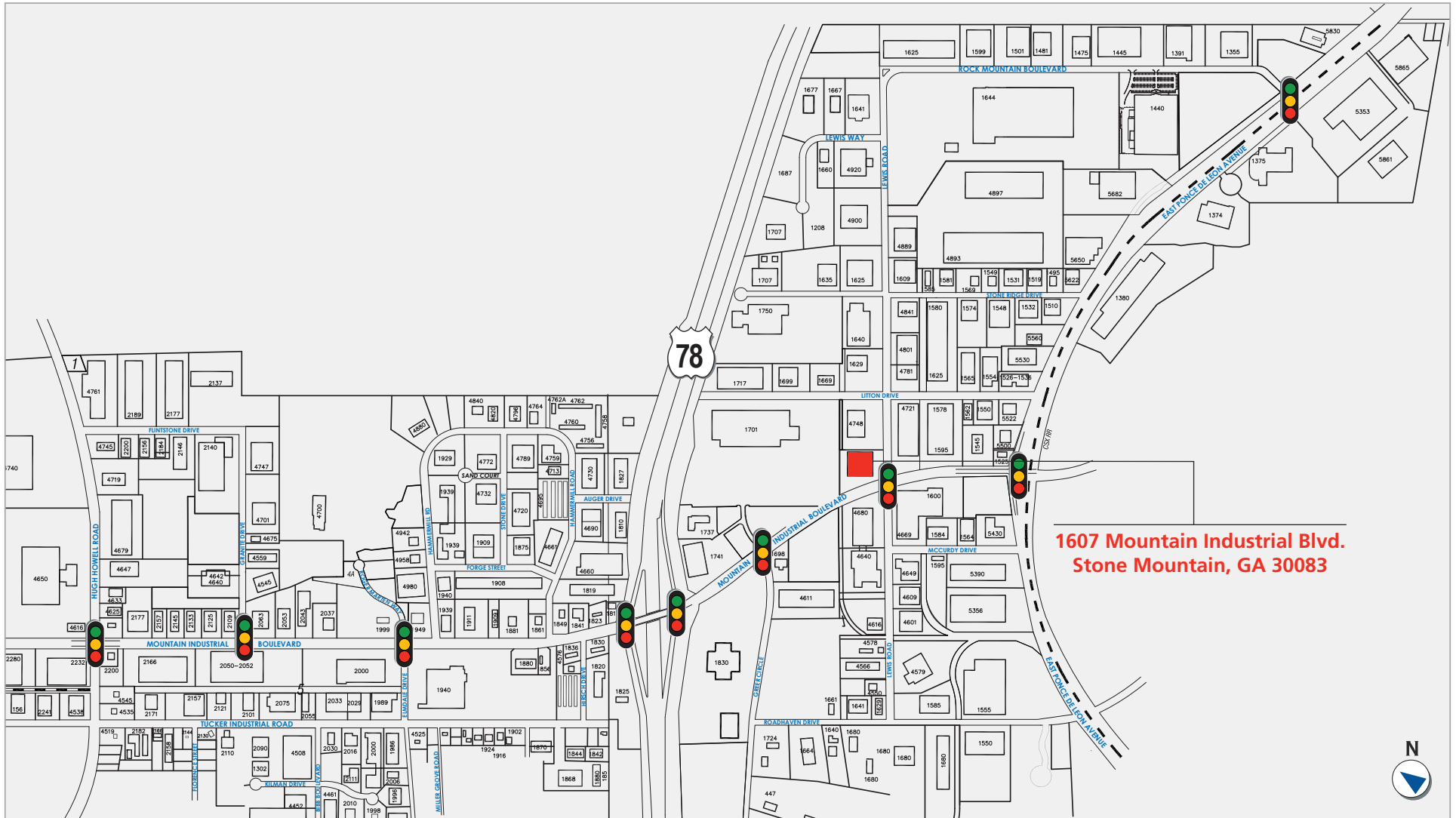

1607 Mountain Industrial Blvd.
Stone Mountain, GA 30083

BRETT BUCKNER, CCIM, SIOR
770.913.3923 | 770.827.0041
bbuckner@ackermanco.net

JIMMY STEVENS
770.913.3983
jstevens@ackermanco.net

MAJOR MARTIN
404.906.4155
mmartin@ackermanco.net

Ackerman & Co.

www.stonemountainindustrial.com

©2018 Ackerman & Co. All rights reserved. While we have no reason to doubt the accuracy of the information provided from sources we deem reliable, we cannot guarantee it and therefore assume no liability for errors, omissions or changes to this content.