

# BLACK CANYON

COMMERCE PARK

2101 W PEORIA AVE | PHOENIX, AZ



**CBRE**

±41,182 SF CONTIGUOUS AVAILABLE

# LOCATION FEATURES



EASY ACCESS TO I-17  
via full-diamond interchange at Peoria Avenue



ADJACENT TO THREE  
Valley Metro stops



PROXIMITY TO ABUNDANT  
labor market

# NEARBY AMENITIES



OVER 3 MILLION SF  
of retail amenities within  
a 3-mile radius

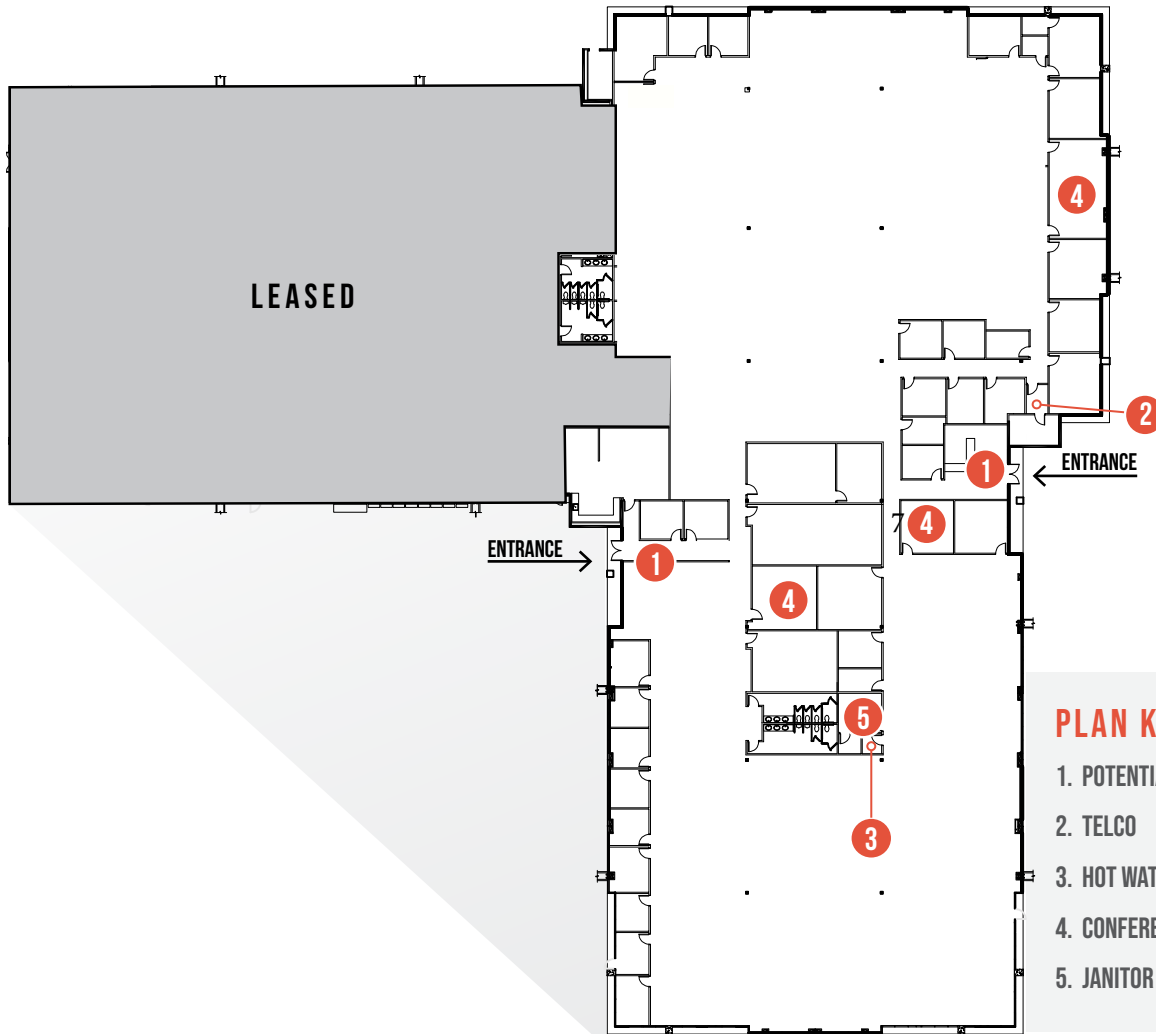

# BUILDING FEATURES

- Single story, exterior loaded office building
- ±41,182 SF available
- Wide open, call center layout
- 6.2 per 1,000 parking available

## PLAN KEY

1. POTENTIAL LOBBY
2. TELCO
3. HOT WATER
4. CONFERENCE ROOM
5. JANITOR

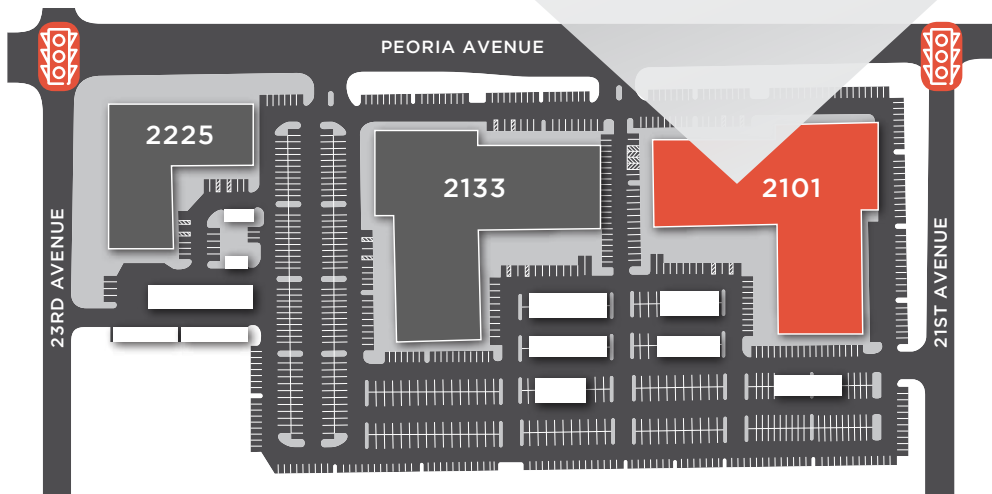



## FOR MORE INFORMATION PLEASE CONTACT

ASHLEY BROOKS  
Senior Vice President  
602.735.1758  
ashley.brooks@cbre.com

JASMINA SUBASIC  
Client Services Specialist  
602.735.5262  
jasmina.subasic@cbre.com



© 2018 CBRE, Inc. All rights reserved. This information has been obtained from sources believed reliable, but has not been verified for accuracy or completeness. You should conduct a careful, independent investigation of the property and verify all information. Any reliance on this information is solely at your own risk. CBRE and the CBRE logo are service marks of CBRE, Inc. All other marks displayed on this document are the property of their respective owners. Photos herein are the property of their respective owners. Use of these images without the express written consent of the owner is prohibited. PMStudio\_June2018