

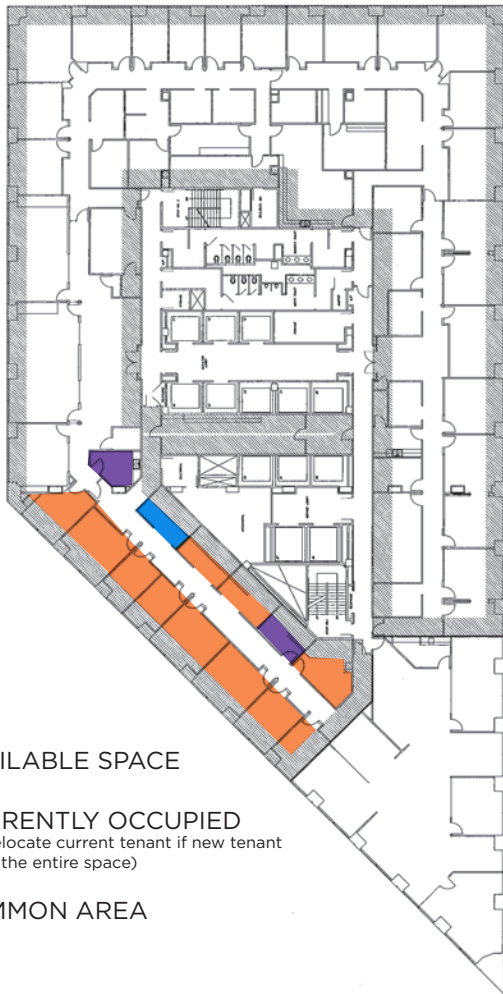



WELLS FARGO CENTER

333 S. GRAND AVE, LOS ANGELES - 42ND FLOOR



-  AVAILABLE SPACE
-  CURRENTLY OCCUPIED
(will relocate current tenant if new tenant leases the entire space)
-  COMMON AREA



PROPERTY FEATURES

42nd Floor

Term: Negotiable (thru May 2023)

Rate: Negotiable

- 1-8 Perimeter Offices
- 1 Interior Office / Conf. Room
- 3 Secretarial Bays
- Furniture Included

Shared Services Include:

- Kitchen
- Copy Rooms
- Reception

ERIC DUNCANSON

Executive Vice President
+1 213 629 6522
CA Lic # 00999249
Eric.Duncanson@cushwake.com

MARK MOORE

Sr. Brokerage Coordinator
+1 310 595 2208
CA Lic # 01962883
Mark.Moore@cushwake.com

900 Wilshire Blvd, Suite 2400
Los Angeles, CA 90067

cushmanwakefield.com

WELLS FARGO CENTER

333 S. GRAND AVE, LOS ANGELES - 42ND FLOOR



ERIC DUNCANSON

Executive Vice President
+1 213 629 6522
CA Lic # 00999249
Eric.Duncanson@cushwake.com

MARK MOORE

Sr. Brokerage Coordinator
+1 310 595 2208
CA Lic # 01962883
Mark.Moore@cushwake.com

900 Wilshire Blvd, Suite 2400
Los Angeles, CA 90067

cushmanwakefield.com