

LANDING CENTER

AT VAN DOREN'S LANDING | KENT, WA

FOR LEASE

11,896 SF (4,538 SF Office)
12,227 SF (3,949 SF Office)



22627 68TH AVE S | BLDG D

22404 66TH AVE S | BLDG B

BRIAN BRUININKS, CCIM

(206) 856-6249

bbruininks@andoverco.com

SHANE MAHVI

(858) 442-0441

smahvi@andoverco.com



VACANCIES

ALL SPACES AVAILABLE NOW

BUILDING	SF AVAILABLE WAREHOUSE OFFICE	DATE AVAILABLE	LOADING CEILING HEIGHT	ASKING RATE (+ NNN'S)	ADDITIONAL INFO
D	11,896 SF ± 4,538 SF Office/Showroom	Now	1 DH + 1 GL 18' CH	Call brokers for rates.	Newly delivered space. Good end cap space with excellent West Valley Hwy frontage. Please call brokers for rates.
B	12,227 SF 3,949 SF office	Now	2 DH + 1 GL 18' - 22' CH	Call brokers for rates.	Good end cap space with mix of private offices, open work space. Warehouse space has been historically used for assembly/ manufacturing and printing operations. Warehouse area is climate controlled. Potential to remove some office space. Please call brokers for rates.

11,896 SF (± 4,538 SF OFFICE)

22627 68TH AVE S | KENT, WA

BUILDING D

Size: **11,896 SF TOTAL**

Office: **± 4,538 SF**

Docks: **1**

Grade Level Doors: **1**

Clear Height: **18'**

Available: **Now**

Comments: **Newly delivered space. Good end cap space with excellent West Valley Hwy. Please call brokers for rates.**



The information contained herein has been obtained from reliable sources, but is not guaranteed. A prospective buyer/tenant should verify each item relating to this property and all information contained herein.

12,227 SF (3,949 SF OFFICE)

22404 66TH AVE S | KENT, WA

Size: 12,227 SF TOTAL

Office: 3,949 SF

Docks: 2

Grade Level Doors: 1 (Oversized 14' X 14')

Clear Height: 18' - 22'

Type: Insulated warehouse area

Power: 227/480v, 3-Phase Power

Available: Now

Available: **Good end cap space with mix of private offices, open work space and good parking. Warehouse space has been historically used for assembly/manufacturing and printing operations. Warehouse area is climate controlled. Potential to remove some office space. Please call broker for rates, touring the space.**

BUILDING B

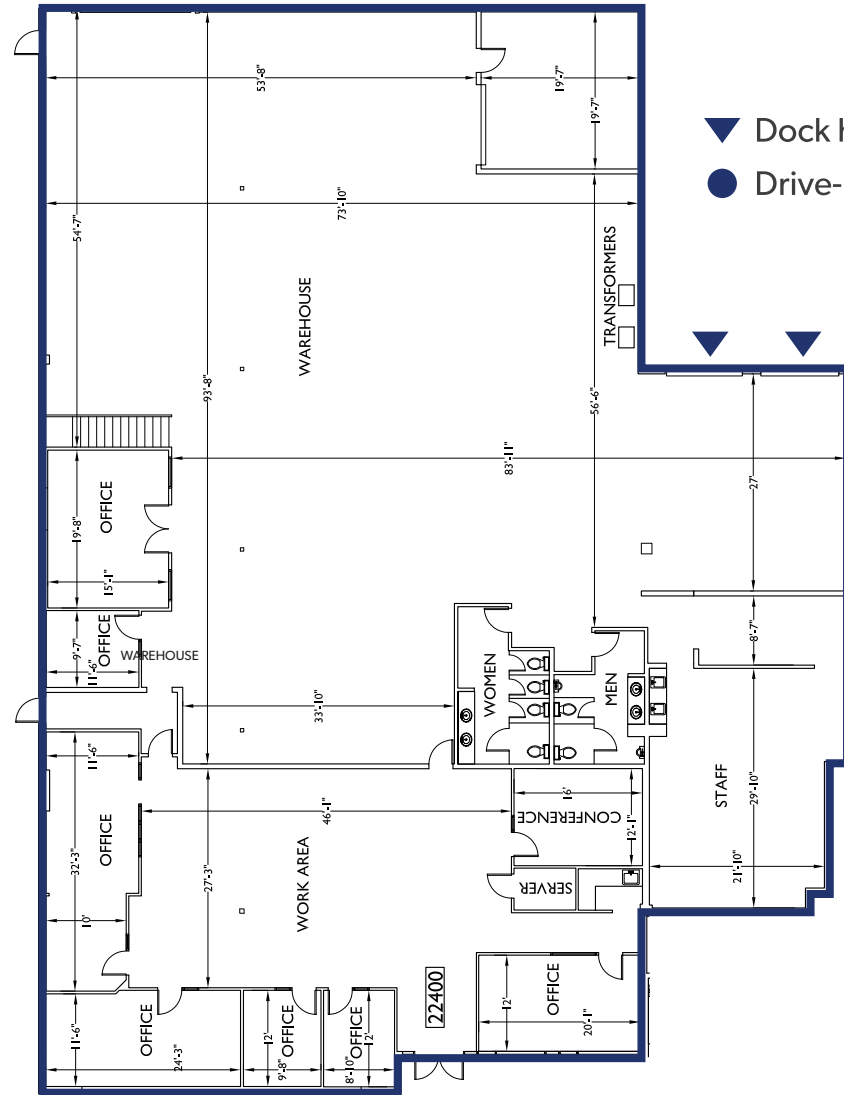

- ▼ Dock high door
- Drive-in door

LOCATION MAP

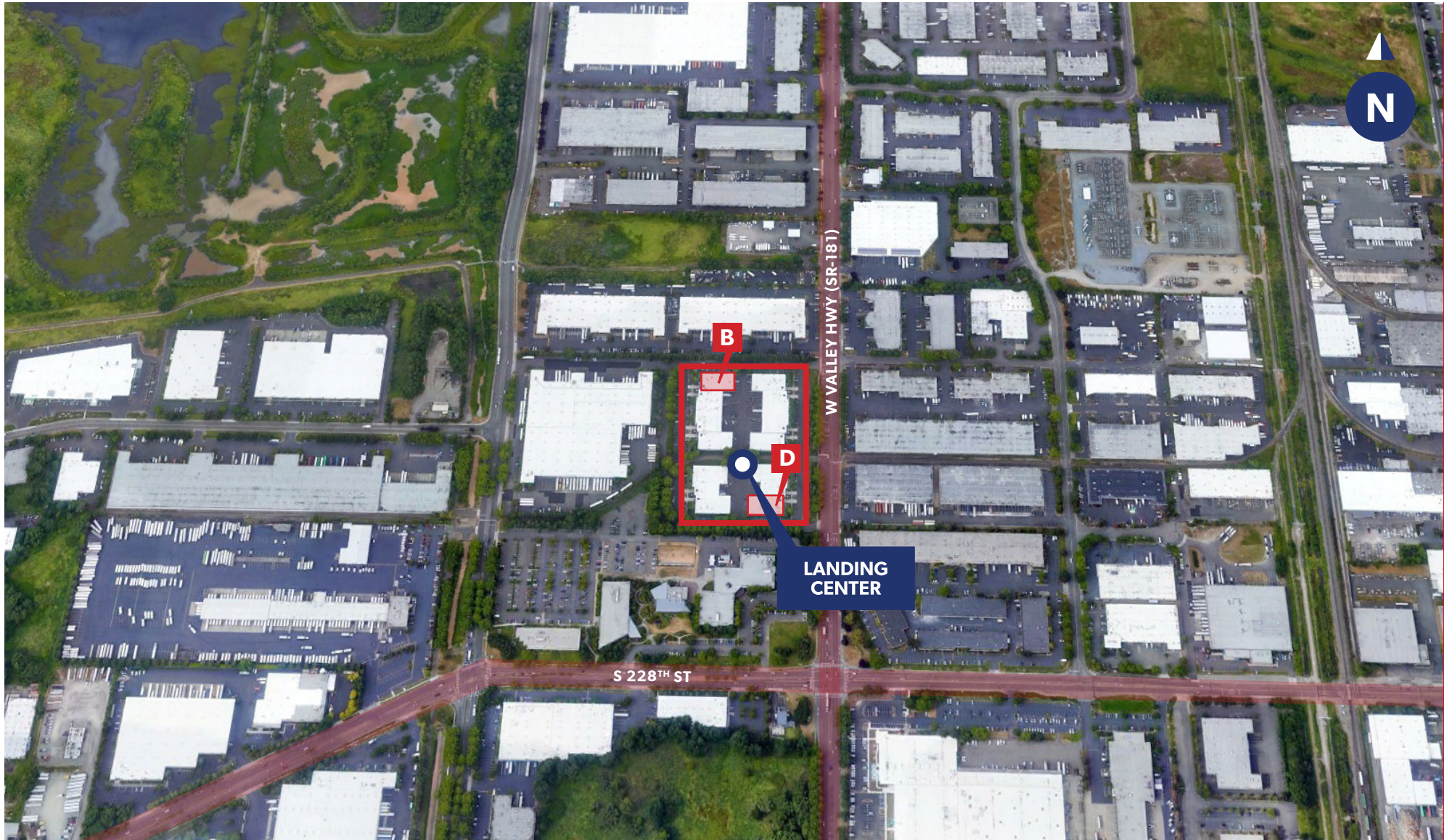

BRIAN BRUININKS, CCIM
(206) 856-6249
bbruininks@andoverco.com

SHANE MAHVI
(858) 442-0441
smahvi@andoverco.com

 **THE ANDOVER
COMPANY, INC.**
CORFAC INTERNATIONAL