



677 Sq. Ft

Call for Retail Information

Prime Site in One of Fairfield County's Premier Retail Central Business Districts

- Rated 18th Wealthiest Town in America
- Ideal Location with Incredible Visibility and Access to Free Parking
- Next to Exciting Bedford Square Development
- Neighboring Retailers Include:



patagonia **TIFFANY & CO.**  **PELOTON** **west elm**
lululemon  **athletica**  **URBAN OUTFITTERS**
Madewell **theory** **WILLIAMS-SONOMA** **J.CREW**
 **ANTHROPOLOGIE**

By Drivetime	Town of Westport	15-Min
Average HH Income	\$239,166	\$162,695
Median HH Income	\$169,731	\$103,012
Population	27,768	140,226
Total Households	9,935	52,206
Retail Potential	\$1.6 Billion	\$3.89 Billion

 **vineyard vines**
INTERMIX

Call Owner's Exclusive Agents:

Haryn Intner [914-779-8200](tel:914-779-8200) x123 haryn@admiralrealestate.com
 Jon Gordon [914-779-8200](tel:914-779-8200) x115 jgordon@admiralrealestate.com

Brokers Protected

Floor Plan

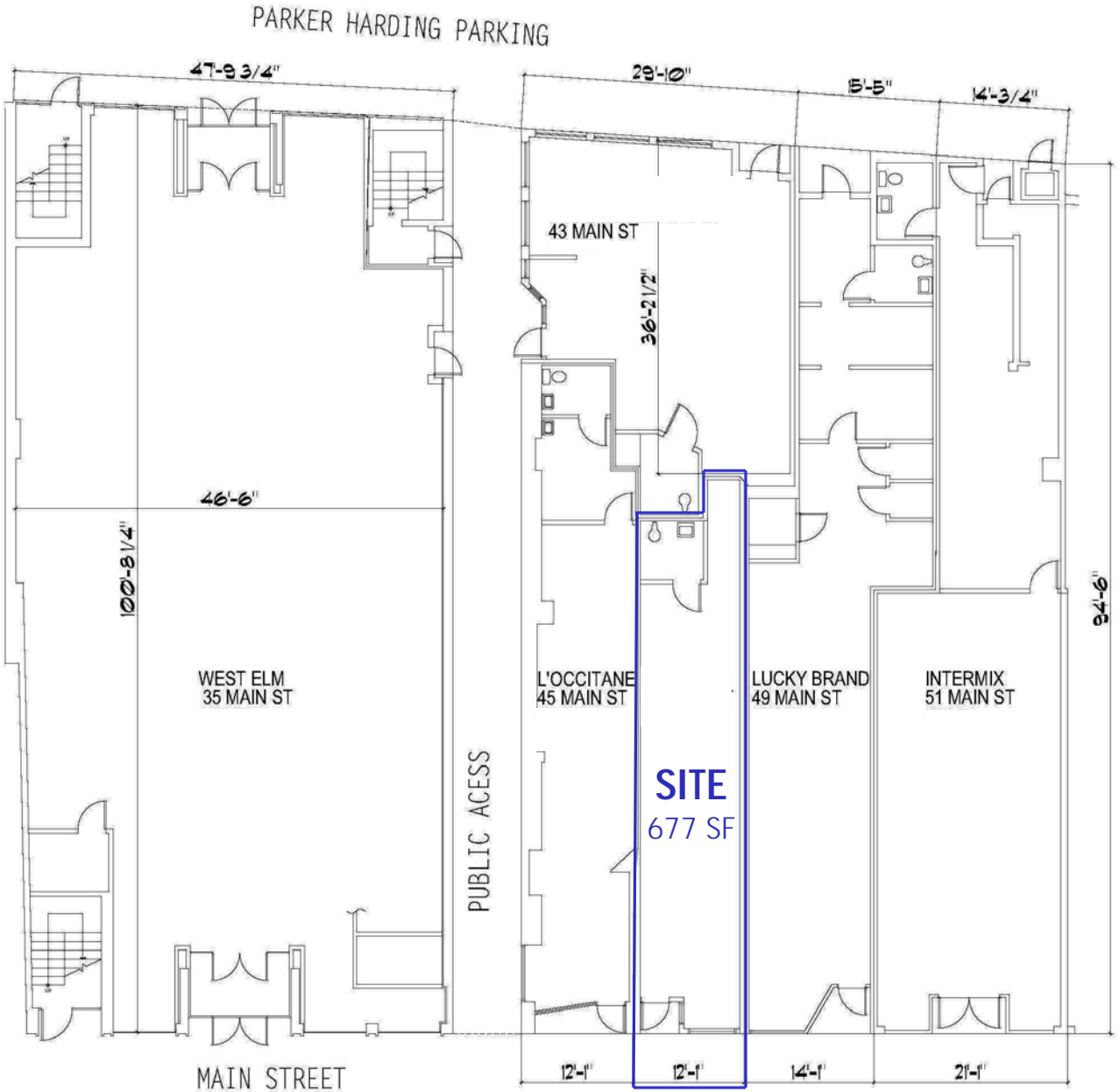

**Call Owner's
Exclusive Agents:**

Haryn Intner [914-779-8200](tel:914-779-8200) x123 haryn@admiralrealestate.com
Jon Gordon [914-779-8200](tel:914-779-8200) x115 jgordon@admiralrealestate.com

Brokers
Protected



ADMIRAL

REAL ESTATE SERVICES

Ample downtown parking available: Approx. 2,500 spaces

- Free municipal parking lot

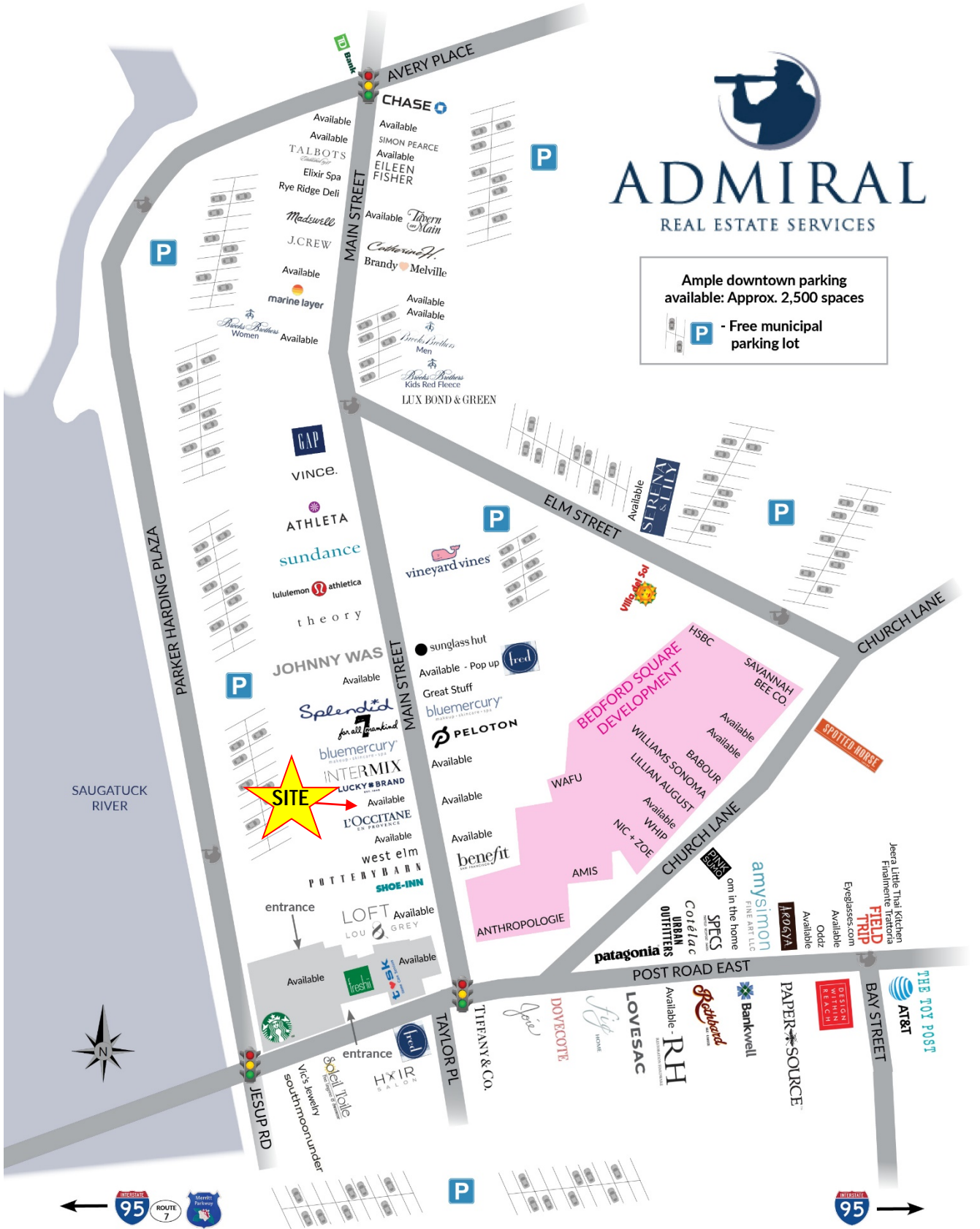

Call Owner's
Exclusive Agents:

Haryn Intner 914-779-8200 x123 haryn@admiralrealestate.com
Jon Gordon 914-779-8200 x115 jgordon@admiralrealestate.com

Brokers
Protected