

PHASE I
A1.1

A NEW BUILDING FOR
LACEY BUSINESS PARK BUILDING 1
WILLAMETTE DR. AND ORION DR. NE
LACEY, WASHINGTON

david kehe architects
2720 GATEWAY DRIVE SUITE 100
SEATTLE, WASHINGTON 98108
PHONE (206) 433-8967
FAX (206) 248-5569

REV	DATE	DESCRIPTION	PROJECT	ISSUED BY
1	11/11/03	ISSUE FOR PERMIT		MEI
2	11/11/03	REV. ELECTRICAL		
3	11/11/03	REV. MECHANICAL		
4	11/11/03	CONSTRUCTION PERMIT		MEI/DAVID
5	11/11/03	CONSTRUCTION PERMIT		
6	11/11/03	REVISED PER CONSTRUCTOR		DAVID

LEGEND

EXISTING CONSTRUCTION
NEW CONSTRUCTION

NOTES:

1. ALL WORK SHALL BE IN ACCORDANCE WITH THE CITY OF SEATTLE'S BUILDING CODE AND THE WASHINGTON STATE BUILDING CODE.

2. THE ARCHITECT SHALL BE RESPONSIBLE FOR OBTAINING ALL NECESSARY PERMITS AND APPROVALS FROM THE CITY OF SEATTLE.

3. THE CONTRACTOR SHALL BE RESPONSIBLE FOR OBTAINING ALL NECESSARY PERMITS AND APPROVALS FROM THE CITY OF SEATTLE.

4. ALL WORK SHALL BE COMPLETED WITHIN THE SPECIFIED TIME FRAME.

5. THE CONTRACTOR SHALL MAINTAIN ACCESS TO ALL ADJACENT PROPERTIES AT ALL TIMES.

6. ALL MATERIALS AND WORKMANSHIP SHALL BE SUBJECT TO INSPECTION AND APPROVAL BY THE CITY OF SEATTLE.

7. THE ARCHITECT SHALL BE RESPONSIBLE FOR THE DESIGN AND CONSTRUCTION OF THE BUILDING.

8. THE CONTRACTOR SHALL BE RESPONSIBLE FOR THE CONSTRUCTION OF THE BUILDING.

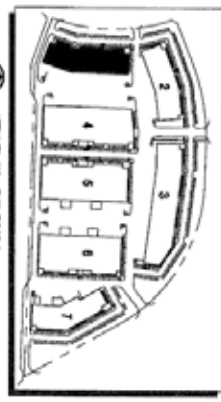

NOTES:

1. THE CONTRACTOR SHALL BE RESPONSIBLE FOR OBTAINING ALL NECESSARY PERMITS AND APPROVALS FROM THE CITY OF SEATTLE.

2. THE CONTRACTOR SHALL MAINTAIN ACCESS TO ALL ADJACENT PROPERTIES AT ALL TIMES.

3. ALL MATERIALS AND WORKMANSHIP SHALL BE SUBJECT TO INSPECTION AND APPROVAL BY THE CITY OF SEATTLE.

4. THE ARCHITECT SHALL BE RESPONSIBLE FOR THE DESIGN AND CONSTRUCTION OF THE BUILDING.

5. THE CONTRACTOR SHALL BE RESPONSIBLE FOR THE CONSTRUCTION OF THE BUILDING.