

96,000 SF

Industrial Space For Lease



Northwest Corporate Park - Kent

20024 85th Avenue S
Kent, WA

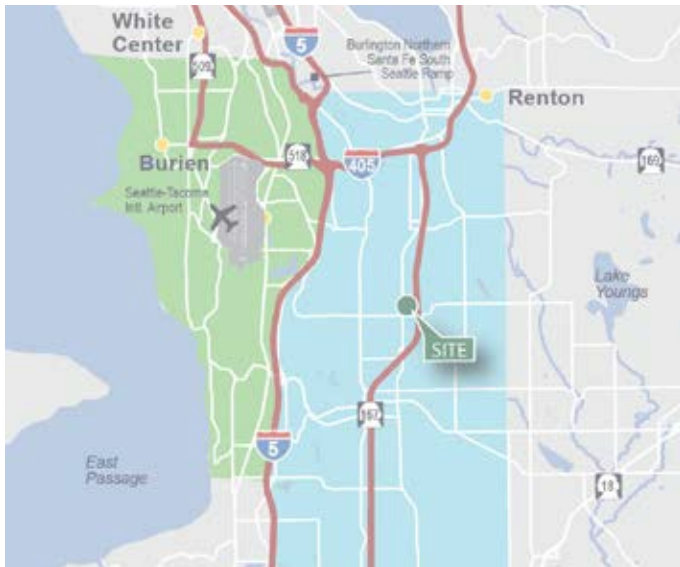

LOCATION

- 50 yard line location
- Great access to Hwy-167, I-5 and I-405

FACILITY

- 96,000 SF shell
- 4,229 SF office
- 22 DH doors and 3 GL doors
- 24' clear height
- 60' x 25' typical column spacing (200' deep)
- End cap space
- Available now

96,000 SF

Industrial Space For Lease

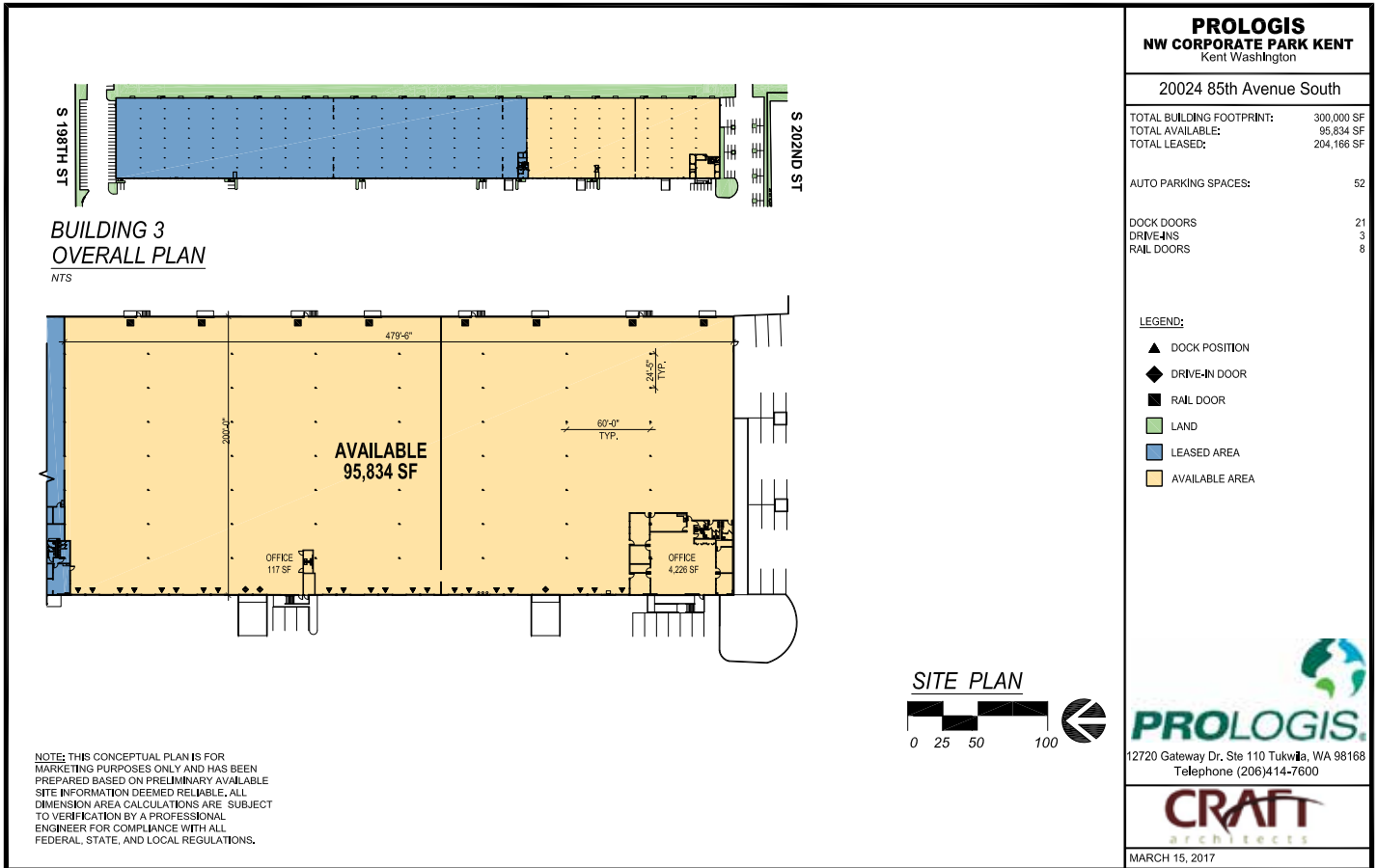

Kidder Mathews
Matt Wood, SIOR
mwood@kiddermathews.com
ph 206 248 7306
fax 206 248 7342
12886 Interurban Ave S
Seattle, WA 98168

Kidder Mathews
Thad Mallory, SIOR
tmallory@kiddermathews.com
ph 206 248 7338
fax 206 248 7342
12886 Interurban Ave S
Seattle, WA 98168

Kidder Mathews
Tony Miltenberger, SIOR
tonym@kiddermathews.com
ph 206 248 7307
fax 206 248 7342
12886 Interurban Ave S
Seattle, WA 98168

Prologis
Rick Kolpa
rkolpa@prologis.com
ph 206 414 7610
fax 206 414 7601
12720 Gateway Dr, Ste 110
Tukwila, WA 98168

96,000 SF

Industrial Space For Lease



Kidder Mathews

Matt Wood, SIOR
mwood@kiddermathews.com
ph 206 248 7306
fax 206 248 7342
12886 Interurban Ave S
Seattle, WA 98168

Kidder Mathews

Thad Mallory, SIOR
tmallory@kiddermathews.com
ph 206 248 7338
fax 206 248 7342
12886 Interurban Ave S
Seattle, WA 98168

Kidder Mathews

Tony Miltenberger, SIOR
tonym@kiddermathews.com
ph 206 248 7307
fax 206 248 7342
12886 Interurban Ave S
Seattle, WA 98168

Prologis

Rick Kolpa
rkolpa@prologis.com
ph 206 414 7610
fax 206 414 7601
12720 Gateway Dr, Ste 110
Tukwila, WA 98168