



**2931 EL CAMINO REAL  
SANTA CLARA,  
CALIFORNIA**

**8,900± SF FOR LEASE  
ON EL CAMINO REAL NEAR KIELY**



**PROPERTY HIGHLIGHTS:**

- 8,900± SF Retail Building
- Building Recently Remodeled
- Former Summerwinds Nursery Site
- Staging/Parking/Outdoor Areas
- Lots of Parking
- Very Busy Section of El Camino Real
- Many Uses Allowed: Schools, Automotive Sales, Furniture, Flooring Showroom, Other Retail

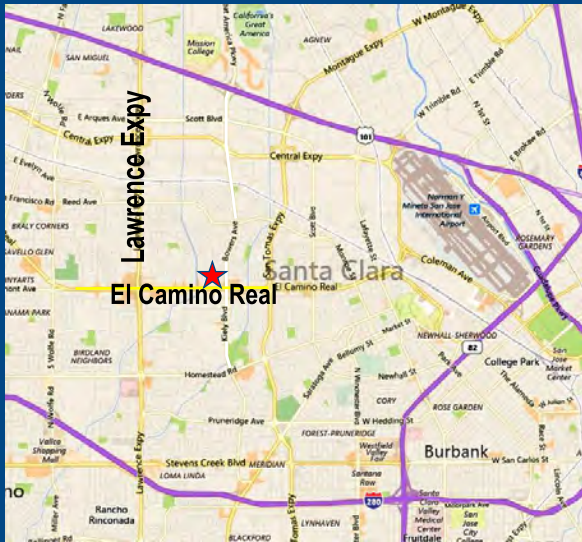

**ESTIMATED DEMOGRAPHICS:**

	<u>1 MILE</u>	<u>3 MILE</u>	<u>5 MILES</u>
POPULATION:	31,028	211,638	560,347
AVG. HH INCOME	\$112,872	\$116,865	\$122,780

**MEACHAM/OPPENHEIMER, INC.**  
**CORFAC INTERNATIONAL**  
8 No. San Pedro St., Suite 300  
San Jose, California 95110  
Tel: 408.378.5900  
Fax: 408.378.5903  
[www.moinc.net](http://www.moinc.net)

**David Taxin**  
Lic. #00983163  
[dtaxin@moinc.net](mailto:dtaxin@moinc.net)  
**(408) 477-2508**  
**(408) 378-5900**

# 2931 El Camino Real • Santa Clara, California



Interior

**MEACHAM/OPPENHEIMER, INC.**  
**CORFAC INTERNATIONAL**  
8 No. San Pedro St., Suite 300  
San Jose, California 95110  
Tel: 408.378.5900  
[www.moinc.net](http://www.moinc.net)

**David Taxin**  
Lic. #00983163  
[dtaxin@moinc.net](mailto:dtaxin@moinc.net)  
**(408) 477-2508**

# 2931 El Camino Real • Santa Clara, California

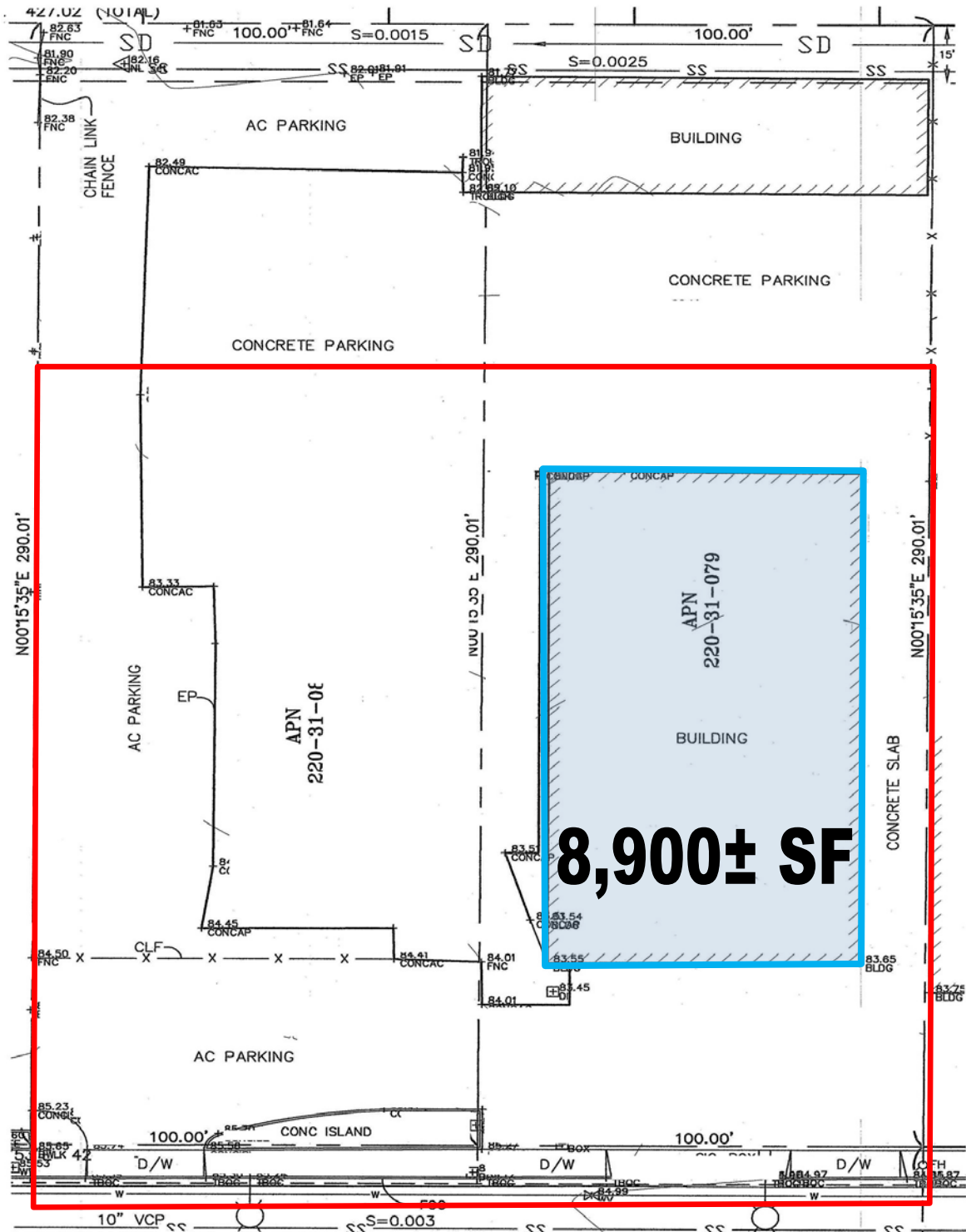

El Camino Real

MEACHAM/OPPENHEIMER, INC.  
 CORFAC INTERNATIONAL  
 8 No. San Pedro St., Suite 300  
 San Jose, California 95110  
 Tel: 408.378.5900  
 www.moinc.net

David Taxin  
 Lic. #00983163  
[dtaxin@moinc.net](mailto:dtaxin@moinc.net)  
 (408) 477-2508

# 2931 El Camino Real • Santa Clara, California

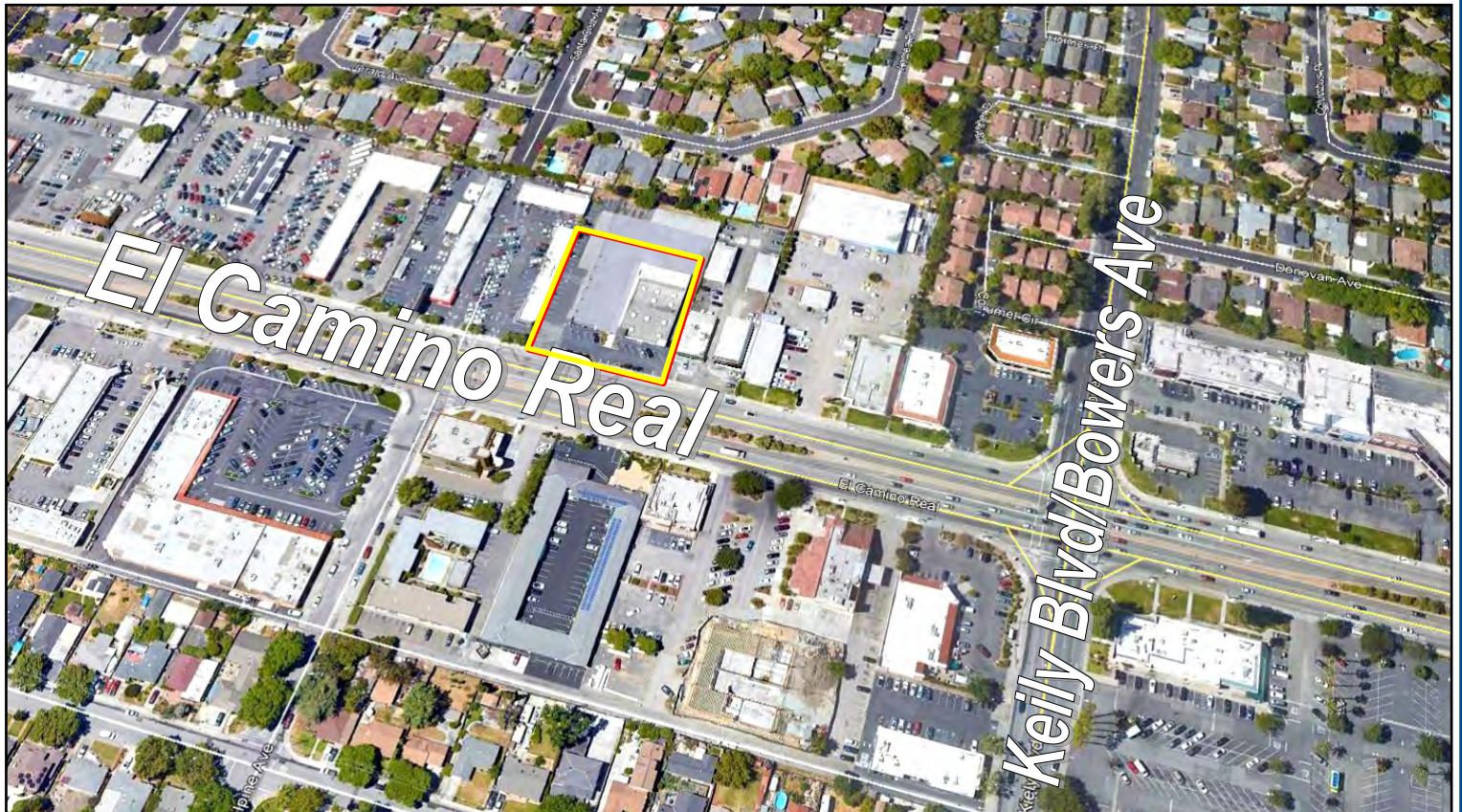

MEACHAM/OPPENHEIMER, INC.  
CORFAC INTERNATIONAL  
8 No. San Pedro St., Suite 300  
San Jose, California 95110  
Tel: 408.378.5900  
www.moinc.net

David Taxin  
Lic. #00983163  
[dtaxin@moinc.net](mailto:dtaxin@moinc.net)  
(408) 477-2508