

1390 BAYPORT AVE

SAN CARLOS, CA 94070

RARE ±5,800 SF
R&D / LAB SPACE

Ben Paul
Executive Managing Director
+1 650 401 2123
ben.paul@cushwake.com
LIC #01210872

James Marzoni
Senior Vice President
+1 650 787 0798
james@prprop.com
LIC #01248525

Charlie Moran
Associate
+1 650 288 8605
charlie.moran@cushwake.com
LIC #02102431

1350 Bayshore Hwy., Suite 900
Burlingame, CA
main +1 650 347 3700
fax +1 650 347 4307
cushmanwakefield.com

View Site Specific
COVID-19
PREVENTION PLAN



1390 BAYPORT AVE

SAN CARLOS, CA 94070

FLOOR PLAN

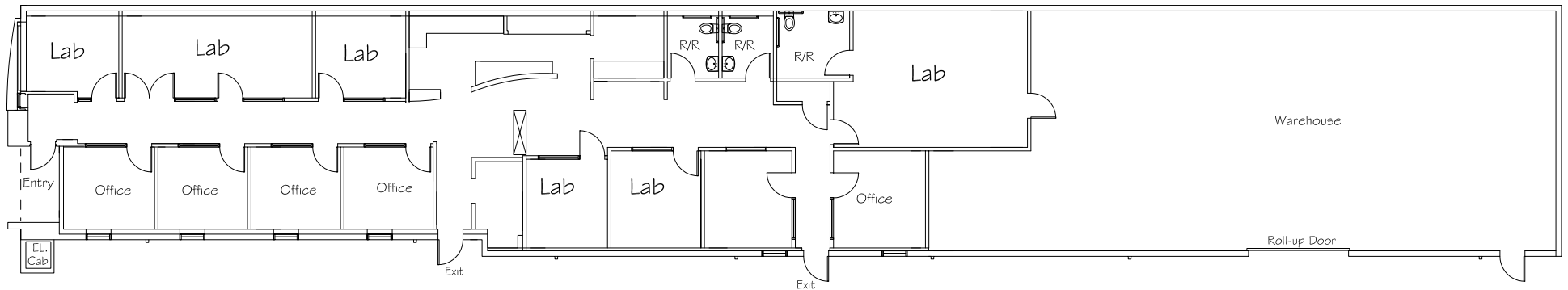

HIGHLIGHTS

- Rare Office / R&D / Lab Space
- 6 Lab Rooms
- 5 Private Offices
- Flexible Uses
- 3 Restrooms
- Warehouse
- Roll-up Door
- 11 Parking Spaces



1390 BAYPORT AVE

SAN CARLOS, CA 94070

HVAC ZONE MAP

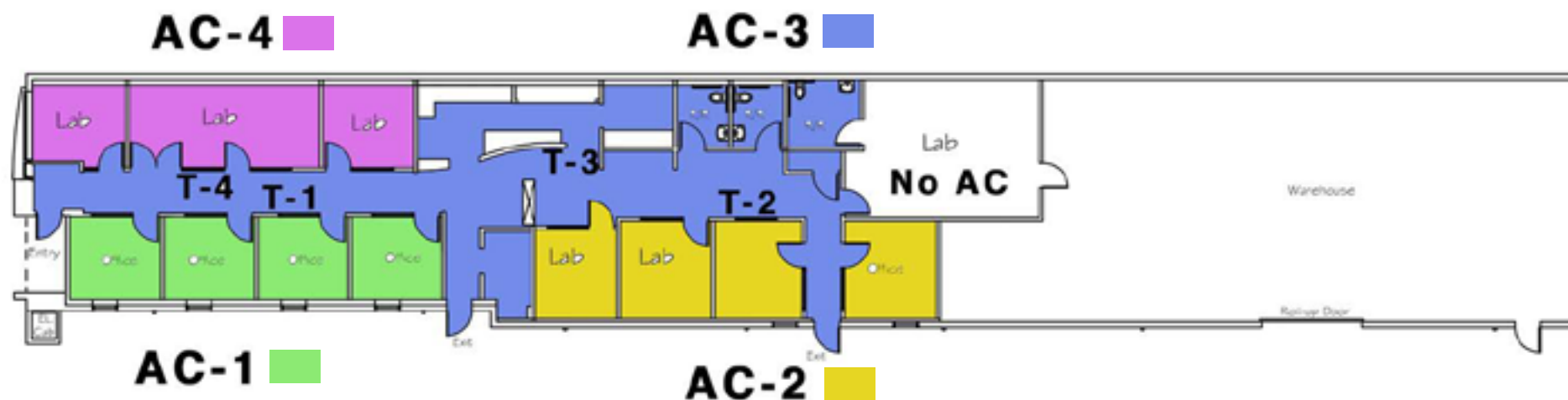

POWER INFORMATION

- **Electric Service:** 600 AMP, 3-phase 120-480Volt
- **Natural Gas Service:** 630 CFH
- **Water Service:** 1" City Water Service
- **Fire Sprinklers:** Full Building Coverage
- **HVAC:** See Above Zone Map
- **Warehouse Door Size:** 12' width, 9'-3" Clear Height
- **Warehouse Clear Height:** 10'-3" bottom of sprinkler pipe
- **Office & Lab Ceiling Height:** 9'-6" height
- Lighting & Electrical Service in Warehouse.
- Copper Pipe CDA distribution to Labs. Air Compressor not installed.
- **LAB Room Floors:** VCT
- All Labs are Dry, not plumbed for waste or water.



1390 BAYPORT AVE

SAN CARLOS, CA 94070

TOWN

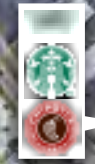

1390 BAYPORT AVE

- Close Proximity to Downtown San Carlos
- Half Mile to Caltrain
- Less Than 2 Miles to Highway 101

Ben Paul
Executive Managing Director
+1 650 401 2123
ben.paul@cushwake.com
LIC #01210872

James Marzoni
Senior Vice President
+1 650 787 0798
james@prprop.com
LIC #01248525

Charlie Moran
Associate
+1 650 288 8605
charlie.moran@cushwake.com
LIC #02102431

1350 Bayshore Hwy., Suite 900
Burlingame, CA
main +1 650 347 3700
fax +1 650 347 4307
cushmanwakefield.com

