

PRIME RETAIL SPACE ADJACENT TO KOHL'S

Lawrenceville, GA 30046 | 640 Collins Hill Road | Collins Hill Rd & Hurricane Shoals Rd | #452



AVAILABLE SF:
24,700 SF

FRONTAGE:
APPROX. 97'7"

ZONING:
COMMERCIAL

RATES:
CALL FOR DETAILS

- 24,700 SF junior anchor end cap available
- Adjacent to Walmart
- Signalized intersection access

DEMOGRAPHICS	1 MILE	3 MILES	5 MILES	TRAFFIC COUNTS	
2018 POPULATION	6,578	76,160	200,753	Buford Drive	30,600 AADT
2018 DAYTIME POPULATION	10,637	94,122	191,151	GA 316	73,800 AADT
2018 AVERAGE HH INCOME	49,457	76,062	86,816		
2018 MEDIAN HH INCOME	40,103	59,835	69,201		

AREA ANCHORS



FOR MORE INFORMATION, CONTACT EXCLUSIVE AGENT(S):
PATRICK BENTLEY • patrick.bentley@tscg.com • 770.955.2434



Demographics: Esri 2018 No warranty expressed or implied has been made as to the accuracy of the information provided herein, no liability assumed for error or omissions.

PRIME RETAIL SPACE ADJACENT TO KOHL'S

Lawrenceville, GA 30046 | 640 Collins Hill Road | Collins Hill Rd & Hurricane Shoals Rd | #452



FOR MORE INFORMATION, CONTACT EXCLUSIVE AGENT(S):
PATRICK BENTLEY • patrick.bentley@tscg.com • 770.955.2434



Demographics: Esri 2018 No warranty expressed or implied has been made as to the accuracy of the information provided herein, no liability assumed for error or omissions.

PRIME RETAIL SPACE ADJACENT TO KOHL'S

Lawrenceville, GA 30046 | 640 Collins Hill Road | Collins Hill Rd & Hurricane Shoals Rd | #452

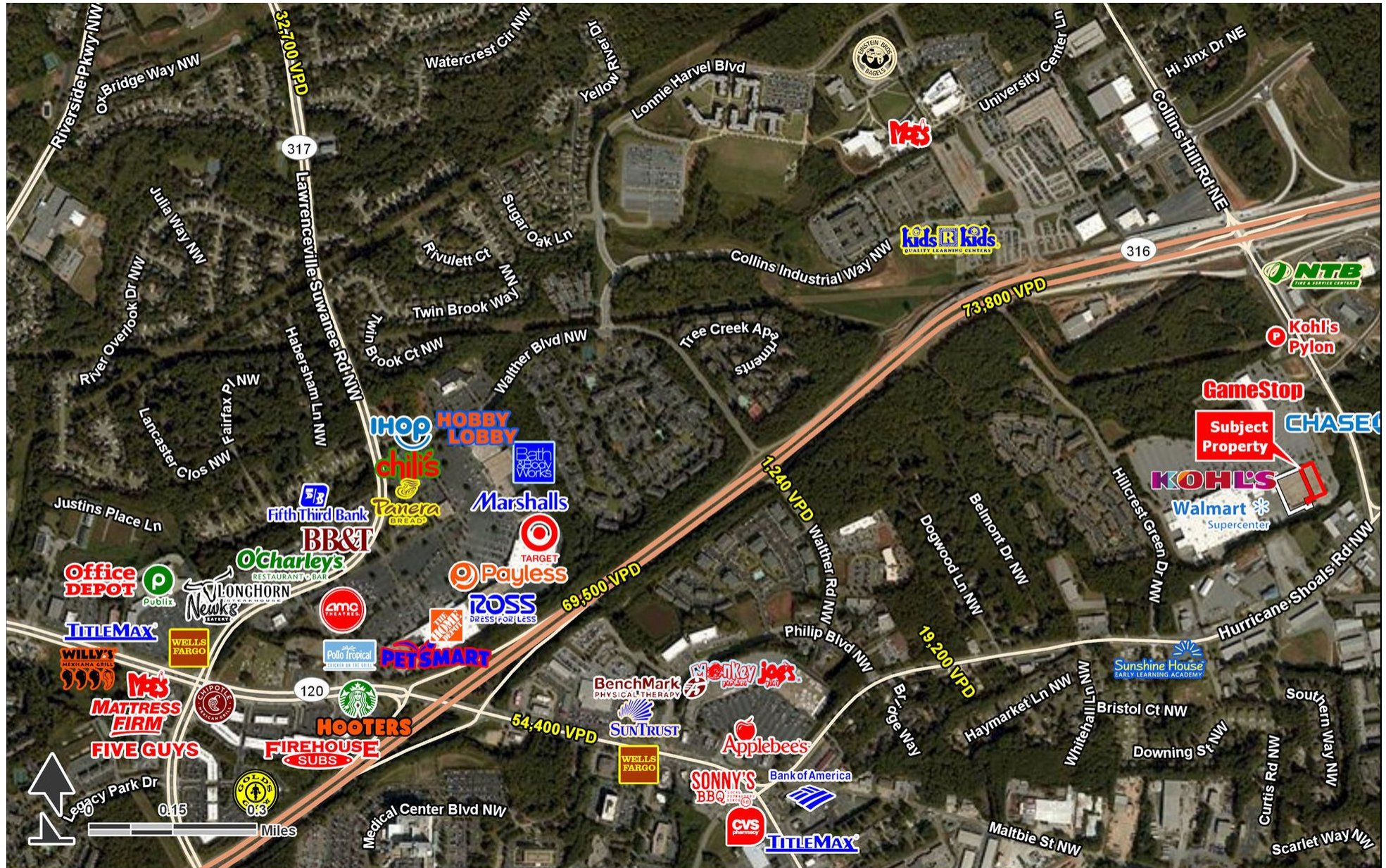

FOR MORE INFORMATION, CONTACT EXCLUSIVE AGENT(S):
 PATRICK BENTLEY • patrick.bentley@tscg.com • 770.955.2434



Demographics: Esri 2018 No warranty expressed or implied has been made as to the accuracy of the information provided herein, no liability assumed for error or omissions.

PRIME RETAIL SPACE ADJACENT TO KOHL'S

Lawrenceville, GA 30046 | 640 Collins Hill Road | Collins Hill Rd & Hurricane Shoals Rd | #452

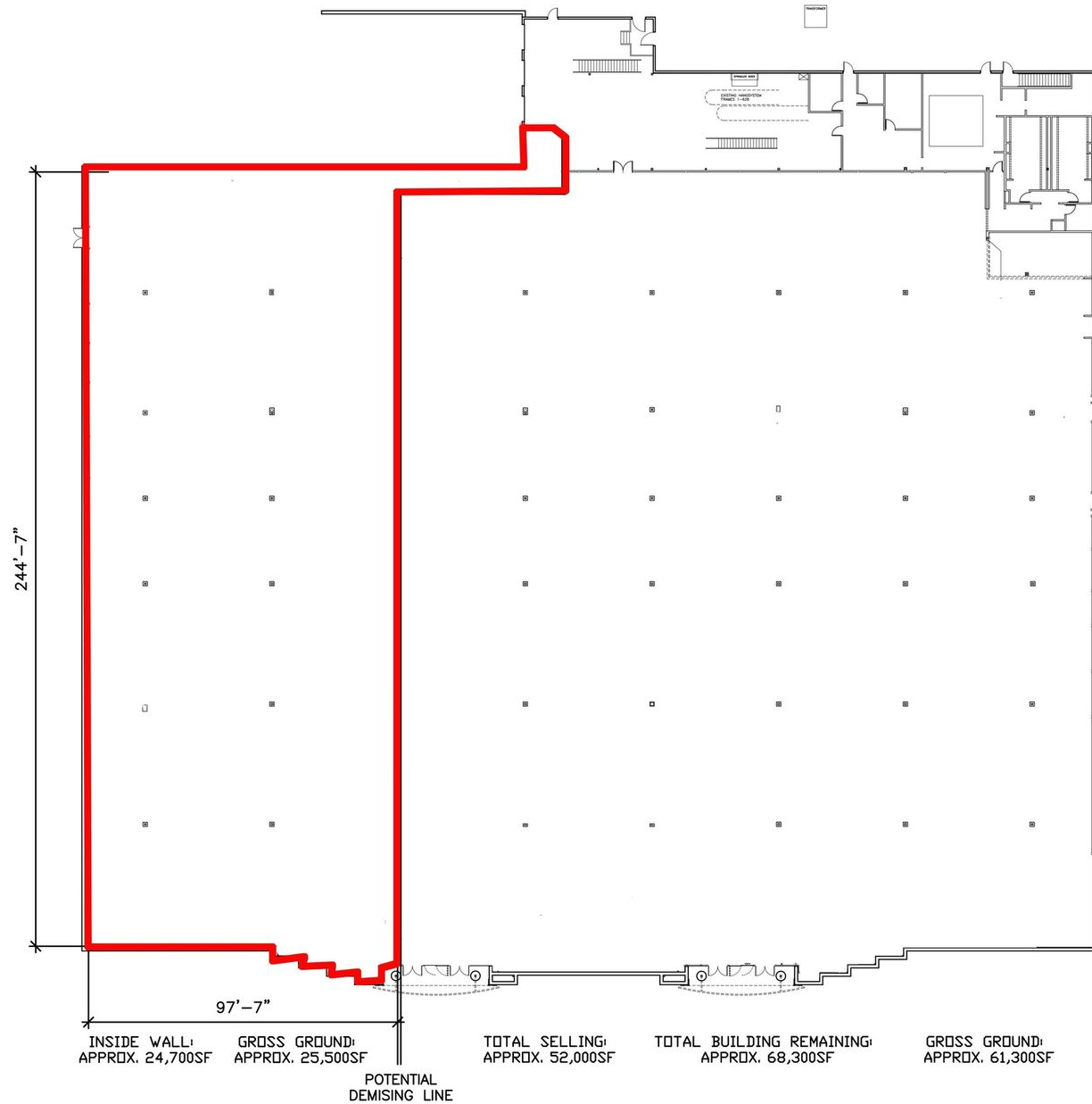

#10452 Lawrenceville, GA
Updated: 3/6/18



FOR MORE INFORMATION, CONTACT EXCLUSIVE AGENT(S):
PATRICK BENTLEY • patrick.bentley@tscg.com • 770.955.2434

