



## 2334 Southpark Dr

Murfreesboro, TN

### Property **Features**

- Office space, conditioned flex space and heated warehouse space.
- Located in the Southgate Business Park adjacent to I-24 at exit 81.
- Warehouse has 14' eave height
- 16' x 10' and 10' x 10' grade door.
- 2,220 SF Office and 6,236 SF Warehouse
- Reception area, conference, restrooms and kitchen/break room.
- Suite A available- \$4,000/month triple net

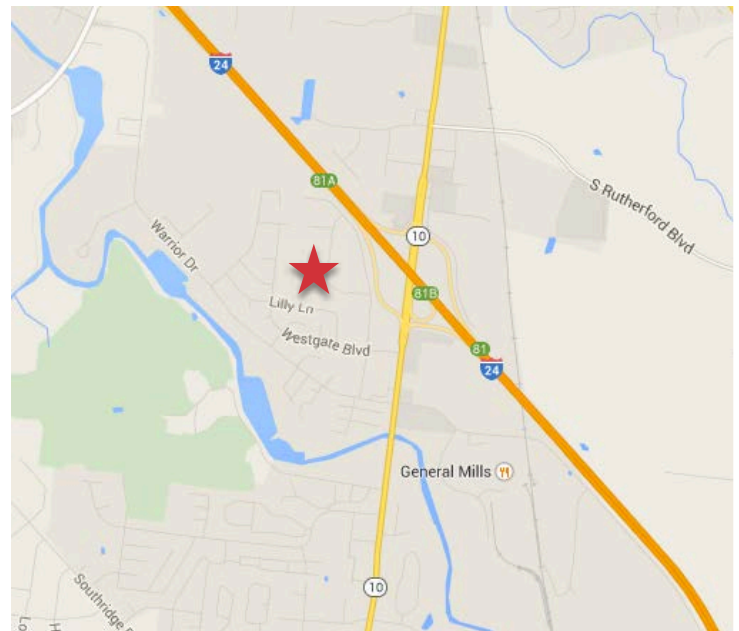

For more information:

**Priscilla Smith**

psmith@nainashville.com

615. 953.9592

7105 Town Center Way, 3<sup>rd</sup> Floor  
Brentwood TN 37027  
+1 615 377 4747

[www.nainashville.com](http://www.nainashville.com)

SOUTHPARK DRIVE

2334 SOUTHPARK DR.  
MURFREESBORO, TN

SUITE	OFFICE	WAREHOUSE
A	850 SF	2400 SF
B	3250 SF	-----
C	-----	1950 SF
<b>TOTAL</b>	<b>4100 SF</b>	<b>4350 SF</b>

8450 SF

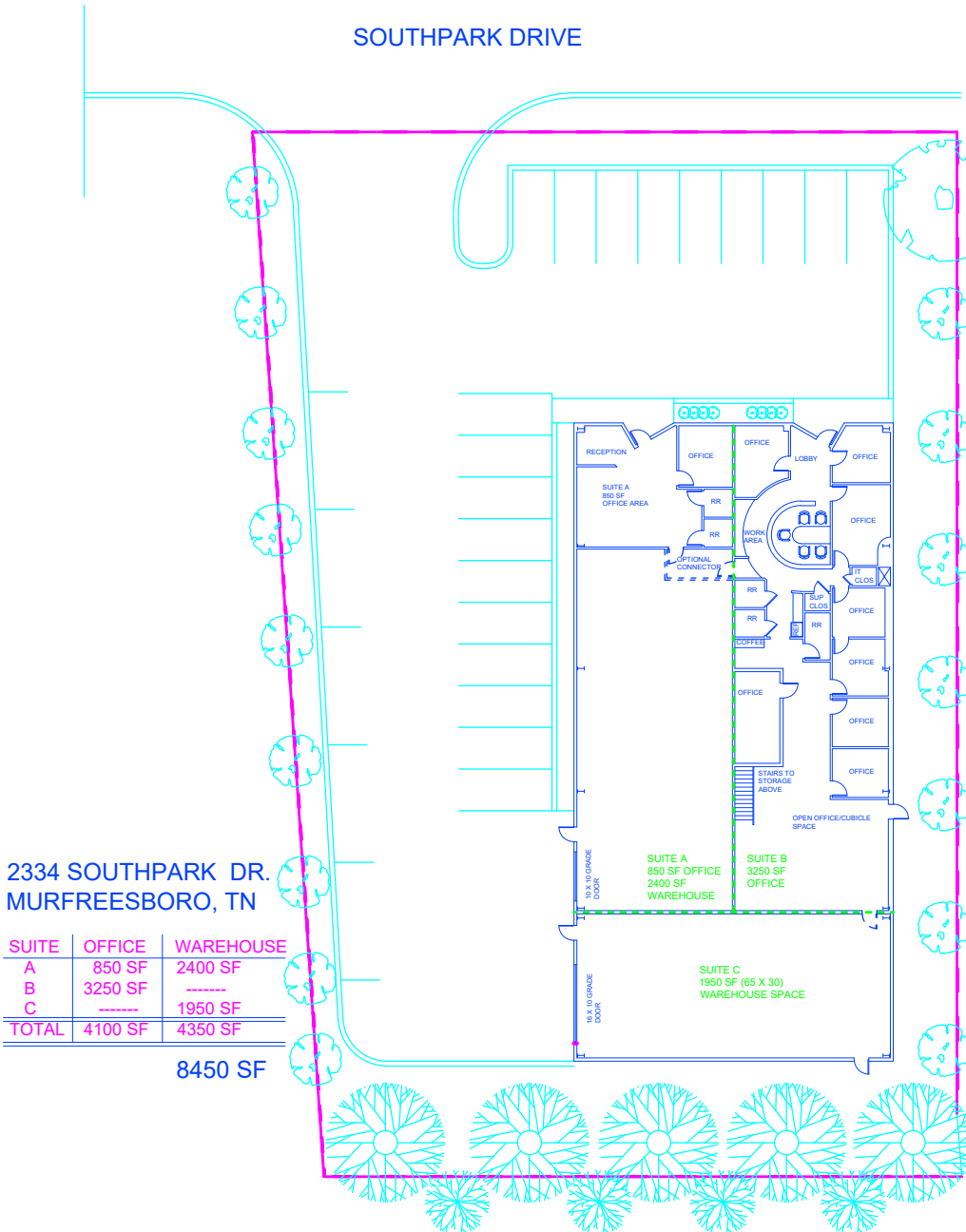

For more information:

**Priscilla Smith**  
psmith@nainashville.com  
615. 953.9592

7105 Town Center Way, 3<sup>rd</sup> Floor  
Brentwood TN 37027  
+1 615 377 4747  
[www.nainashville.com](http://www.nainashville.com)