

FOR SALE OR LEASE

300 W Blackstock Rd. Spartanburg, SC 29301



NAI Earle Furman

Retail | 35,600 SF building on 1.32 Acres

- Neighboring uses are Westgate Mall, Costco, Walmart, Home Depot, Starbucks, Chick-fil-A, and Hobby Lobby
- Easy Access from Interstate 26
- Open concept interior
- Currently occupied by Ashley Furniture Home Store (lease expires 10/31/2020)
- Spartanburg is home to BMW's North American manufacturing facility
- Sale Price: \$2,290,000 | Lease Rate: \$9.00/SF NNN



No Warranty Or Representation, Express Or Implied, Is Made As To The Accuracy Of The Information Contained Herein, And The Same Is Submitted Subject To Errors, Omissions, Change Of Price, Rental Or Other Conditions, Prior Sale, Lease Or Financing, Or Withdrawal Without Notice, And Of Any Special Listing Conditions Imposed By Our Principals No Warranties Or Representations Are Made As To The Condition Of The Property Or Any Hazards Contained Therein Are Any To Be Implied.

✉ **James "Jimmy" Wright**
+1 864 232 9040
jwright@furmancap.com

NAI Earle Furman

Aerial Map

300 W Blackstock Rd. Spartanburg, SC 29301

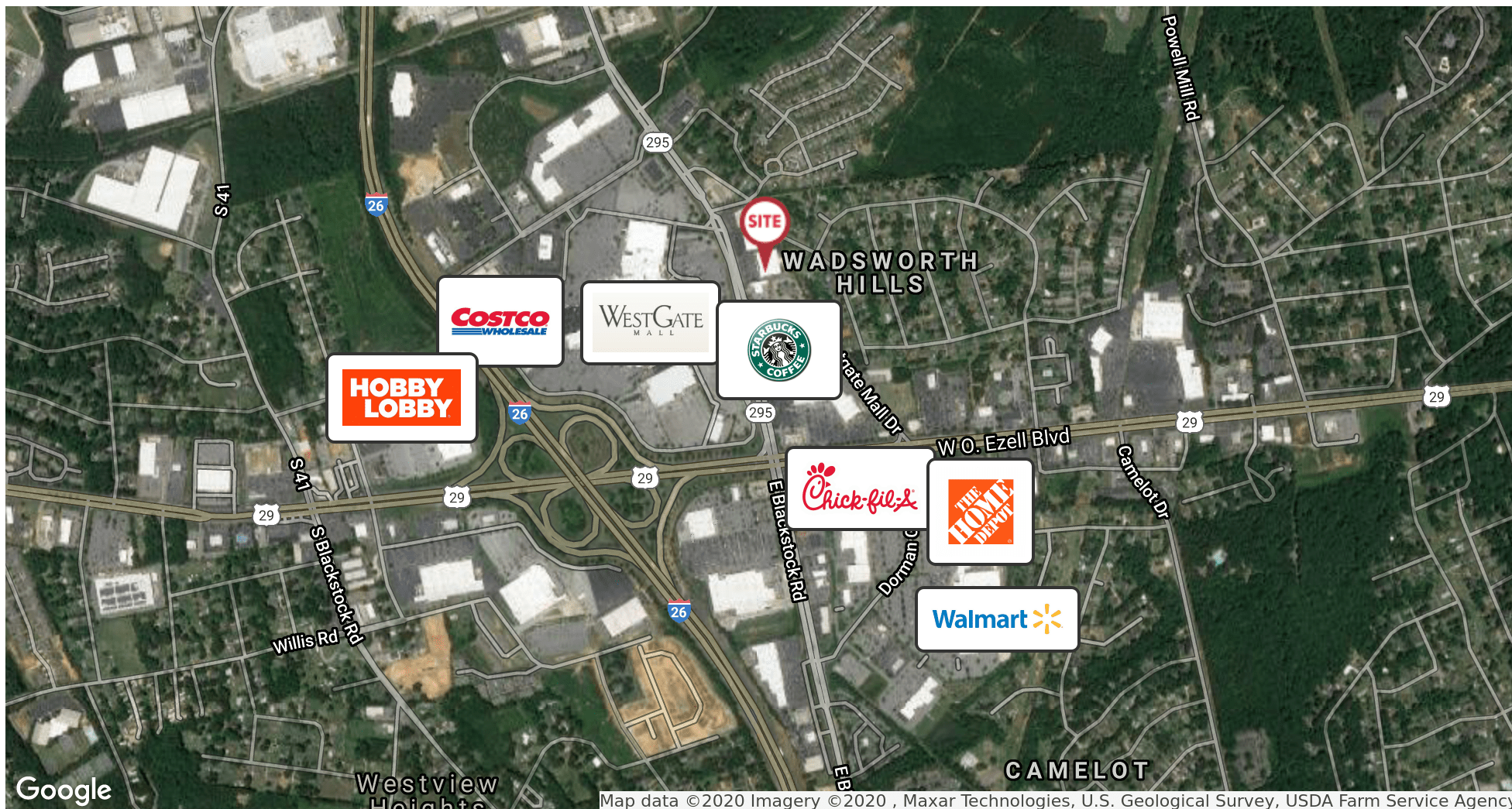

No Warranty Or Representation, Express Or Implied, Is Made As To The Accuracy Of The Information Contained Herein, And The Same Is Submitted Subject To Errors, Omissions, Change Of Price, Rental Or Other Conditions, Prior Sale, Lease Or Financing, Or Withdrawal Without Notice, And Of Any Special Listing Conditions Imposed By Our Principals No Warranties Or Representations Are Made As To The Condition Of The Property Or Any Hazards Contained Therein Are Any To Be Implied.

✉ **James "Jimmy" Wright**
+1 864 232 9040
jwright@furmancap.com

NAI Earle Furman



Morgan Square

Located at the **intersection of Interstates 85 and 26**, Spartanburg is within driving distance of three international airports and less than a half-day's drive from Asheville, Atlanta, Charlotte, Charleston, Greenville and Nashville.

4th Largest County
in SC by population

- 306,854 - Spartanburg County
- 37,498 - City of Spartanburg
- 15,000 - College Students



Downtown Spartanburg was designated as the second **Cultural Arts District** in South Carolina

chapman **cultural** center serves as the heart of the arts community.

Home to the **world headquarters** of **Denny's** and **Milliken**, the **ONLY**  Manufacturing Co. plant in the **United States**, more than **100** international businesses, and **seven colleges and universities**.

GSP AIRPORT
ROGER MILLIKEN FIELD

More than **2.32 million passengers** served in 2018 by 6 major airlines offering 50 non-stop daily departures to 19 major cities and 23 airports across the country.

 **#1 HOSPITAL in SC**

Spartanburg Medical Center (part of the Spartanburg Regional Healthcare System) was named the #1 Hospital in South Carolina by U.S. News and World Report (2015).

Only summer home of the  **CAROLINA PANTHERS**

Ranked as one of the **top five training camps** in the **NFL** for fan friendliness.

There are more than **200 miles** of walking and biking trails in Spartanburg County between Croft State Park, the Palmetto Trail, the Mary Black Foundation Rail Trail and the Cottonwood Trail.



Demographics

300 W Blackstock Rd. Spartanburg, SC 29301

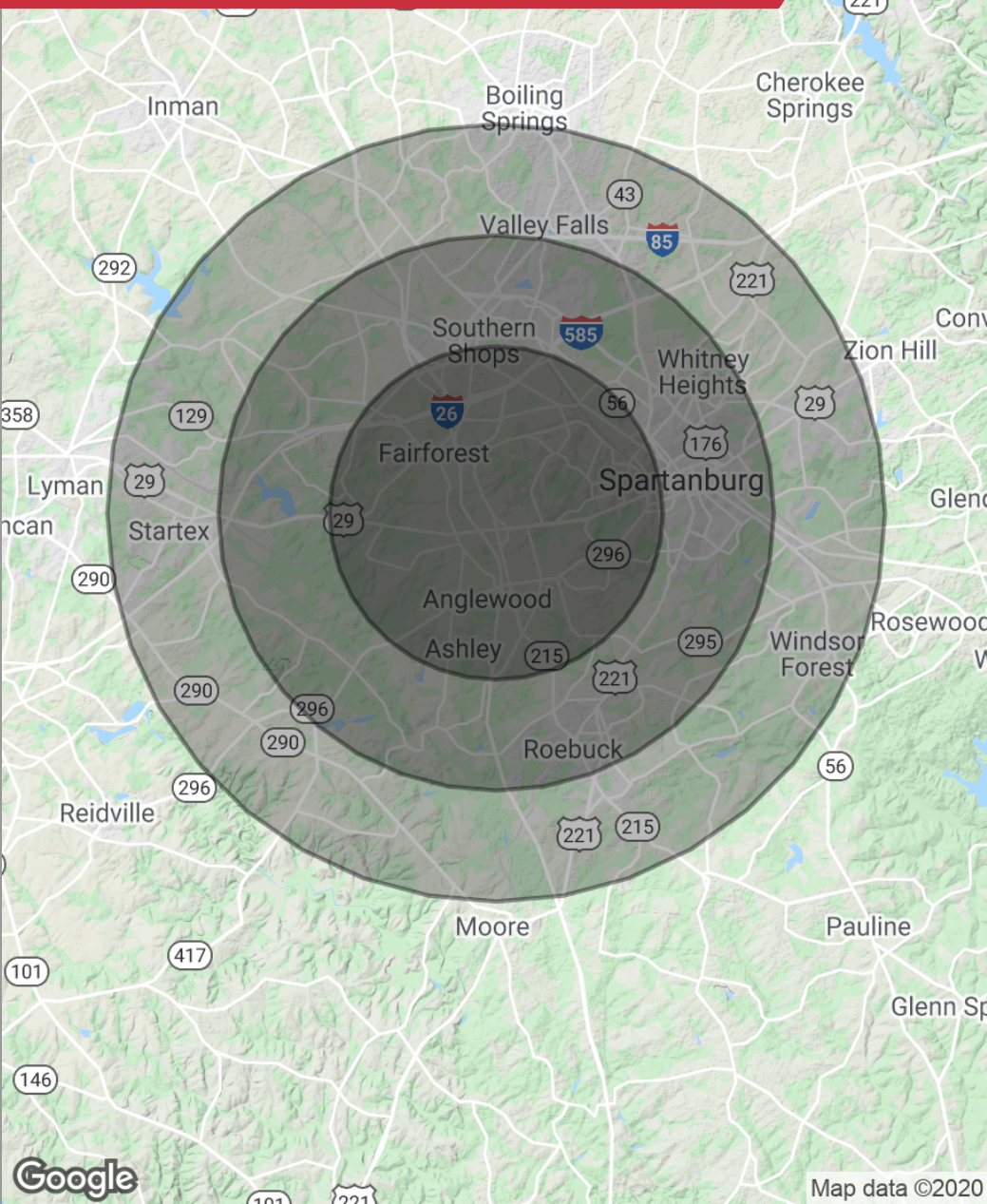

Population	3 Miles	5 Miles	7 Miles
Total population	34,843	83,350	132,630
Median age	33.5	33.3	34.7
Median age (male)	32.7	32.5	34.0
Median age (Female)	35.7	34.8	35.7
Households & Income	3 Miles	5 Miles	7 Miles
Total households	13,067	30,720	49,600
# of persons per HH	2.7	2.7	2.7
Average HH income	\$54,641	\$50,375	\$54,147
Average house value	\$172,306	\$144,234	\$152,647

* Demographic data derived from 2010 US Census

No Warranty Or Representation, Express Or Implied, Is Made As To The Accuracy Of The Information Contained Herein, And The Same Is Submitted Subject To Errors, Omissions, Change Of Price, Rental Or Other Conditions, Prior Sale, Lease Or Financing, Or Withdrawal Without Notice, And Of Any Special Listing Conditions Imposed By Our Principals No Warranties Or Representations Are Made As To The Condition Of The Property Or Any Hazards Contained Therein Are Any To Be Implied.

✉ **James "Jimmy" Wright**
 +1 864 232 9040
 jwright@furmancap.com

NAI Earle Furman

Store Layout

300 W Blackstock Rd. Spartanburg, SC 29301

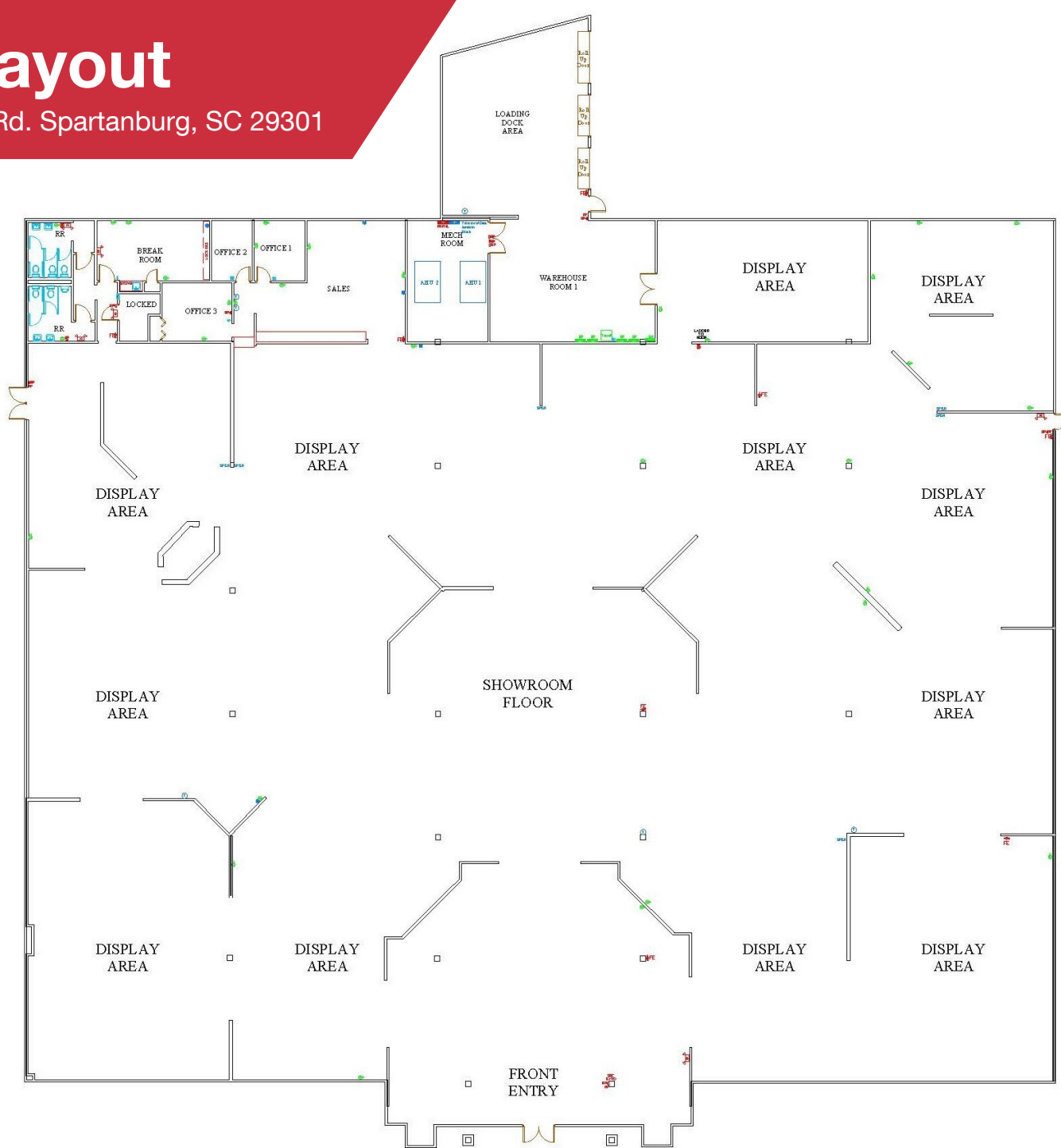

No Warranty Or Representation, Express Or Implied, Is Made As To The Accuracy Of The Information Contained Herein, And The Same Is Submitted Subject To Errors, Omissions, Change Of Price, Rental Or Other Conditions, Prior Sale, Lease Or Financing, Or Withdrawal Without Notice, And Of Any Special Listing Conditions Imposed By Our Principals No Warranties Or Representations Are Made As To The Condition Of The Property Or Any Hazards Contained Therein Are Any To Be Implied.

✉ **James "Jimmy" Wright**
+1 864 232 9040
jwright@furmancap.com

NAI Earle Furman