

# 25000 COLLEGE BLVD

OLATHE, KS 66061



**PRICE REDUCTION!**



## HIGHLIGHTS

- » 10,664 SF Flex Building
- » 3,682 SF Warehouse with 22'-24' Ceiling Height & Drive-In Door
- » 3,300 Total SF Office with 12'-15' Ceiling Height
  - Ste 100 East - 1,800 SF
  - Ste 200 West - 1,500 SF
- » High End Office Space Finishes
- » Full Kitchen
- » Travertine Floors, Maple Wood Molding, LED Light Fixtures
- » LED Lighting - 150 Watt, Dimmable
- » Warehouse has HVAC, heat and air conditioning
- » Racking Available at Price

**FOR SALE**  
**FOR LEASE**

**\$1,928,000 or**  
Office - \$19.00/SF IG  
Warehouse - \$9.00/SF IG

\*Note: Favorable bank financing available

## DEMOGRAPHICS

|                           | 1 Mile    | 3 Mile    | 5 Mile   |
|---------------------------|-----------|-----------|----------|
| 2018 TOTAL POPULATION     | 3,042     | 21,523    | 72,792   |
| 2018 MED HOUSEHOLD INCOME | \$166,952 | \$114,970 | \$87,248 |

### Jim Thome

Direct: 913.548.8700

Fax: 913.981.9082

Email: [jthome@reececommercial.com](mailto:jthome@reececommercial.com)

The information above has been obtained from sources believed reliable. While we do not doubt its accuracy we have not verified it and make no guarantee, warranty or representation about it. It is your responsibility to independently confirm its accuracy and completeness. Any projections, opinions, assumptions, or estimates used are for example only and do not represent the current or future performance of the property. You and your advisors should conduct a careful, independent investigation of the property to determine to your satisfaction the suitability of the property for your needs.

© 2018



# FLOOR PLAN

25000 COLLEGE BLVD, OLATHE, KS 66061

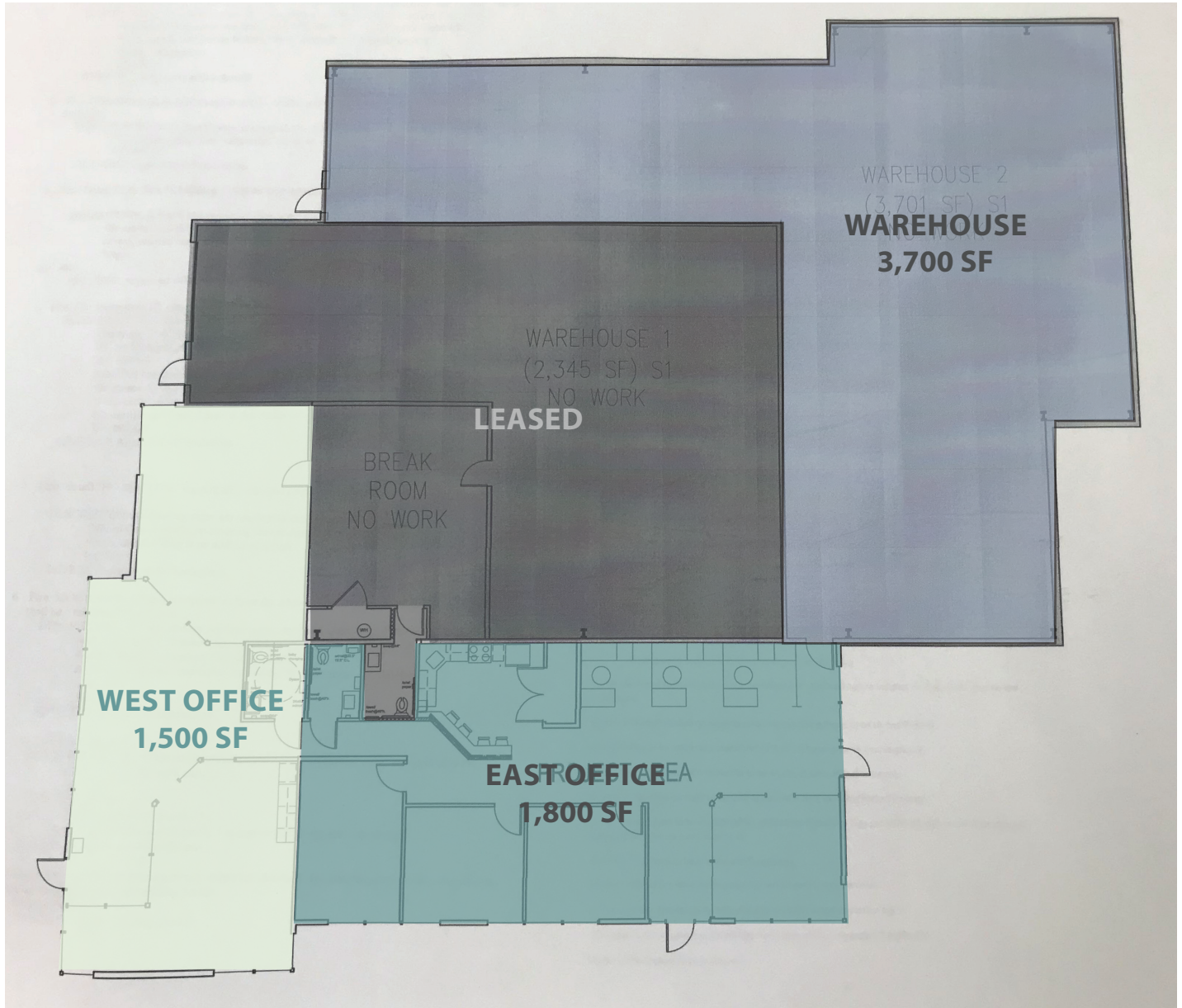

**Jim Thome**

Direct: 913.548.8700

Fax: 913.981.9082

Email: [jthome@reececommercial.com](mailto:jthome@reececommercial.com)

The information above has been obtained from sources believed reliable. While we do not doubt its accuracy we have not verified it and make no guarantee, warranty or representation about it. It is your responsibility to independently confirm its accuracy and completeness. Any projections, opinions, assumptions, or estimates used are for example only and do not represent the current or future performance of the property. You and your advisors should conduct a careful, independent investigation of the property to determine to your satisfaction the suitability of the property for your needs.

© 2018

# PROPERTY FEATURES

25000 COLLEGE BLVD, OLATHE, KS 66061



- » Honed Travertine Office Floors
- » Porcelain Tile in bathrooms and kitchen.
- » Radiant Heated Floors in 6 areas of offices. about 1,500 SF of the floors.
- » HVAC systems in Offices outfitted with Microspore filter systems to eliminate allergens.
- » HVAC auto shut off's for smoke alarms.
- » HVAC system new Spiral Ducting and low profile diffusers.
- » Electronic NEST Thermostats with Smart system operation.
- » Fire Alarm System completely new. Wire, Smoke Detectors, Strobes, Horns, Emergency Lights, Computer Module. Monitored and Serviced by SEI. (They did all the install).
- » Fire Extinguishers - 12 new Cintas provided and serviced.
- » Electrical Outlets and Switches in offices ALL new. Lutron Maestro Smart Switches for all Lighting with remote control.
- » Electrical Pendant LED light fixtures in offices all new with dimming feature and 70 up 30 down lighting diffusion.
- » Electrical Lighting in Bathrooms, Exterior walkthrough doors with motion detection switches.
- » Electronic Schlage Door Locks with coding.
- » Bathrooms fixtures toilets, urinal, granite countertops with granite sinks, auto on Sloan faucets, auto feed stainless recessed Georgia Pacific Paper Dispensers.
- » Full Kitchen. Blue Pearl Royale Granite. Kraftmaid Maple Cabinets. Samsung appliances.
- » Full Conference Room Blue Pearl Royale Granite Counters, Kraftmaid Maple Cabinets with Stainless Counter level refrigerator with ice maker.
- » Full hard ceiling with knockdown texture with a reflective catalyst based white paint. (reduces dust clinging to ceiling.
- » Crown Moulding on the entire perimeter of ceilings.
- » Glass Walls manufactured and installed by BUILT. 9' heights with sliding slow close glide doors.
- » Pella Casement Windows - 27 banks of 48" wide. ( Every window tested by a Pella technician. All tested good.)

## Jim Thome

Direct: 913.548.8700

Fax: 913.981.9082

Email: [jthome@reececommercial.com](mailto:jthome@reececommercial.com)

# PROPERTY FEATURES

25000 COLLEGE BLVD, OLATHE, KS 66061



- » Maple hardwood casements and molding on all windows. All interior doors are solid core Maple wood. All wood work was refinished to new.
- » Concrete Floors were all deep cleaned and grinded Polished.
- » Handicapped Door Opener on walkthrough glass South door.
- » Warehouse Lighting all new state of the art LED High Bays 150 watt dimmable.
- » Interior Office and Warehouse walls with new paint.
- » Window Roller Shades 5% fabric by Bali.
- » Exterior Patio on the east side of building with own exit.
- » Exterior walls are all Stucco.
- » Exterior Office Roof is Concrete Shingle.
- » Offices Air Conditioners - 1 for West side. 1 for East side.
- » Warehouse Air Conditioners - LAD Warehouse - 2 units. COR Warehouse - 1 unit. All in excellent condition.

The Space breakdown is:

LAD Offices - 3,300 SF

LAD Warehouse - 4,300 SF

COR warehouse with Kitchen and Bathroom - 3,050 SF

## Jim Thome

Direct: 913.548.8700

Fax: 913.981.9082

Email: [jthome@reececommercial.com](mailto:jthome@reececommercial.com)



# PHOTOS

25000 COLLEGE BLVD, OLATHE, KS 66061



## Jim Thome

Direct: 913.548.8700

Fax: 913.981.9082

Email: [jthome@reececommercial.com](mailto:jthome@reececommercial.com)

The information above has been obtained from sources believed reliable. While we do not doubt its accuracy we have not verified it and make no guarantee, warranty or representation about it. It is your responsibility to independently confirm its accuracy and completeness. Any projections, opinions, assumptions, or estimates used are for example only and do not represent the current or future performance of the property. You and your advisors should conduct a careful, independent investigation of the property to determine to your satisfaction the suitability of the property for your needs.

© 2018



# AERIALS

25000 COLLEGE BLVD, OLATHE, KS 66061



## Jim Thome

Direct: 913.548.8700

Fax: 913.981.9082

Email: [jthome@reececommercial.com](mailto:jthome@reececommercial.com)

The information above has been obtained from sources believed reliable. While we do not doubt its accuracy we have not verified it and make no guarantee, warranty or representation about it. It is your responsibility to independently confirm its accuracy and completeness. Any projections, opinions, assumptions, or estimates used are for example only and do not represent the current or future performance of the property. You and your advisors should conduct a careful, independent investigation of the property to determine to your satisfaction the suitability of the property for your needs.

© 2018