

INDUSTRIAL SPACE FOR LEASE

SAINT PAUL INDUSTRIAL PROPERTIES #19

2600 Cleveland Avenue North | Roseville, MN 55113



Conveniently located at the intersection of County Road C & Cleveland Avenue, this property boasts an impressive location with excellent visibility to I-35W as well as easy access to both downtowns via I-35W, Hwy 36, Hwy 280 and many other local arteries. Tenants enjoy nearby dining, shopping and hotel accommodations. Metro Transit bus routes are within easy walking distance as well as the Rosedale Center Metro Transit Hub.

BUILDING SPECS

- 27,320 Total SF
- 3,533 SF Office
- 23,787 SF Warehouse
- 18' Clear Height Warehouse

RENTAL RATES

- \$0.87 PSF CAM (2020 est.)
- \$1.78 PSF PSF RE Tax (2019 est.)
- \$4.75 - \$8.75 PSF

CONTACT

JOHN R. THOMPSON, SIOR
612.359.1645
john.thompson@transwestern.com

ALEXANDER D. BARON
612.359.1658
alex.baron@transwestern.com

LOADING

- 4 Dock Doors
- 1 Drive-in

FLOORPLAN

Suite 2600 - Endcap Space

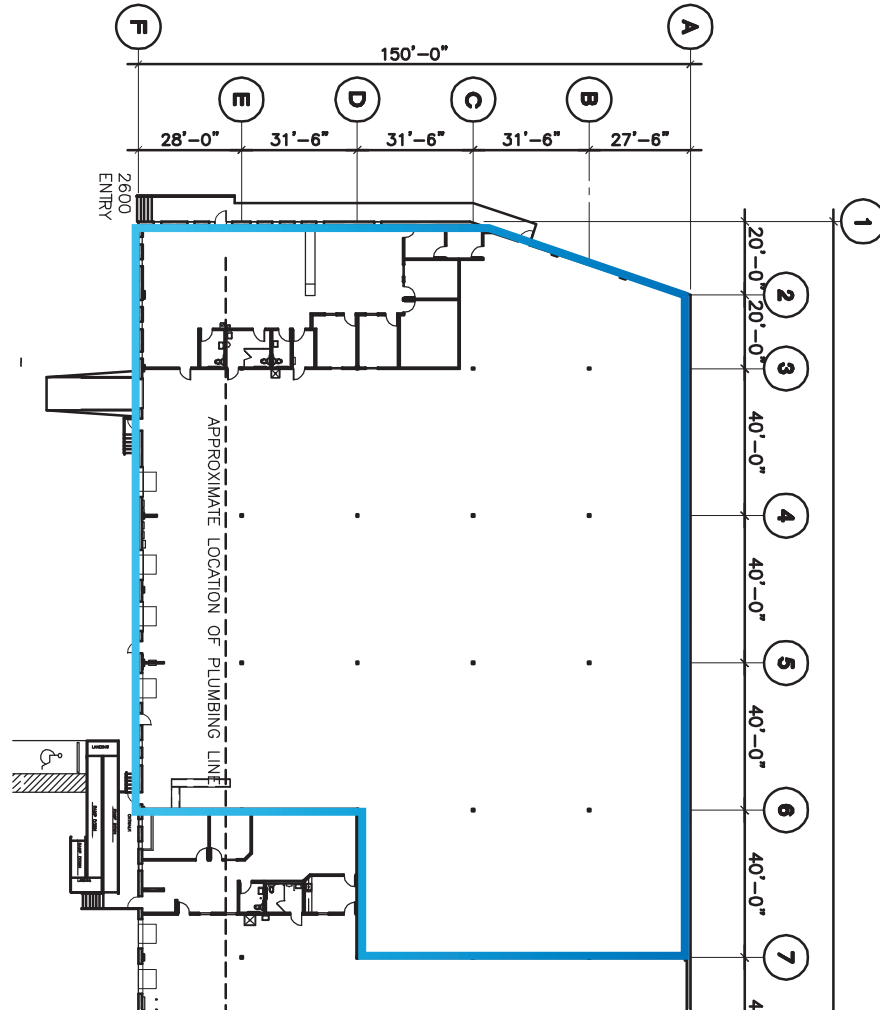

CONTACT

JOHN R. THOMPSON, SIOR
612.359.1645
john.thompson@transwestern.com

ALEXANDER D. BARON
612.359.1658
alex.baron@transwestern.com

