

FOOTHILL BUSINESS PARK

A Multi-Tenant Business Park

1,698 & 2,024 Sq. Ft. Flex Suites Available For Lease



20321, 20331, 20371, 20381 Lake Forest Drive • Lake Forest, California

 **LEE &
ASSOCIATES**
COMMERCIAL REAL ESTATE SERVICES

ALLEN BASSO
Senior Vice President
CalBRE 01298152
949.790.3130
abasso@lee-associates.com

RYAN HARMAN
Senior Vice President
CalBRE 01399616
949.790.3136
rharman@lee-associates.com

Lee & Associates, Inc. - Irvine
9838 Research Drive
Irvine, California 92618
www.lee-associates.com

No warranty or representation is made to the accuracy of the foregoing information. Terms of sale or lease and availability are subject to change or withdrawal without notice.





FOOTHILL BUSINESS PARK

A Multi-Tenant Business Park

20321, 20331, 20371, 20381 Lake Forest Drive • Lake Forest, California

Property Features:

- Leasing incentives possible
- Retail amenities nearby
- Excellent 241 Toll Road access
- Individual tenant signage
- Cox Cable/internet available
- 12'x12' ground level doors
- Separately metered utilities
- Fire sprinklered
- 2.8:1,000 parking ratio
- 100 amps, 3 phase power
- 16' to 20' warehouse clearance

Site Map:

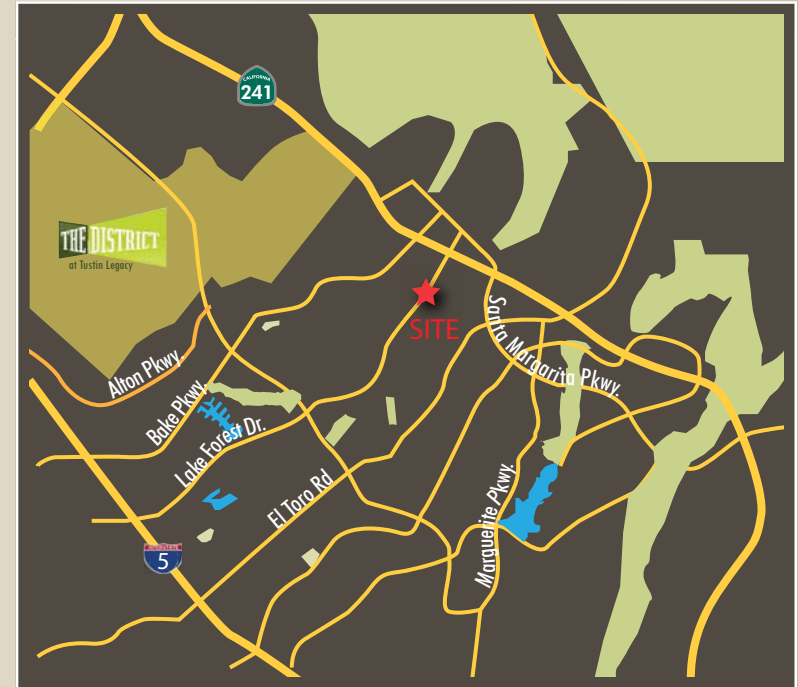
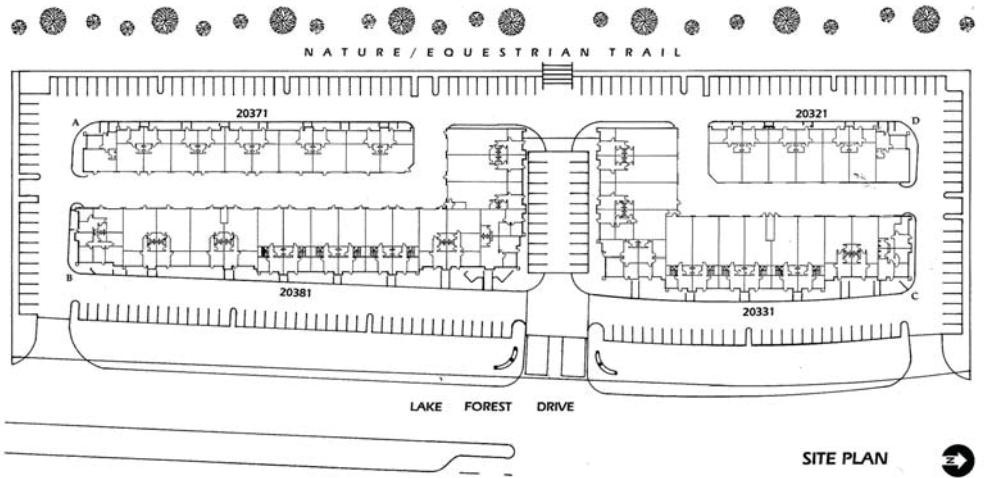

LEE & ASSOCIATES
COMMERCIAL REAL ESTATE SERVICES

ALLEN BASSO
Senior Vice President
CalBRE 01298152
949.790.3130
abasso@lee-associates.com

RYAN HARMAN
Senior Vice President
CalBRE 01399616
949.790.3136
rharman@lee-associates.com

Lee & Associates, Inc. - Irvine
9838 Research Drive
Irvine, California 92618
www.lee-associates.com



No warranty or representation is made to the accuracy of the foregoing information. Terms of sale or lease and availability are subject to change or withdrawal without notice.



FOOTHILL BUSINESS PARK

A Multi-Tenant Business Park

20321, 20331, 20371, 20381 Lake Forest Drive • Lake Forest, California

CURRENT AVAILABILITY

Suite	Total Sq. Ft.	Office Sq. Ft.	Percent Office Space	Lease Rate*	Comments
BLDG A. - 20371 Lake Forest Drive					
<i>100% LEASED</i>					
BLDG B. - 20381 Lake Forest Drive					
20381-B19	1,698 SF	390 SF	23%	\$1.35 Gross	Reception, two private offices, restroom, and warehouse. Available 8/1/2018.
BLDG. C - 20331 Lake Forest Drive					
20331-C7	2,024 SF	1,158 SF	57%	\$1.35 Gross	Reception, private office, restroom, and second floor office space.
BLDG. D - 20321 Lake Forest Drive					
<i>100% LEASED</i>					

*\$150 CAM Charge per Month



ALLEN BASSO

Senior Vice President
 CalBRE 01298152
 949.790.3130
 abasso@lee-associates.com

RYAN HARMAN

Senior Vice President
 CalBRE 01399616
 949.790.3136
 rharman@lee-associates.com

Lee & Associates, Inc. - Irvine
 9838 Research Drive
 Irvine, California 92618
 www.lee-associates.com



No warranty or representation is made to the accuracy of the foregoing information. Terms of sale or lease and availability are subject to change or withdrawal without notice.