

W/SWC LAKE PLEASANT PKWY & PINNACLE PEAK RD

PROPERTY INFORMATION

- Parcel Size: ±170,745 SF (±3.92 acres)
- Parcel Number: 200-10-051A (Maricopa County)
- Zoning: PAD
- Development-ready PAD
- One of the fastest growing areas in Phoenix MSA
- Site adjacent to new Peoria Police and Fire Station
- Call for pricing

2019 DEMOGRAPHICS	1 MI.	3 MI.	5 MI.
ESTIMATED POPULATION	6,986	64,111	166,068
2024 PROJECTED POP.	7,972	71,312	180,469
AVERAGE HOUSEHOLD INCOME	\$115,892	\$108,047	\$98,677
ESTIMATED MEDIAN AGE	35.6	41.0	47.8

SOURCE: Esri 2019

TRAFFIC COUNTS	
LAKE PLEASANT PRKWY	24,409 VPD
PINNACLE PEAK ROAD	1,434 VPD

SOURCE: City of Peoria 2017

CONTACT US

RYAN EUSTICE

Vice President

+1 602 735 1917

ryan.eustice@cbre.com

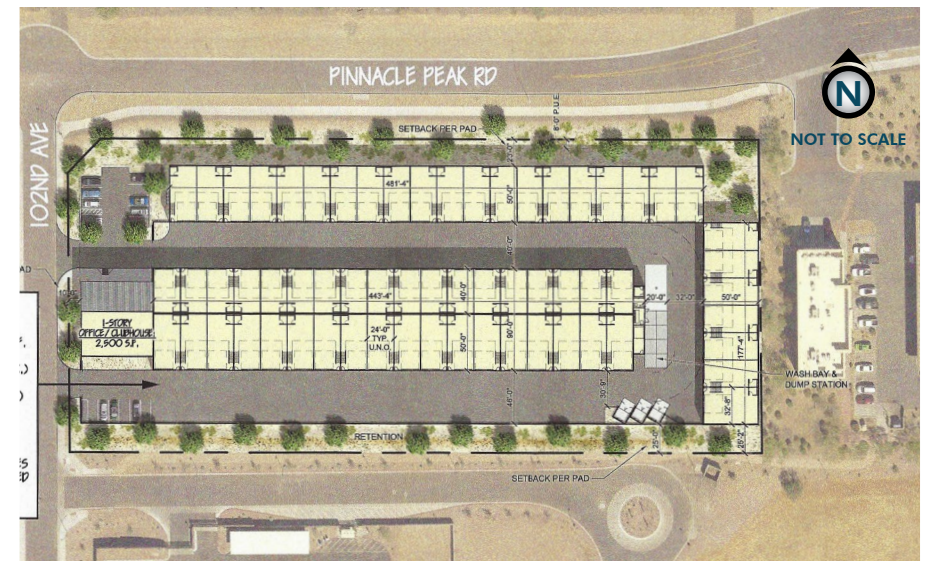
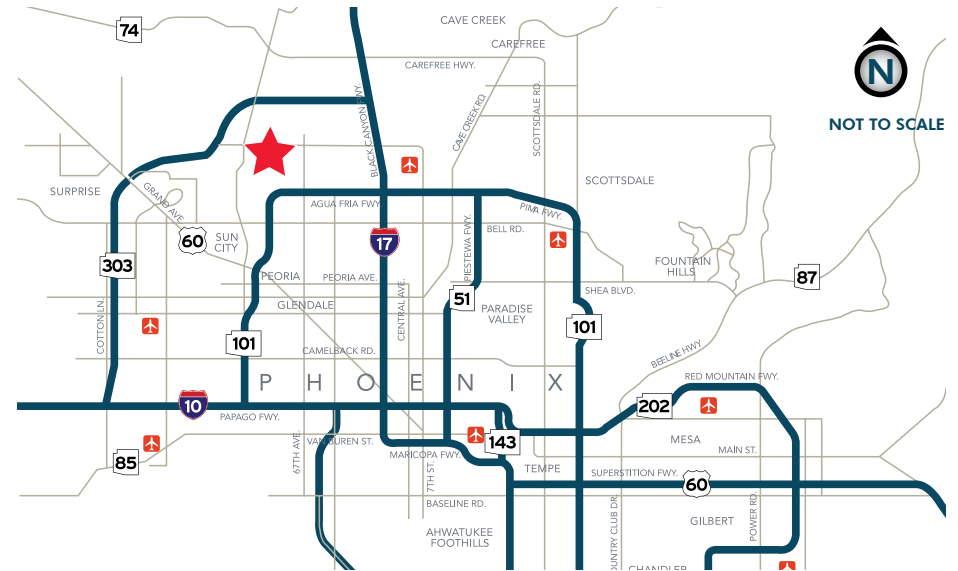

© 2019 CBRE, Inc. All rights reserved. This information has been obtained from sources believed reliable, but has not been verified for accuracy or completeness. You should conduct a careful, independent investigation of the property and verify all information. Any reliance on this information is solely at your own risk. CBRE and the CBRE logo are service marks of CBRE, Inc. All other marks displayed on this document are the property of their respective owners, and the use of such logos does not imply any affiliation with or endorsement of CBRE. Photos herein are the property of their respective owners. Use of these images without the express written consent of the owner is prohibited.