

# 238

## E. 59TH STREET

## PRIME LOCATION ON HOME GOODS BLOCK

PERFECT FOR LIGHTING, BEDDING AND INTERIOR DESIGN TENANTS ON THE NORTHEAST CORNER OF SECOND AVENUE AND E. 59TH STREET



GROUND FLOOR	<b>3,640 SF</b>
CEILING HEIGHT	<b>12 FT</b>
FRONTAGE	<b>30 FT</b>
POSSESSION	<b>IMMEDIATE</b>

- Located on one of the most densely populated home goods blocks in Manhattan
- Outstanding presence at the base of a luxury residential tower adjacent to the Weill Cornell Medical Center's Entrance
- Excellent co-tenancy with the Fine Arts and Decoration & Design Buildings on the block
- Double pane glass window frontage with excellent exposure to 59th Street bridge traffic

# 238

## E. 59TH STREET

# GROUND FLOOR FLOORPLAN

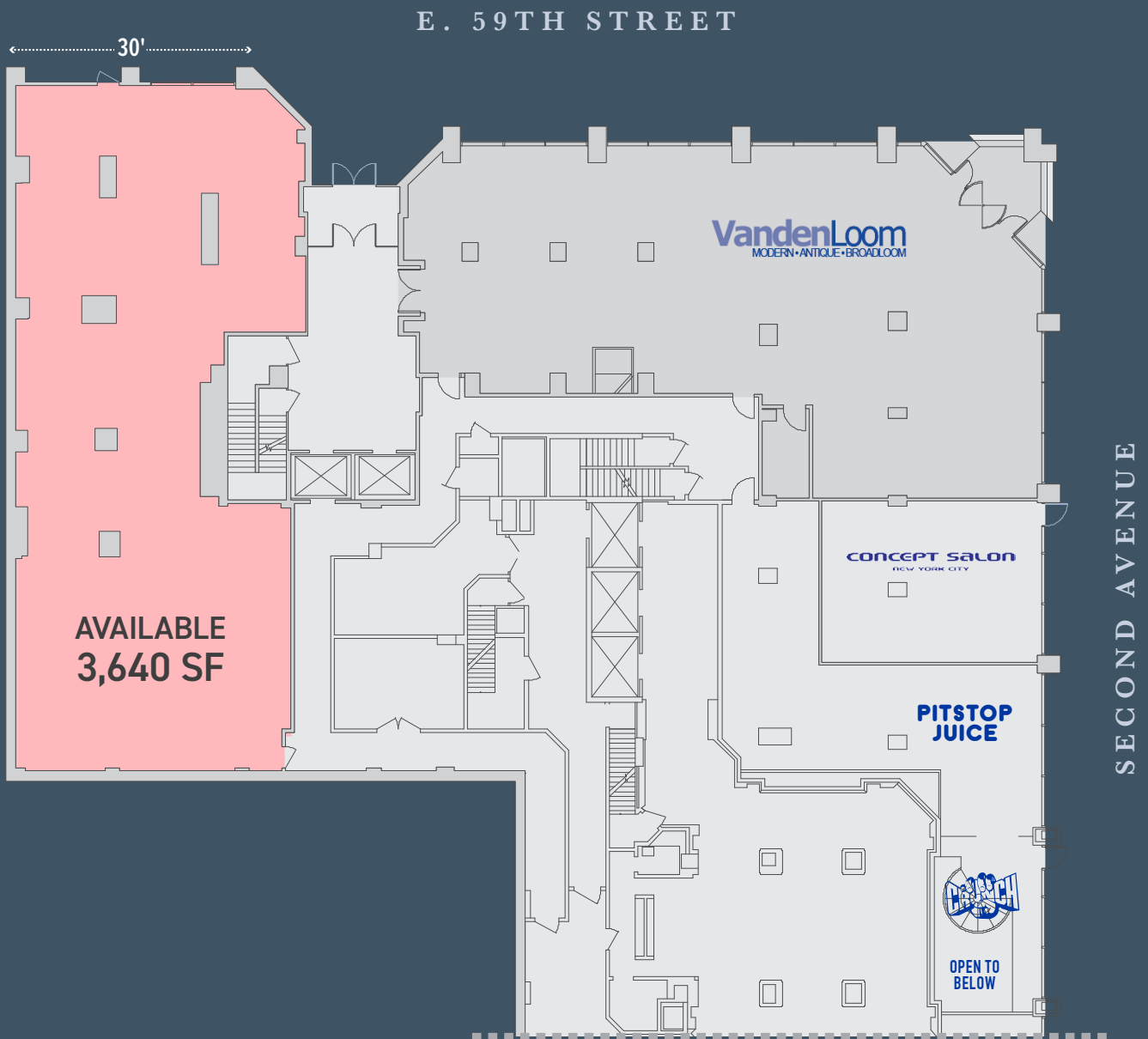

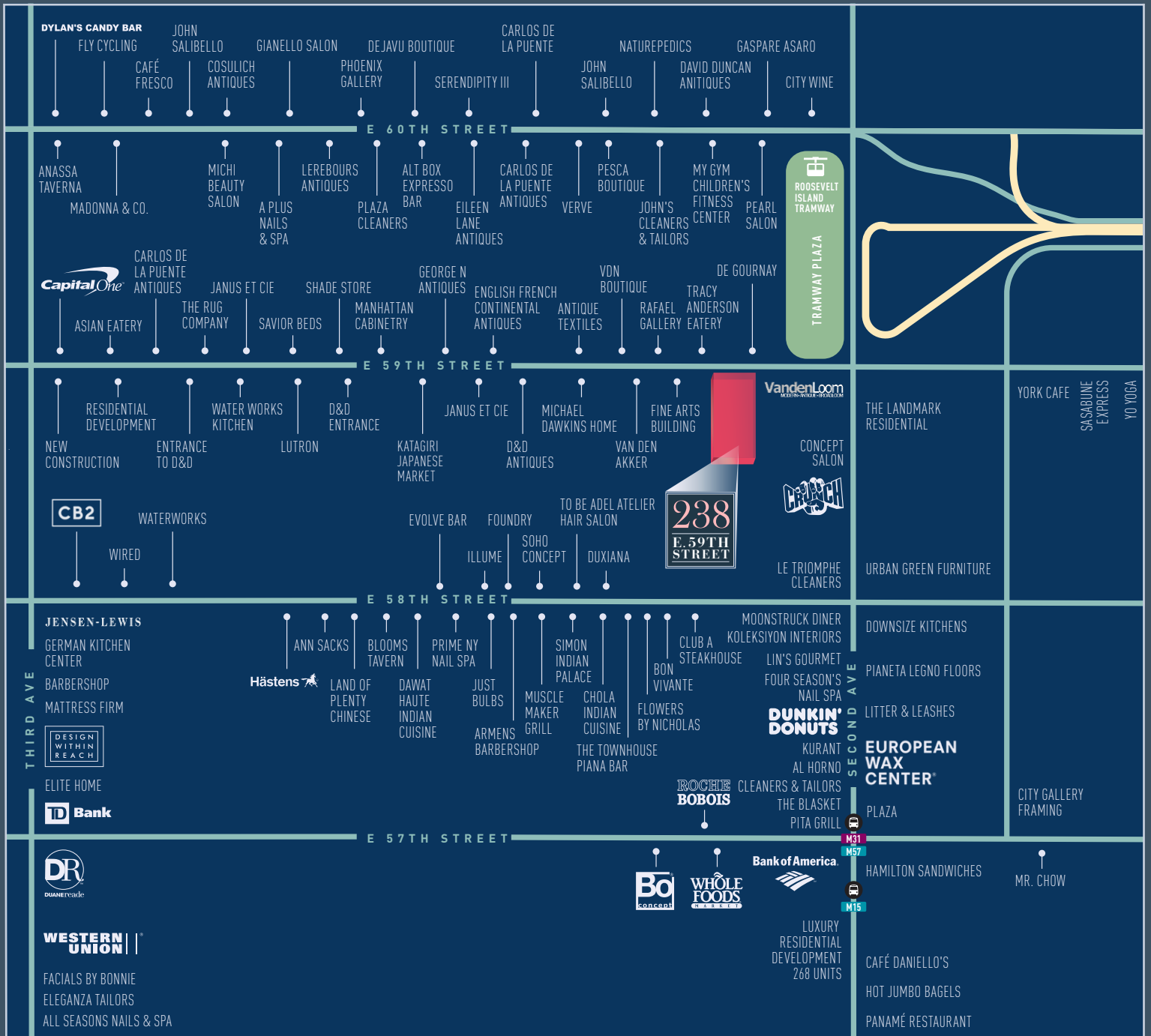

## SURROUNDING TENANTS

- |  |                                 |
|--|---------------------------------|
| MICHAEL DAWKINS HOME                     | DESIGN WITHIN REACH             |
| D&D ANTIQUES                             | ELITE HOME                      |
| DUXIANA                                  | HÄLSTENS                        |
| VAN DEN AKKER                            | GEORGE N ANTIQUES               |
| DE GOURNAY                               | FOUNDRY                         |
| JANUS ET CIE                             | ANTIQUE TEXTILES                |
| ENGLISH FRENCH CONTI-<br>NENTAL ANTIQUES | SAVIOR BEDS                     |
| SOHO CONCEPT                             | CARLOS DE LA PUENTE<br>ANTIQUES |
| ILLUME                                   | MANHATTAN CABINETRY             |
| CB2                                      | THE SHADE STORE                 |
| ANN SACKS                                | CHARLES P ROGERS                |
| WATERWORKS                               | THE RUG COMPANY                 |

POPULATION  
**164,455**

MEDIAN AGE  
**40.6**



AVERAGE  
HOUSEHOLD INCOME  
**\$186,667**

WITHIN  
**1 MILE  
RADIUS**

**78.3%**  
RESIDENTS WITH  
BACHELORS DEGREE  
OR HIGHER EDUCATION

**6** LEX AVE/59TH ST  
SUBWAY STATION  
ANNUAL RIDERSHIP  
**21+ MILLION**  
9TH BUSIEST STATION



PLEASE CONTACT US WITH RETAIL LEASING INQUIRIES:

---

STEVEN SOUTENDIJK

212 713 6845

[STEVEN.SOUTENDIJK@CUSHWAKE.COM](mailto:STEVEN.SOUTENDIJK@CUSHWAKE.COM)

SEAN MORAN

212 841 7668

[SEAN.MORAN@CUSHWAKE.COM](mailto:SEAN.MORAN@CUSHWAKE.COM)

MOLLY SANDZA

212 841 7955

[MOLLY.SANDZA@CUSHWAKE.COM](mailto:MOLLY.SANDZA@CUSHWAKE.COM)

PATRICK O'ROURKE

212 660 7777

[PATRICK.OROURKE@CUSHWAKE.COM](mailto:PATRICK.OROURKE@CUSHWAKE.COM)

