



## "BUILDING H"





# Turner Spectrum Ridge at Deer Valley

925 E. Salter Dr., Phoenix, AZ, 85024

**"BUILDING H"**



## FEATURES AND BENEFITS

- **Block Wall Fencing & Rolling Gate** – Yards are specifically designed to be a minimum of 10% larger than any other Deer Valley Development
- **Clear Height 22'** – Increases the usable square footage, and potential for an additional tier of racking
- **1/4 -mile from a Full-Diamond Interchange** – Less time on surface streets increases productivity and lowers operating costs
- **Turn-Key Delivery** – Saves on start-up costs and time to occupy the building
- **A-1 Zoning** – Deer Valley's most flexible zoning allows users to diversify their uses and creates a greater resale value



## CONTACT

Click: [www.turnerspectrumridge.com](http://www.turnerspectrumridge.com)

Mike Ciosek, Senior Vice President  
602.513.5135 - 602.680.0222 cell  
mciosek@voitco.com

Eric Bell, Senior Vice President  
602.513.5151 - 602.380.1990 cell  
ebell@voitco.com

**Bell & Ciosek**  
CRE SPECIALISTS

**Voit**  
REAL ESTATE SERVICES



## Turner Spectrum Ridge at Deer Valley

925 E. Salter Dr., Phoenix, AZ, 85024

**"BUILDING H"**

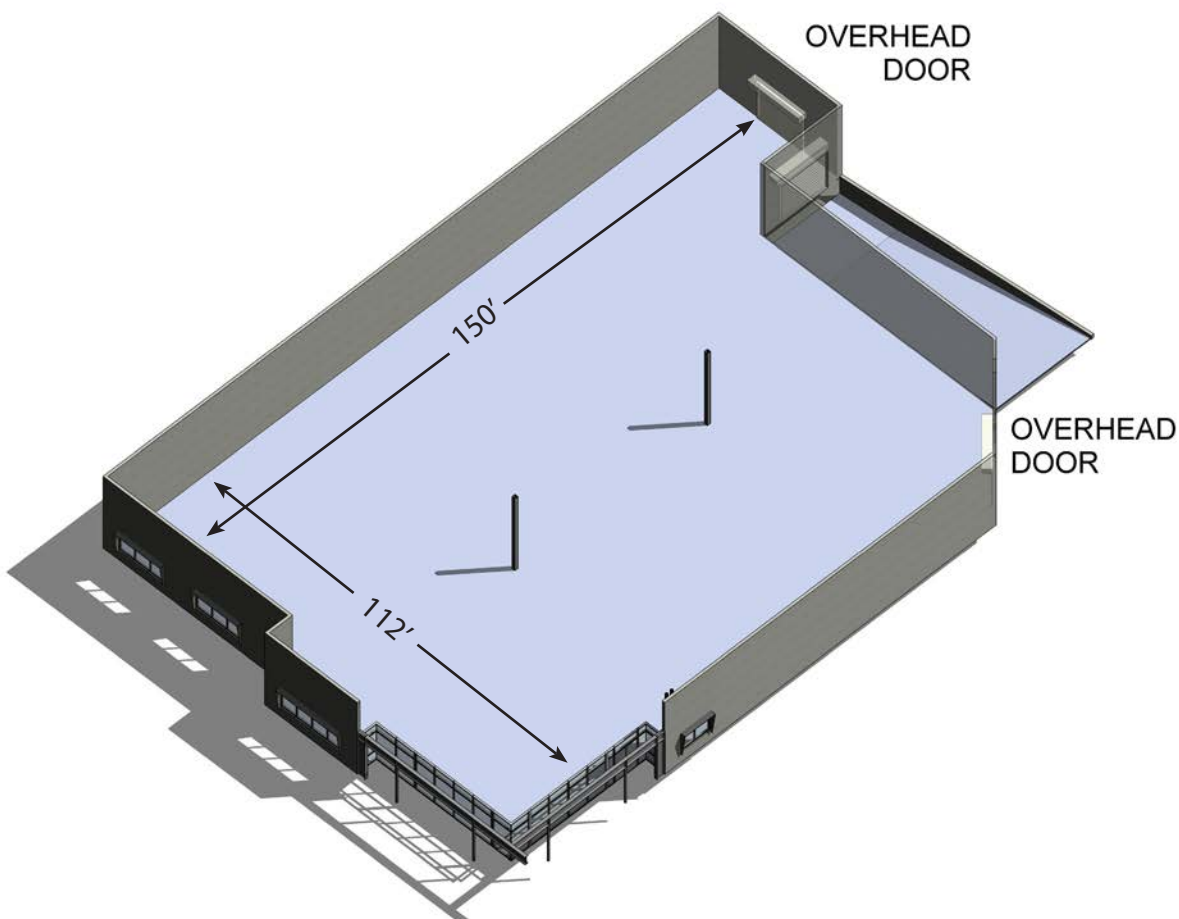

### CONTACT

Click: [www.turnerspectrumridge.com](http://www.turnerspectrumridge.com)

Mike Ciosek, Senior Vice President  
602.513.5135 - 602.680.0222 cell  
mciosek@voitco.com

Eric Bell, Senior Vice President  
602.513.5151 - 602.380.1990 cell  
ebell@voitco.com

**Bell & Ciosek**  
CRE SPECIALISTS

**Voit**  
REAL ESTATE SERVICES