

2,000± SF SHOP ON 2.53± AC FOR SALE

22024 E. LIBERTY ROAD, CLEMENTS, CA

APN: 021-200-25
SHOP BLDG: 2,000± SF
MODULAR OFFICE: 250± SF
LAND: 2.53± AC
GL DOORS: Two (2)
ZONING : C-X (Crossroads Commercial)

FEATURES:

- Currently used as modular home sales yard
- Large fenced/compacted gravel yard
- Well water and septic
- Flexible zoning allows for numerous uses such as modular home sales, trailer sales, equipment sales, etc.
- Adjacent property currently in process of opening convenience store
- Planned traffic signal for Liberty Road / Hwy 88
- Traffic Count: 10,700 Cars ADT (Hwy 88/Liberty Rd.)

SALE PRICE: \$549,000



Jim Martin, SIOR
BRE #01214270
jmartin@lee-associates.com
D 209.983.4088
C 925.352.6948

All information furnished regarding property for sale, rental or financing is from sources deemed reliable, but no warranty or representation is made to the accuracy thereof and same is submitted to errors, omissions, change of price, rental or other conditions prior to sale, lease or financing or withdrawal without notice. No liability of any kind is to be imposed on the broker herein.

2,000± SF SHOP ON 2.53± AC FOR SALE

22024 E. LIBERTY ROAD, CLEMENTS, CA

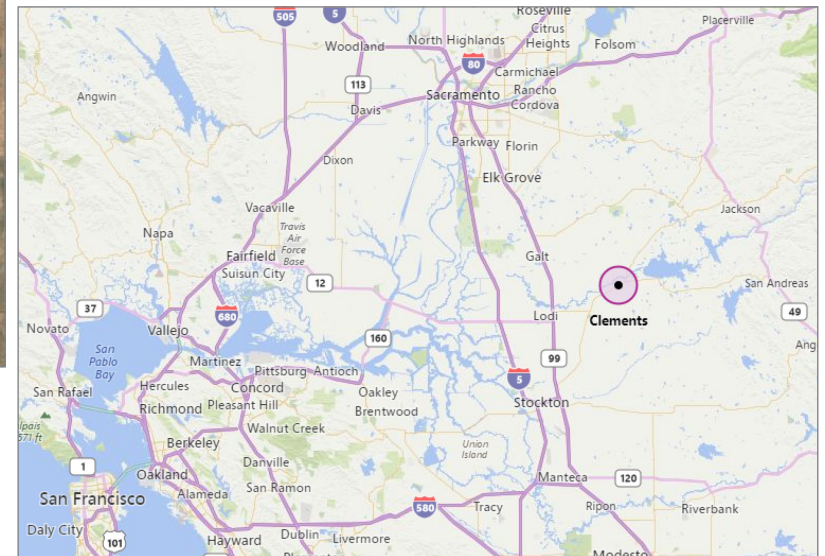
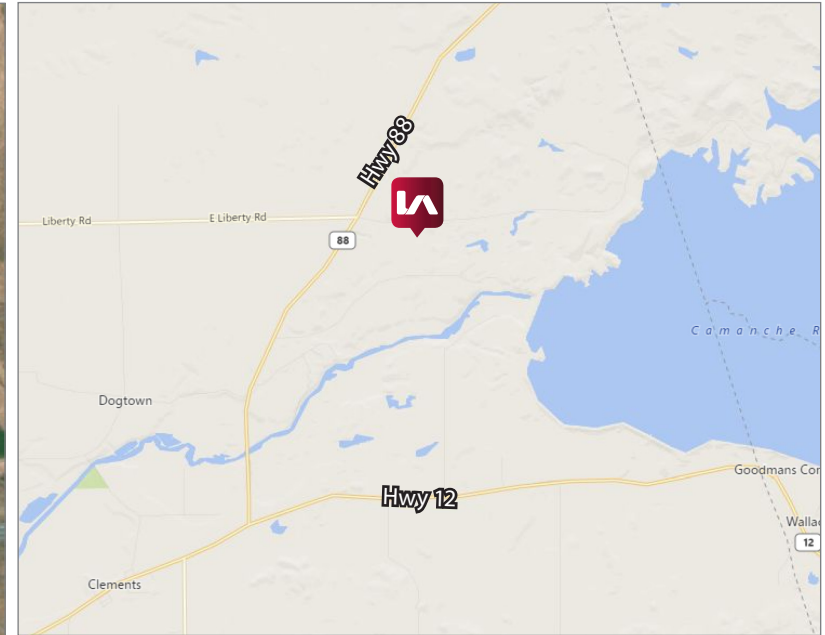

Jim Martin, SIOR
BRE #01214270
jmartin@lee-associates.com
D 209.983.4088
C 925.352.6948

All information furnished regarding property for sale, rental or financing is from sources deemed reliable, but no warranty or representation is made to the accuracy thereof and same is submitted to errors, omissions, change of price, rental or other conditions prior to sale, lease or financing or withdrawal without notice. No liability of any kind is to be imposed on the broker herein.