



## PROPERTY HIGHLIGHTS

- Available: ±1,050 SF (previous Metro PCS)
- ±9,800 SF Retail Strip Center
- **Lease Rate: \$1.05/SF; NNN**
- Taxes, Insurance & CAM: ±\$0.39/SF
- Building and monument signage facing Auburn Blvd. North and South

## LOCATION OVERVIEW

Located on the NEC of Auburn Blvd. (±36,418 ADT) at Linden approximately 100 yards South of the Placer County line and the Riverside exit off I-80 (±175,000 ADT). This is the first exit into Roseville with a full interchange.

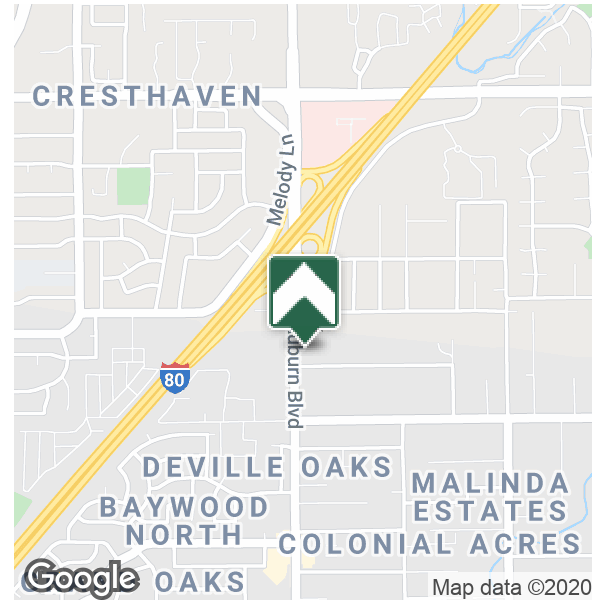

FOR LEASE

8500 Auburn Blvd. Citrus Heights, CA 95610

Linden Plaza Shopping Center



**BRENDA MILLER, VP**  
CALDRE #01159058  
Tel: 916.677.8154  
brenda.miller@tricommercial.com

# 8500 Auburn Blvd., Citrus Heights, CA 95610

## SITE PLAN & PHOTOS

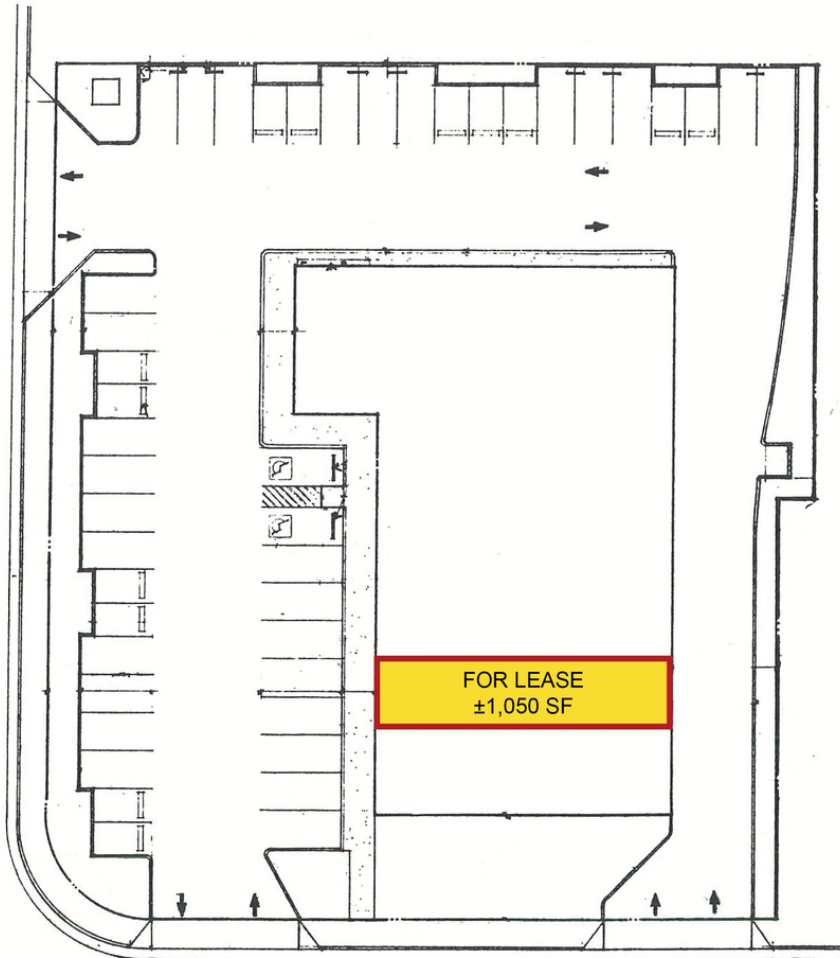

The information in this document was obtained from sources we deem reliable; however, no warranty or representation, expressed or implied, is made as to the accuracy of the information contained herein.



# 8500 Auburn Blvd., Citrus Heights, CA 95610

## LOCATION MAP

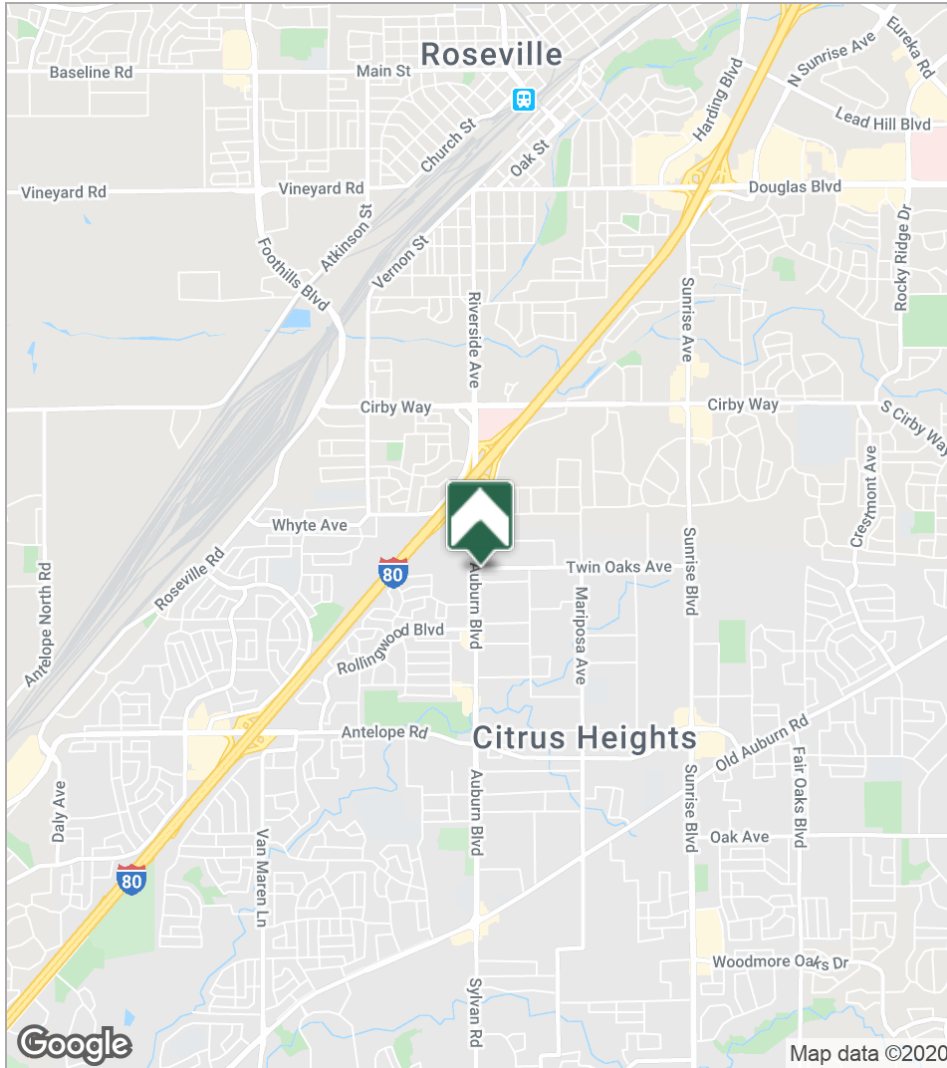

Across the Street: Smart & Final, Gold's Gym, Wells Fargo, Jack in the Box & Big Lots (coming soon)



The information in this document was obtained from sources we deem reliable; however, no warranty or representation, expressed or implied, is made as to the accuracy of the information contained herein.

# 8500 Auburn Blvd., Citrus Heights, CA 95610

## DEMOGRAPHICS MAP

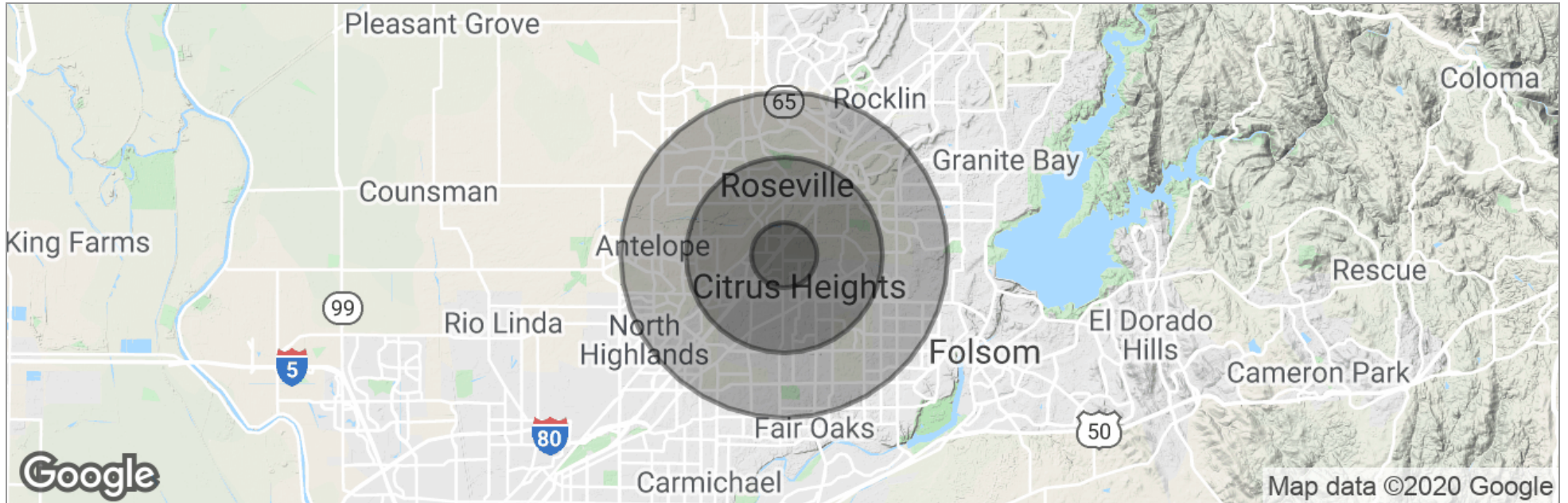

	1 Mile	3 Miles	5 Miles
Total Population	15,633	128,023	332,153
Population Density	4,976	4,528	4,229
Median Age	34.6	36.7	36.6
Median Age (Male)	33.1	34.4	35.0
Median Age (Female)	37.0	39.2	38.5
Total Households	6,085	49,813	127,264
# of Persons Per HH	2.6	2.6	2.6
Average HH Income	\$65,085	\$68,292	\$74,813
Average House Value	\$315,950	\$307,125	\$347,176

\* Demographic data derived from 2010 US Census

The information in this document was obtained from sources we deem reliable; however, no warranty or representation, expressed or implied, is made as to the accuracy of the information contained herein.