

# Publix #1564 - Sky Walk

13121 Paul J. Doherty Parkway  
Fort Myers, FL 33913  
Lat 26.556, Long -81.750

FULLY LEASED



## PROPERTY HIGHLIGHTS

- New Construction Publix-Anchored Shopping Center Opened in 2017
- Primary Shopping Destination in the Growing Gateway Suburban Community
- Prominent Location on Interstate-75 Exit Daniels Parkway
- Less than One Mile Away from Southwest Florida International Airport, which Serves and Employs Thousands Daily
- Combined Traffic Count: 29,350 VPD

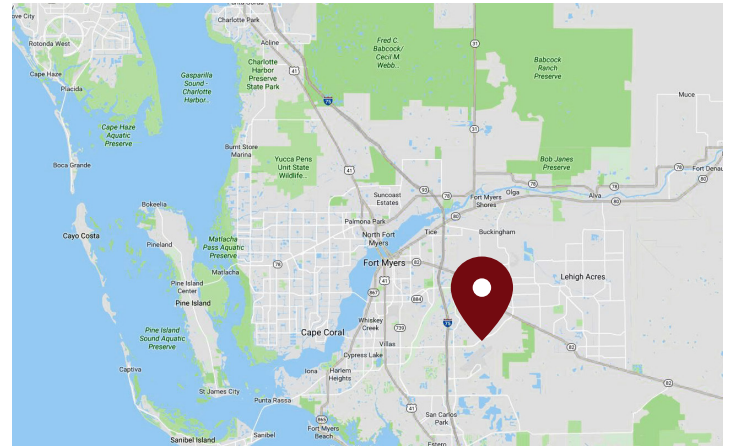

DEMOGRAPHICS	1 Mile	3 Miles	5 Miles
Total Population	74	16,636	54,583
Daytime Population	1,612	16,391	53,023
Total Households	36	5,468	20,971
Avg. HH Income	\$142,729	\$123,858	\$101,647

Data provided by Placer Labs Inc. ([www.placer.ai](http://www.placer.ai)) & Esri

## Fernando Espino

Office: 305.342.4629 | Cell: 305.632.1809 | [fespino@crossmanco.com](mailto:fespino@crossmanco.com)  
2655 South Le Jeune Road, Suite 908, Miami, FL

Licensed Real Estate Broker. No warranty expressed or implied has been made to the accuracy of the information provided herein, no liability assumed for error or omission.



[www.crossmanco.com](http://www.crossmanco.com)

# Publix #1564 - Sky Walk

13121 Paul J. Doherty Parkway  
 Fort Myers, FL 33913  
 Lat 26.556, Long -81.750

## SITE PLAN

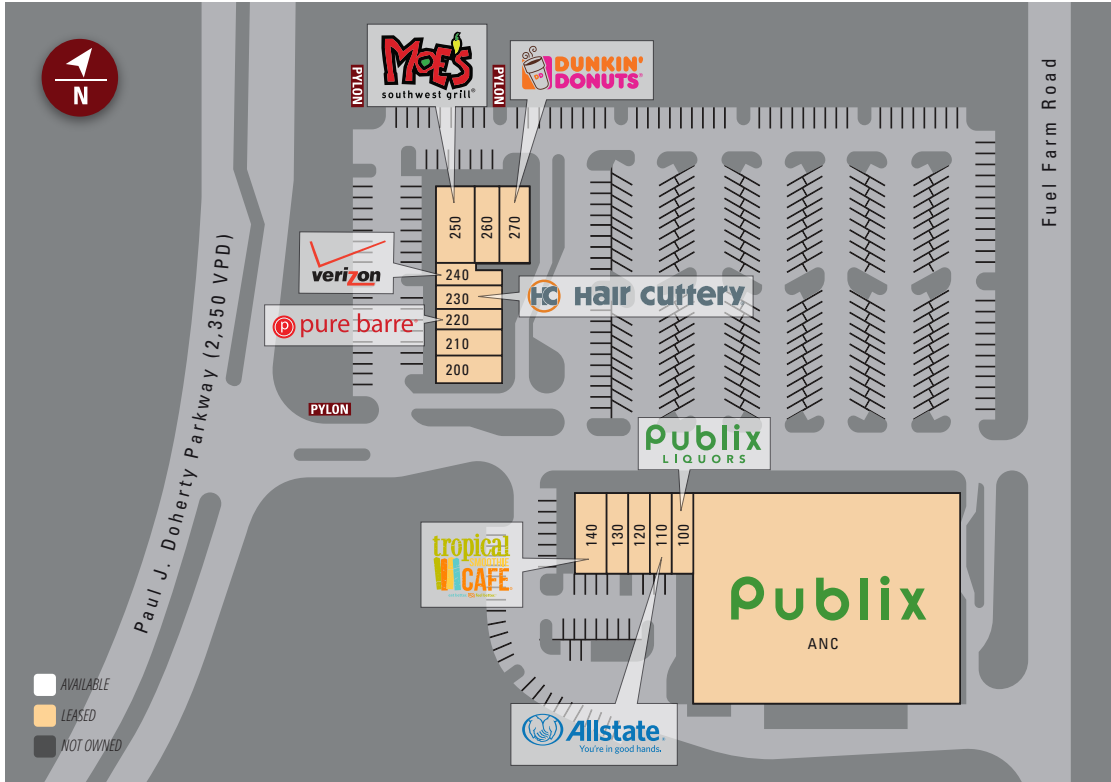

Suite	Tenant	Size
ANC	Publix	45,600
100	Publix Liquor	1,400
110	Allstate	1,400
120	Fashion Fresh Dry Cleaners	1,400
130	China Fusion	1,400
140	Tropical Smoothie Cafe	2,100
200	Nail Lounge	1,800
210	SOS Chiropractic	1,200
220	Pure Barre	1,200
230	Hair Cuttery	1,200
240	Verizon	1,000
250	Moe's	2,450
260	Hot Gyros & More	1,400
270	Dunkin Donuts	2,148

TOTAL 65,698



### Fernando Espino

Office: 305.342.4629 | Cell: 305.632.1809 | [fespino@crossmanco.com](mailto:fespino@crossmanco.com)  
 2655 South Le Jeune Road, Suite 908, Miami, FL

*Licensed Real Estate Broker. No warranty expressed or implied has been made to the accuracy of the information provided herein, no liability assumed for error or omission.*



Crossman & Company

[www.crossmanco.com](http://www.crossmanco.com)

# Publix #1564 - Sky Walk

13121 Paul J. Doherty Parkway  
Fort Myers, FL 33913  
Lat 26.556, Long -81.750

## FOOT TRAFFIC OVERVIEW

EST. # OF CUSTOMERS ANNUALLY



EST. # OF VISITS ANNUALLY



AVG. VISITS / CUSTOMER



AVG. LENGTH-OF-STAY / VISIT



TOP 3 DAYS



Sunday	127,554
Saturday	126,700
Friday	118,404

# OF VISITS

TOP 3 HOURS



5-6 PM	147,484
4-5 PM	144,085
3-4 PM	135,853

# OF VISITS

Data provided by Placer Labs Inc. ([www.placer.ai](http://www.placer.ai)) Jan 1, 2020 - Dec 31, 2020

## SITE VISIT DENSITY

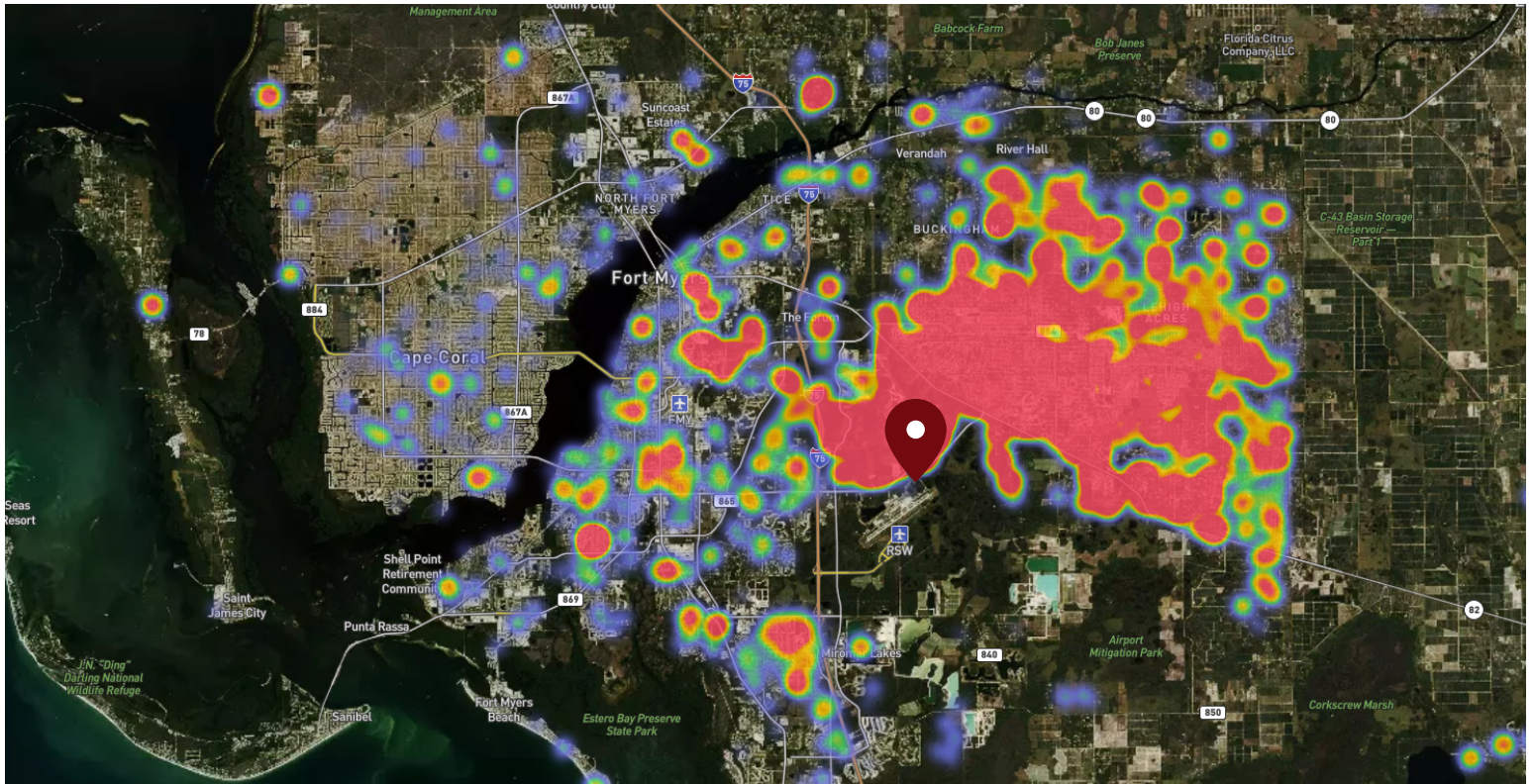

Red, orange, and yellow colors represent the location of 60% of site visitors

Data provided by Placer Labs Inc. ([www.placer.ai](http://www.placer.ai))

### Fernando Espino

Office: 305.342.4629 | Cell: 305.632.1809 | [fespino@crossmanco.com](mailto:fespino@crossmanco.com)  
2655 South Le Jeune Road, Suite 908, Miami, FL

Licensed Real Estate Broker. No warranty expressed or implied has been made to the accuracy of the information provided herein, no liability assumed for error or omission.



[www.crossmanco.com](http://www.crossmanco.com)