

Weiss Building

19405 68th Drive
Arlington, WA 98223

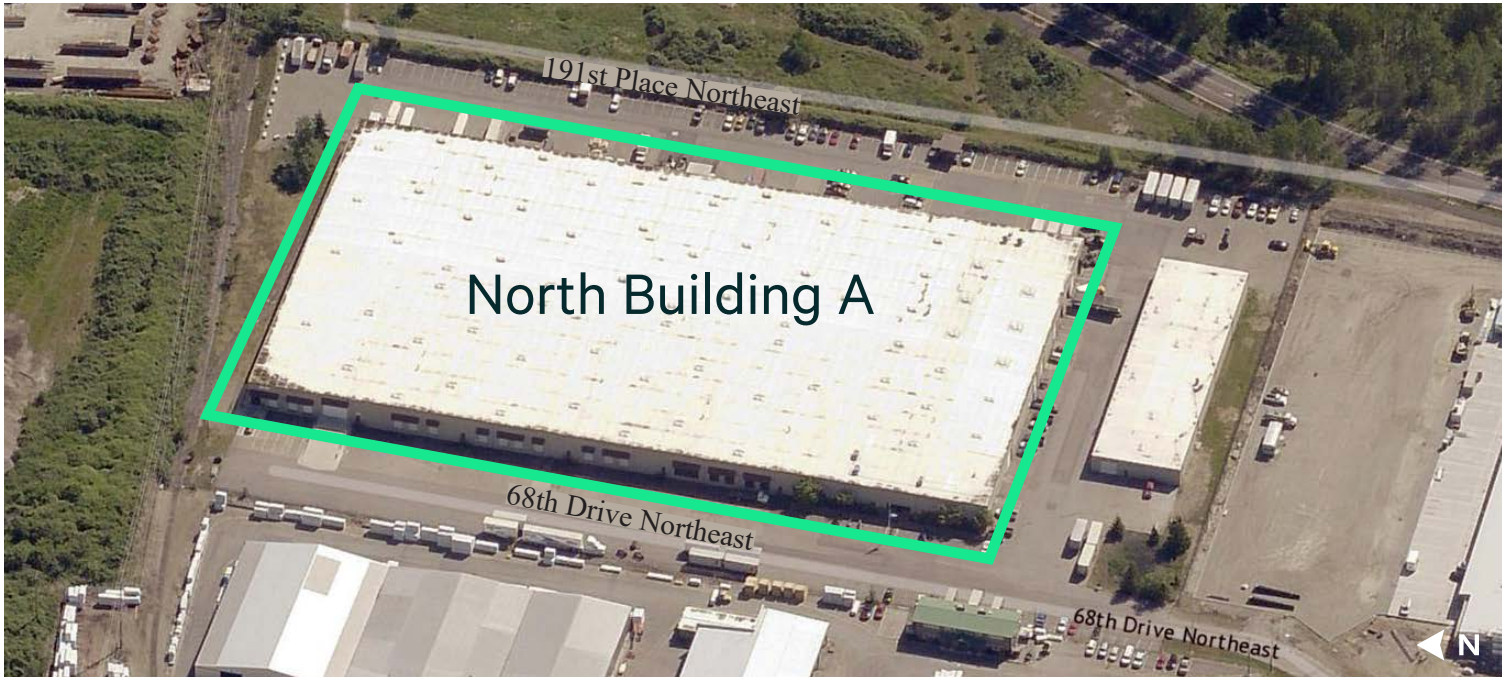

 eagleview

Property Features

- + Lease Rate: Please contact broker
- + Close proximity to numerous retail amenities
- + Ample parking
- + Convenient access to I-5 and Washington State Route 9
- + 23 miles/27 minutes drive time to Everett/Boeing plant

Building Details

- + Quality concrete tilt up completed in 1989
- + 22'-26' clear height
- + 24' x 48' column spacing
- + 277/480 3-phase power
- + Upgraded LED lighting
- + High-density sprinkler system
- + Many docks have awnings

North Building A

- + ±63,948 SF Available (divisible to 18,000 SF)
 - 7 dock door on west side
 - 2 dock doors on east side
 - Office—Built to Suit



Weiss Building

19405 68th Drive | Arlington, WA 98223

For Lease

North Building A

Space Plan

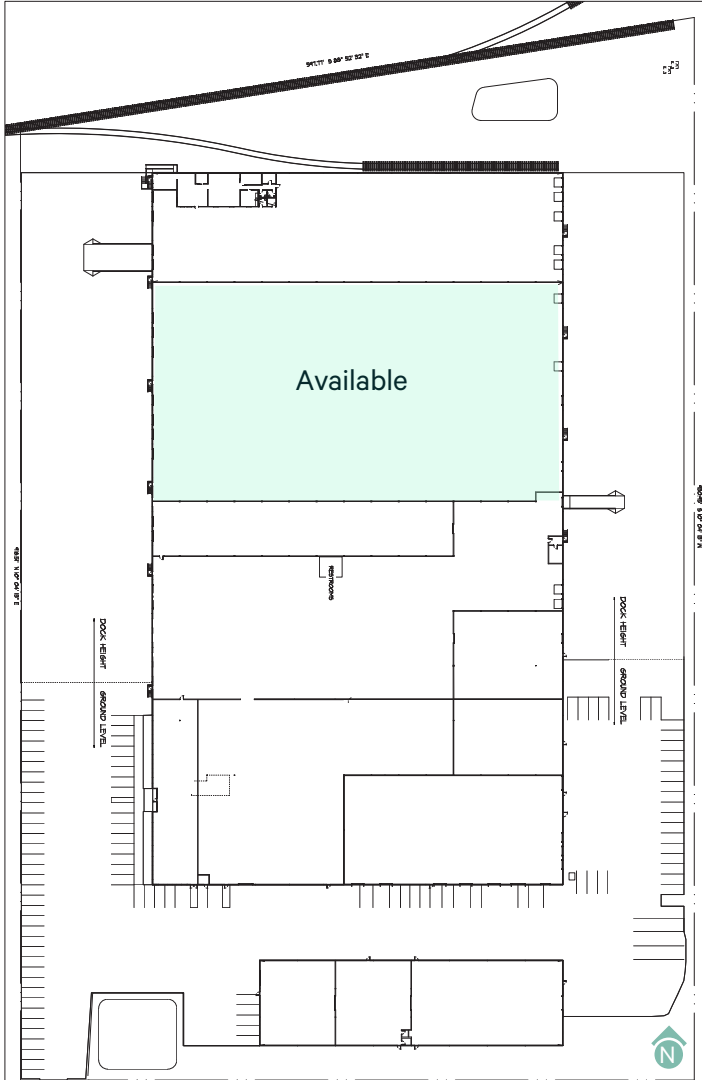

Contact Us

Lane Bockman

Senior Vice President

+1 425 462 6904

lane.bockman@cbre.com

CBRE, Inc.

929 108th Ave NE

Suite 700

Bellevue, WA 98004f

Jon Bockman

Lee and Associates

+1 425 417 5391

jbockman@lee-associates.com

© 2021 CBRE, Inc. All rights reserved. This information has been obtained from sources believed reliable, but has not been verified for accuracy or completeness. You should conduct a careful, independent investigation of the property and verify all information. Any reliance on this information is solely at your own risk. CBRE and the CBRE logo are service marks of CBRE, Inc. All other marks displayed on this document are the property of their respective owners, and the use of such logos does not imply any affiliation with or endorsement of CBRE. Photos herein are the property of their respective owners. Use of these images without the express written consent of the owner is prohibited.jg 9-30-21