



FOR LEASE

TURN-KEY RESTAURANT FOR LEASE IN RAMADA HOTEL

1901-03 W. OLYMPIC BOULEVARD | LOS ANGELES, CA 90006

JASON EHRENPREIS

CA REAL ESTATE LIC #01741961

310.231.5213

JASON@CBM1.COM

1517 S. SEPULVEDA BLVD. | LOS ANGELES, CA 90025

CBM1.COM



TURN-KEY RESTAURANT FOR LEASE IN RAMADA HOTEL

1901-03 W. OLYMPIC BOULEVARD | LOS ANGELES, CA 90006



FEATURES + AMENITIES

- APPROX. 7,500 SQFT FIXTURIZED RESTAURANT AVAILABLE
- FULLY EQUIPPED - NO KEY MONEY!
- INSIDE RAMADA HOTEL WITH HIGH OCCUPANCY RATES/BUILT-IN CUSTOMER BASE
- MUST SERVE BREAKFAST, LUNCH + DINNER
- ENORMOUS BUILDING-TOP MARQUEE SIGNAGE
- ADJACENT TO DTLA, CLOSE TO LA COVENTION CENTER, STAPLES CENTER AND LA LIVE
- RIGHT OFF THE 110 FREEWAY
- COUNTLESS NATIONAL RETAILERS IN THE IMMEDIATE VICINITY

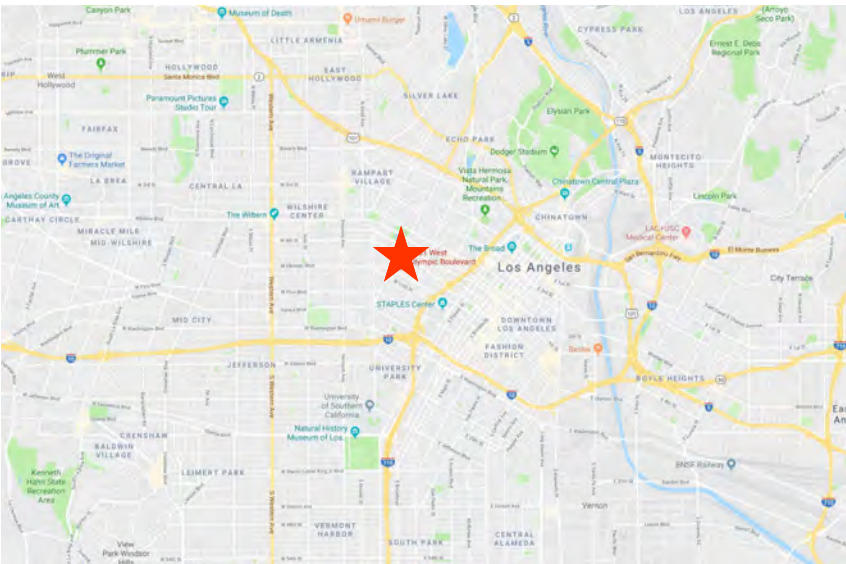

DEMOGRAPHICS SNAPSHOT	1-MILE	3-MILE	5-MILE
POPULATION	115,356	619,001	1,301,48
AVG HH INCOME	\$44,172	\$57,576	\$65,830

NEIGHBORING RETAILERS



EXCLUSIVELY REPRESENTED BY
JASON EHRENPREIS
CA REAL ESTATE LIC #01741961
310.231.5213

FLOOR PLAN

1901-03 W. OLYMPIC BOULEVARD | LOS ANGELES, CA 90006

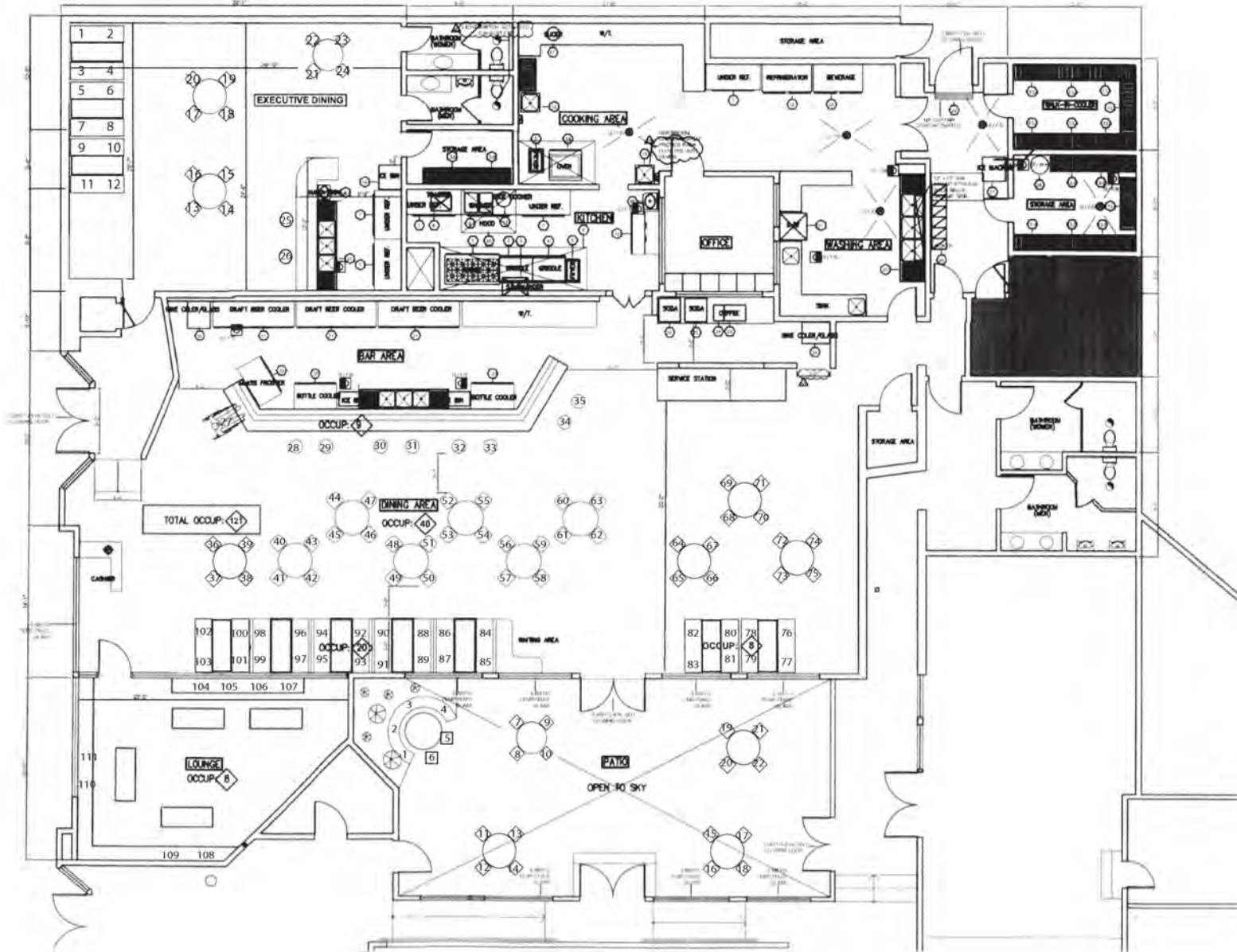

AERIAL PHOTO

1901-03 W. OLYMPIC BOULEVARD | LOS ANGELES, CA 90006



DEMOGRAPHICS

1901-03 W. OLYMPIC BOULEVARD | LOS ANGELES, CA 90006

	1 mile(s)	3 mile(s)	5 mile(s)
Population: 2018A			
Total Population	115,356	619,001	1,301,489
Female Population	46.43%	47.77%	49.10%
Male Population	53.57%	52.23%	50.90%
Population Density	36,713	21,889	16,569
Population Median Age	31.9	33.7	33.9
Employed Civilian Population 16+	54,009	291,461	606,034
% White Collar	30.4%	45.2%	48.3%
% Blue Collar	69.6%	54.8%	51.7%
Total Q1 2019 Employees	63,877	384,641	620,926
Total Q1 2019 Establishments*	5,405	34,512	58,112
Population Growth 2000-2010	1.02%	-0.58%	-0.37%
Population Growth 2018A-2023	1.86%	1.22%	0.34%
Income: 2018A			
Average Household Income	\$44,172	\$57,576	\$65,830
Median Household Income	\$27,246	\$34,898	\$39,749
Per Capita Income	\$15,325	\$21,210	\$23,465
Avg Income Growth 2000-2010	32.49%	39.11%	38.82%
Avg Income Growth 2018A-2023	18.61%	18.11%	17.17%
Households: 2018A			
Households	39,180	217,679	452,058
Average Household Size	2.89	2.68	2.77
Hhld Growth 2000-2010	9.57%	7.32%	4.37%
Hhld Growth 2018A-2023	4.77%	4.31%	2.92%
Housing Units: 2018A			
Occupied Units	39,180	217,679	452,058
% Occupied Units	93.81%	94.89%	95.50%
% Vacant Housing Units	6.19%	5.11%	4.50%
Owner Occ Housing Growth 2000-2010	16.73%	9.36%	3.34%
Owner Occ Housing Growth 2000-2023	23.03%	14.13%	5.91%
Owner Occ Housing Growth 2018A-2023	4.87%	3.03%	1.50%
Occ Housing Growth 2000-2010	9.57%	7.32%	4.37%
Occ Housing Growth 2010-2023	11.43%	11.87%	9.48%
Occ Housing Growth 2018A-2023	4.77%	4.31%	2.92%
Race and Ethnicity: 2018A			
% American Indian or Alaska Native Population	1.52%	0.99%	0.91%
% Asian Population	14.45%	22.57%	14.98%
% Black Population	4.13%	8.51%	11.75%
% Hawaiian or Pacific Islander Population	0.14%	0.11%	0.10%
% Multirace Population	5.64%	4.86%	4.74%
% Other Race Population	42.84%	30.96%	30.83%
% White Population	31.29%	32.00%	36.70%
% Hispanic Population	77.15%	58.56%	58.90%
% Non Hispanic Population	22.85%	41.44%	41.10%

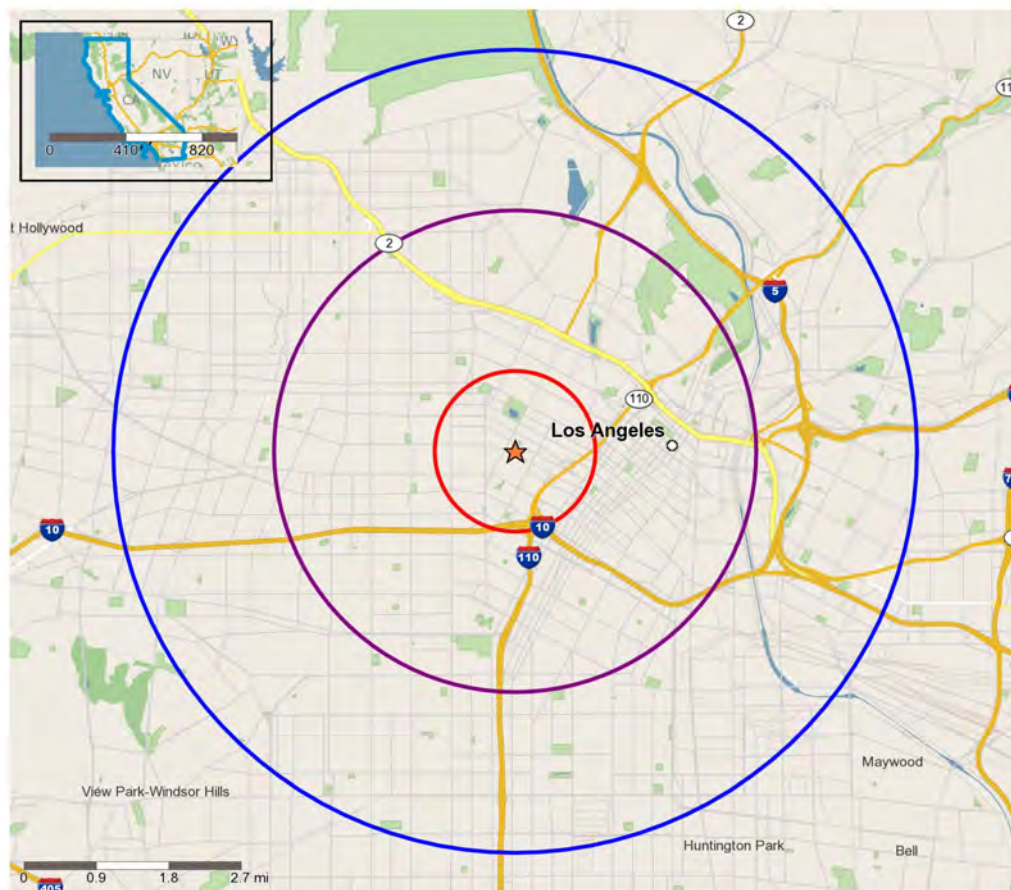

Copyright 2006-2018 TomTom. All rights reserved. This material is proprietary and the subject of copyright protection, database right protection and other intellectual property rights owned by TomTom and its suppliers. The use of this material is subject to the terms of a license agreement. Any unauthorized copying or disclosure of this material will lead to criminal and civil liabilities.

- Trade Areas (in miles) - 1
- Trade Areas (in miles) - 3
- Trade Areas (in miles) - 5