

Rare Office Space for Lease

1779 Woodside Road, Redwood City



±717 Square Feet Available

As exclusive agents, we are pleased to offer the following space:



- ◆ Open Office with One Private Office, Private Deck and Kitchenette
- ◆ Ideal for Start-Ups
- ◆ Great Location with Convenient Access to Alameda de las Pulgas and Highway 280
- ◆ Walking Distance to Woodside Plaza Amenities

Wes Payne Associate 650.358.5275 wpayne@ngkf.com CA RE License #02054621

Josh Rowell Executive Vice President 650.358.5261 jrowell@ngkf.com CA RE License #01236434



2950 South Delaware Street, Suite 125, San Mateo, CA 94403

www.ngkf.com

The distributor of this communication is performing acts for which a real estate license is required. The information contained herein has been obtained from sources deemed reliable but has not been verified and no guarantee, warranty or representation, either express or implied, is made with respect to such information. Terms of sale or lease and availability are subject to change or withdrawal without notice.

16-0040-06/19

Rare Office Space for Lease

1779 Woodside Road, Redwood City



Wes Payne Associate 650.358.5275 wpayne@ngkf.com CA RE License #02054621

Josh Rowell Executive Vice President 650.358.5261 jrowell@ngkf.com CA RE License #01236434



2950 South Delaware Street, Suite 125, San Mateo, CA 94403

www.ngkf.com

The distributor of this communication is performing acts for which a real estate license is required. The information contained herein has been obtained from sources deemed reliable but has not been verified and no guarantee, warranty or representation, either express or implied, is made with respect to such information. Terms of sale or lease and availability are subject to change or withdrawal without notice.

16-0040-06/19

Rare Office Space for Lease

1779 Woodside Road, Redwood City

Floor Plan

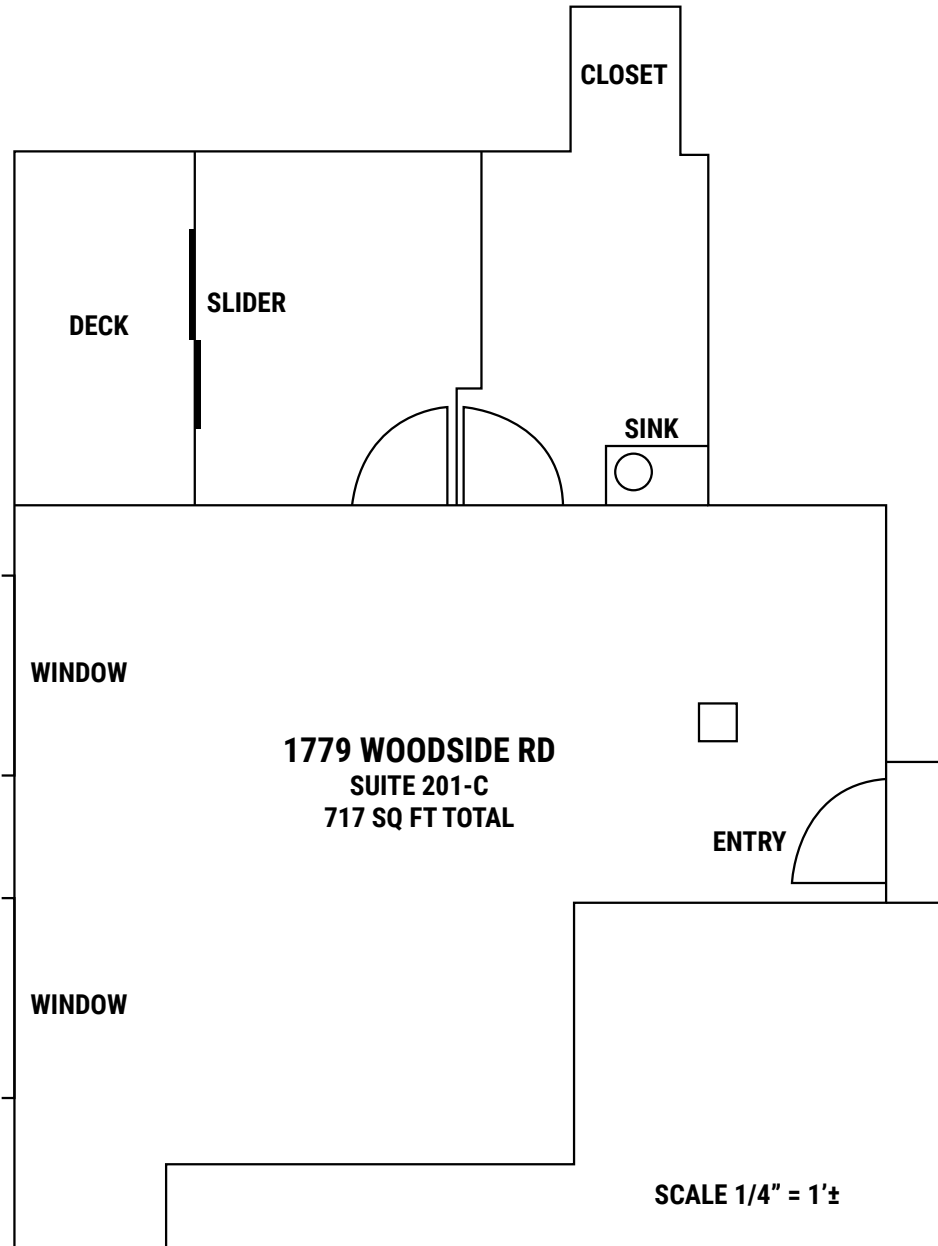

Wes Payne Associate 650.358.5275 wpayne@ngkf.com CA RE License #02054621

Josh Rowell Executive Vice President 650.358.5261 jrowell@ngkf.com CA RE License #01236434



2950 South Delaware Street, Suite 125, San Mateo, CA 94403

www.ngkf.com