

# ERSI

ESSENCE  
REAL ESTATE  
SERVICES INC.

COMMERCIAL REAL ESTATE SINCE 1990

# SUB-LEASE



## STONY LAKE

2475 - 15TH STREET NW • NEW BRIGHTON, MN 55112

- 914 SF AVAILABLE
- SUB-LEASE THROUGH NOV. 2026
- IDEAL FOR PROFESSIONAL OFFICE, MEDICAL OR SERVICE
- MULTI-TENANT CAMPUS SETTING
- EXTENSIVE LANDSCAPING
- TERRIFIC ACCESS TO I-694 & I-35W
- MANY AREA AMENITIES INCLUDE: MN HEALTH CLINIC, WELLS FARGO, GROCERY, SUBWAY, LA FITNESS, COWBOY JACKS & MORE

## CONTACT:

[WWW.ESSENCEREALESTATE.COM](http://WWW.ESSENCEREALESTATE.COM)

JEFF NORDNESS

[jeff@essencerealestate.com](mailto:jeff@essencerealestate.com)

651-341-5044



# STONY LAKE

2475 - 15TH STREET NW • NEW BRIGHTON, MN 55112

## BUILDING DETAILS:

OFFICE NET RENT: \$14.81 SF  
2023 EST. OP. EXP. \$ 9.65 SF

SPACE AVAILABLE:  
SUITE C 914 SF

**APPROX. \$1,863  
A MONTH**

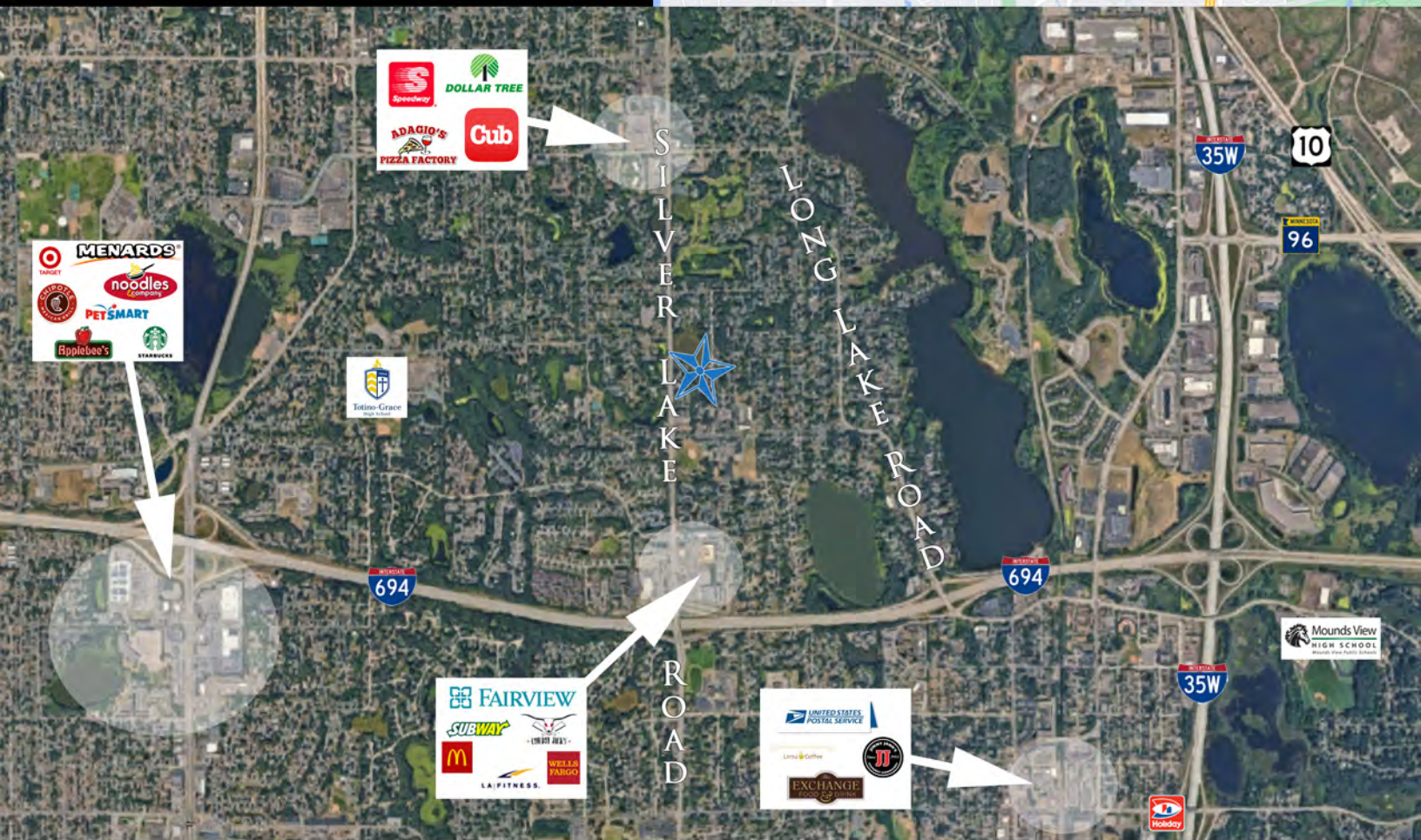
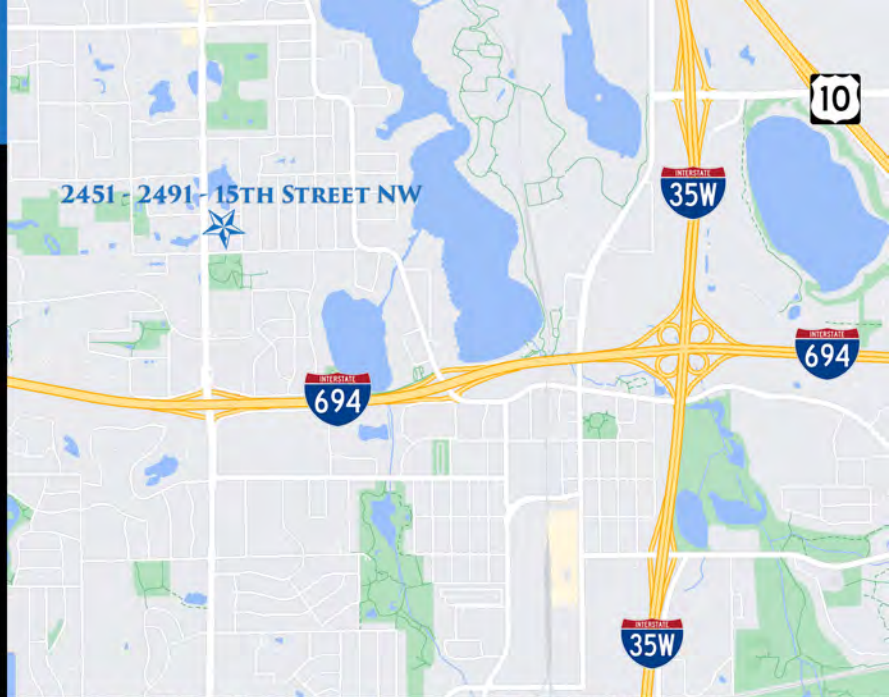

**EXCELLENT ACCESS TO 694 OFF SILVER LAKE ROAD**

**ERSI**  
COMMERCIAL REAL ESTATE SINCE 1990

ESSENCE  
REAL ESTATE  
SERVICES INC.

JEFF NORDNESS  
651-341-5044  
jeff@essencerealestate.com

OFFICE: 651-482-1871



# STONY LAKE OFFICE PARK

2475 - 15TH STREET NW • NEW BRIGHTON, MN 55112

SUITE C  
914 SF

APPROX.  
\$1,863.00  
A MONTH

**ERSI**

COMMERCIAL REAL ESTATE SINCE 1990

ESSENCE  
REAL ESTATE  
SERVICES INC.

JEFF NORDNESS

651-341-5044

[jeff@essencerealestate.com](mailto:jeff@essencerealestate.com)

OFFICE: 651-482-1871