

Sublease
Available!

Lincoln
Office
Center

365 Inverness Parkway

Englewood, CO 80112

Sublease Highlights

Available Space:	14,240 SF
Occupancy:	Immediate
Sublease Rate:	\$7.50 / RSF NNN
Term:	Through July 31, 2018
Parking:	4 / 1,000



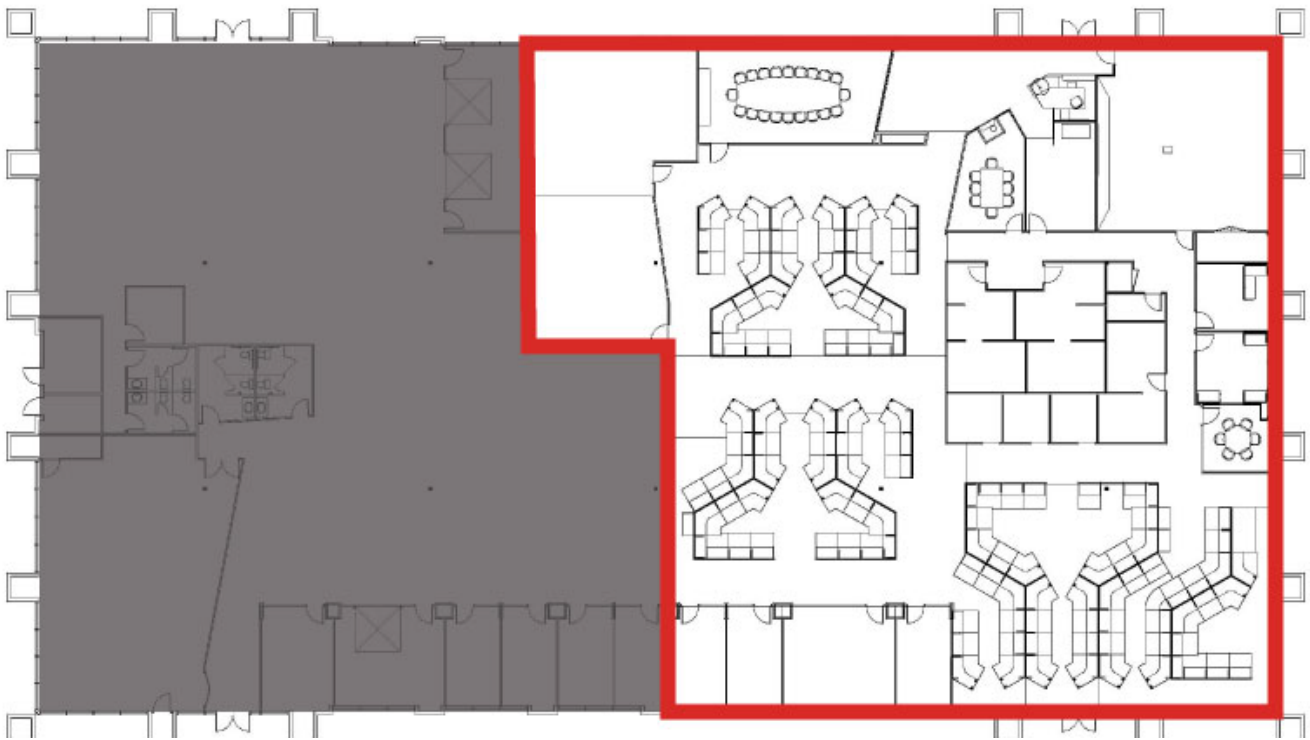

Building 365 – 14,240 RSF Available



Amenities

- Commuter rail
- Close to golf course
- Restaurants nearby
- Security system
- Signage

For more information, please contact:

Bill Byrne

+1 303 390 5201

bill.byrne@am.jll.com