

FOR SALE



±14,272 SF INDUSTRIAL/FLEX BUILDING FOR SALE IN SORRENTO MESA

6455

WEATHERS PLACE

Glen Volk Senior Vice President 619.540.1698 Lic. #00859621

Voit

REAL ESTATE SERVICES

6455

WEATHERS PLACE



PROPERTY FEATURES

- Industrial / Flex
- Freestanding Building
- Parcel Size Approximately 48,787 Square Feet
- Great Location - Just off Mira Mesa Blvd
- Terrific Corporate Image
- HVAC Office Approximately 3,500 Square Feet
- Abundant Glass
- Drive-around Access
- Sprinklered
- 7 Grade Level Doors
- Concrete Parking Lot
- Gated Yard Area
- Available August 2019
- Tenant Lease Expires 8/19.
They Will Consider Early Termination.

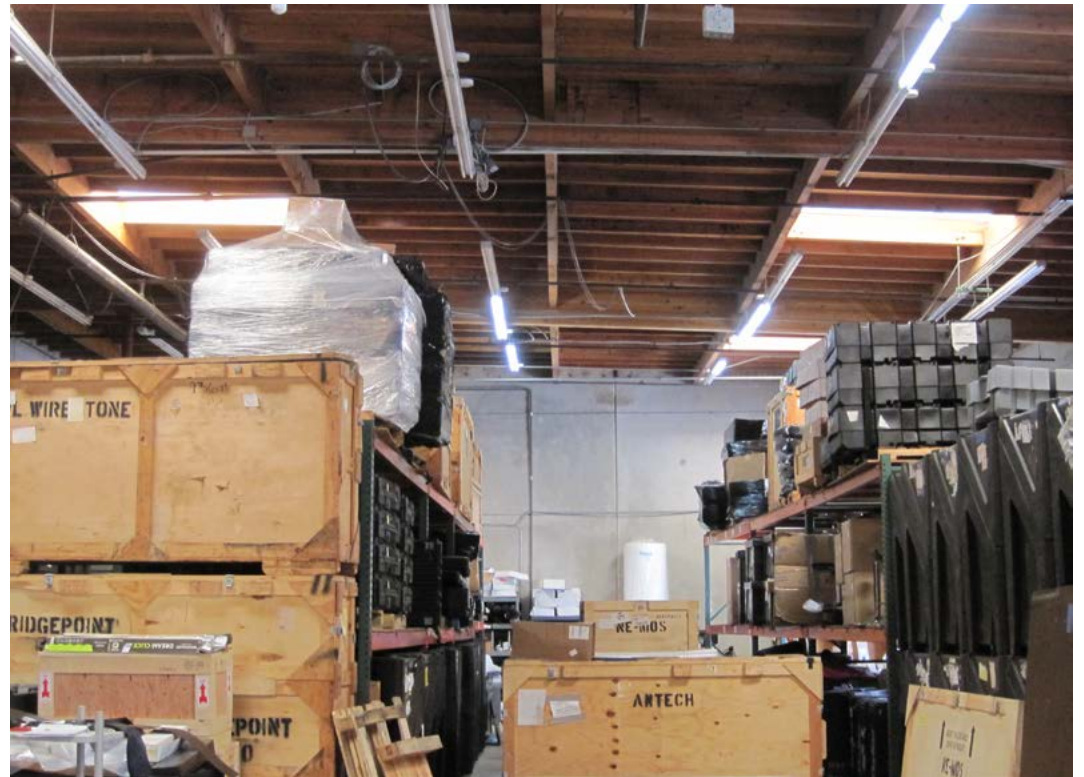

Please Call for an Appointment

SALE PRICE: \$3,550,000.00

6455

WEATHERS PLACE



FLOOR PLAN

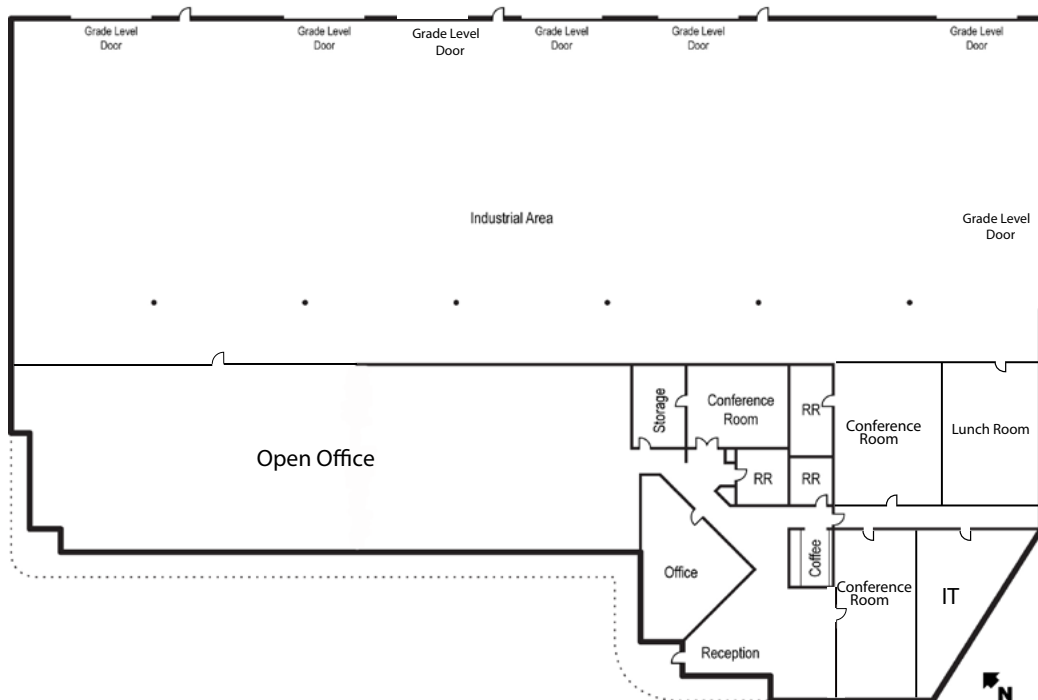

SITE PLAN



6455

WEATHERS PLACE



GLEN VOLK, Senior Vice President

619.540.1698 | Lic. #00859621

4180 La Jolla Village Drive, Suite 100, La Jolla, CA 92037 | 858.453.0505 | 858.408.3976 Fax | Lic #01991785 | www.voitco.com

Voit

REAL ESTATE SERVICES