

GRAND
CENTRAL

NEW YORK
NY

630 THIRD AVENUE



CONCEPTUAL RENDERING

SPACE DETAILS

LOCATION

Southwest corner of East 41st Street

APPROXIMATE SIZE

Ground Floor	2,700 SF
Basement	1,219 SF
Total	3,919 SF

CEILING HEIGHT

Ground Floor	15 FT
--------------	-------

TERM

Long term

POSSESSION

Immediate

FRONTAGE

50 FT on Third Avenue

SITE STATUS

Formerly a division of Duane Reade

NEIGHBORS

Pret A Manger, Starbucks, Shake Shack, Just Salad, HSBC, Zengo, Hendricks, Wagamama, New York Sports Clubs, Orangetheory Fitness, and Docks Oyster Bar & Seafood Grill

COMMENTS

Venting possible

All uses considered

Adjacent to the building lobby

At the base of a 23-story, 245,000-SF office tower

Steps from Grand Central Terminal

Ownership is in the process of a multi-million dollar lobby renovation, inclusive of a new façade and new retail storefronts

GROUND FLOOR

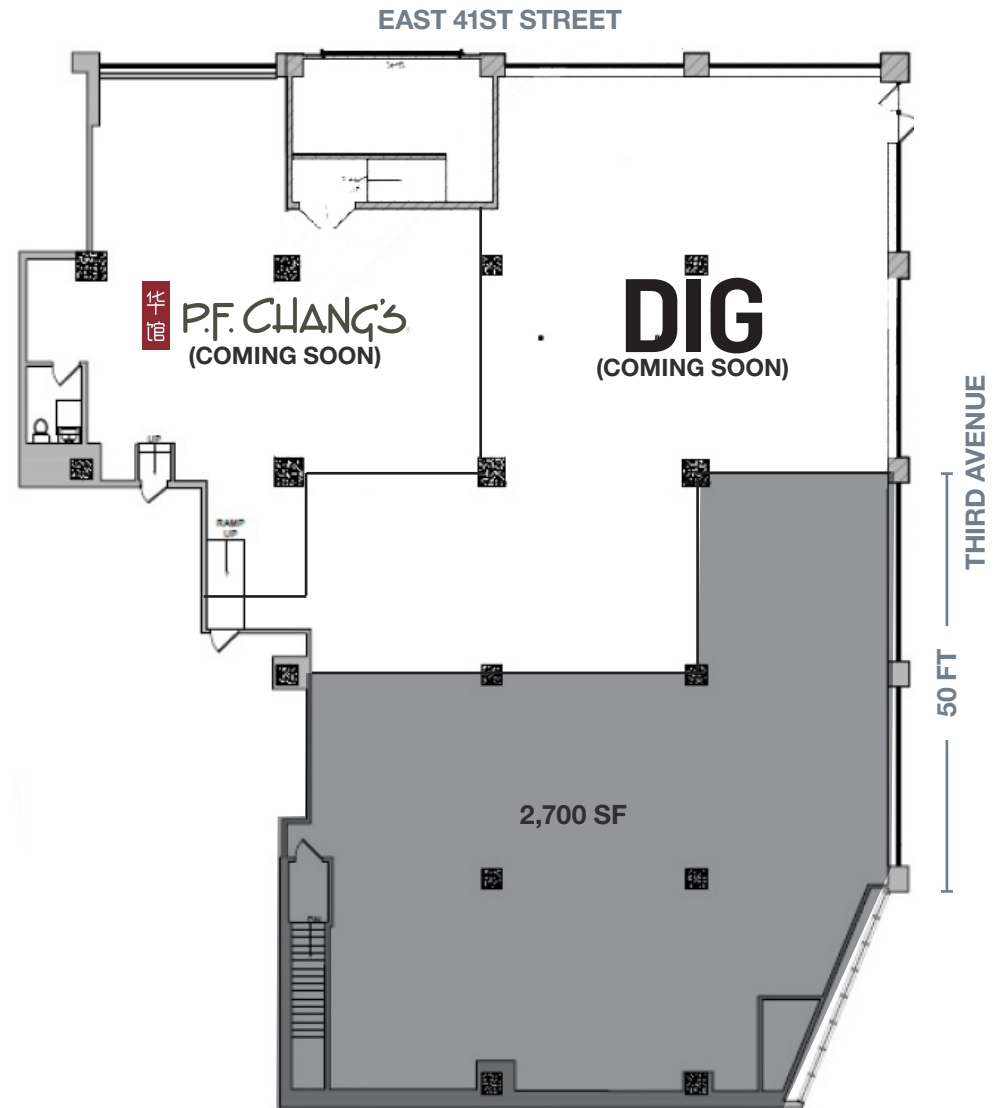

AREA DETAILS

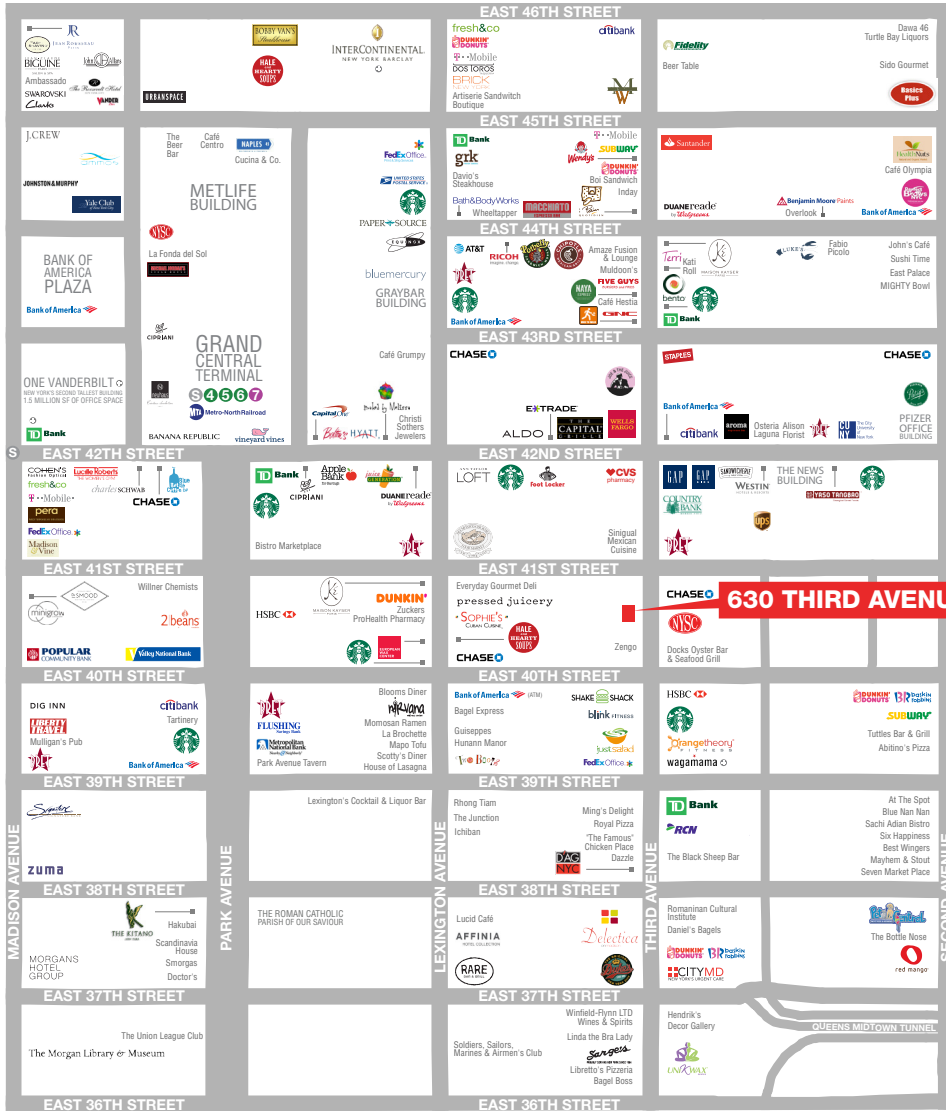

COMING SOON



313K

Estimated Daytime Population
Within a 1/2 Mile Radius



328K

Area Employees Within
a 1/2 Mile Radius

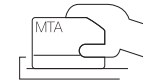

50.1M

Annual Subway Riders at
Grand Central Terminal

9.8M

Annual Subway Riders
at 33rd Street



21.6M

Annual Visitors
to Grand Central
Terminal

CONTACT EXCLUSIVE AGENTS

JEREMY EZRA

212.351.9351

jeremy.ezra@ngkf.com

MICHAEL PASTER

212.351.9345

michael.paster@ngkf.com

ARIEL SCHUSTER

212.331.0132

ariel.schuster@ngkf.com



NGKF.COM

© 2019 NEWMARK KNIGHT FRANK RETAIL. The information contained herein has been obtained from sources deemed reliable but has not been verified and no guarantee, warranty or representation, either express or implied, is made with respect to such information. Terms of sale or lease and availability are subject to change or withdrawal without notice.