



**COLDWELL  
BANKER  
COMMERCIAL**  
CORNERSTONE

## 545 BULTMAN DRIVE

Sumter, SC 29150

### AVAILABLE SPACE

3,000 SF

### LEASE RATE

\$3,750 per month (NNN)

### FEATURES

- Suite 1- \$1,000
- Suite 2- \$1,000
- Office 1- \$800
- Office 2- \$300
- Office 3- \$400

### AREA

Property located on Bultman Drive. Neighboring Central Carolina Technical College and Champion Williams



# FOR LEASE

CBCWORLDWIDE.COM

## OFFICE

Jay Davis

803.934.6597

[jdavis@cbccornerstone.com](mailto:jdavis@cbccornerstone.com)

Heather Tickel

803.778.1139

[htickel@cbccornerstone.com](mailto:htickel@cbccornerstone.com)

©2019 Coldwell Banker Real Estate LLC, dba Coldwell Banker Commercial Cornerstone. All rights reserved. Coldwell Banker Commercial® and the Coldwell Banker Commercial logo are registered service marks owned by Coldwell Banker Real Estate LLC. Coldwell Banker Real Estate LLC, dba Coldwell Banker Commercial Affiliates fully supports the principles of the Fair Housing Act and the Equal Opportunity Act. Each office is independently owned and operated. The information provided is deemed reliable, but it is not guaranteed to be accurate or complete, and it should not be relied upon as such. This information should be independently verified before any person enters into a transaction based upon it.

**COLDWELL BANKER COMMERCIAL  
CORNERSTONE**  
2 N. Main Street, Sumter, SC 29150  
803.778.1139



# 545 BULTMAN DRIVE

Sumter, SC 29150

LEASE

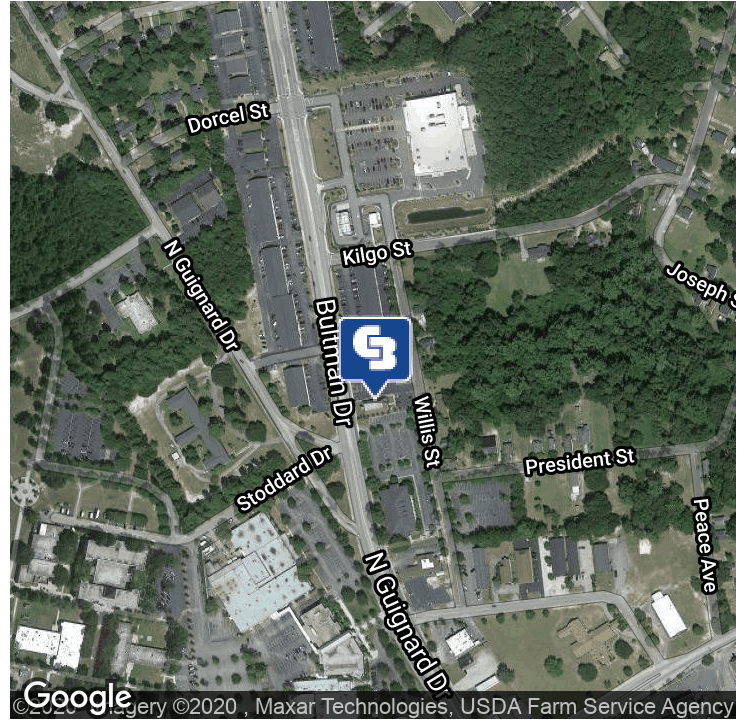
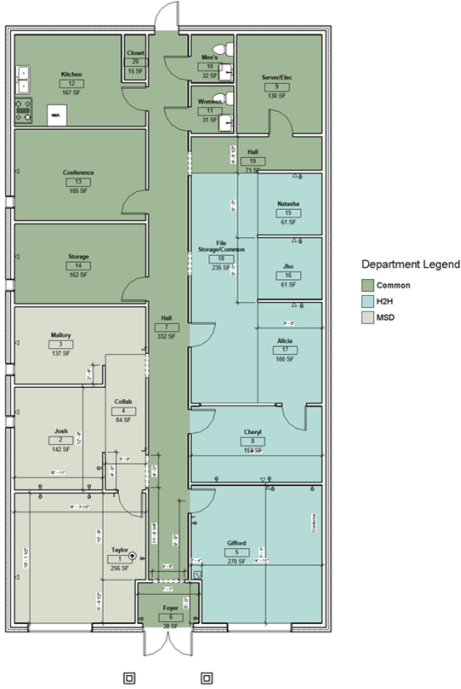

## OFFERING SUMMARY

Available SF: 3,000 SF

Lease Rate: \$3,750 per month (NNN)

Lot Size: 0.45 Acres

Building Size: 3,000 SF

## PROPERTY OVERVIEW

Great office space located on Bultman Drive in Sumter. Near Central Carolina Technical College, many shops, and restaurants. Ideal spot hosting between 16,300 and 24,200 in daily traffic count.

## PROPERTY HIGHLIGHTS

- Suite 1- \$1,000
- Suite 2- \$1,000
- Office 1- \$800
- Office 2- \$300
- Office 3- \$400

CBCWORLDWIDE.COM

Jay Davis  
803.934.6597  
jdavis@cbccornerstone.com

Heather Tickel  
803.778.1139  
htickel@cbccornerstone.com





# 545 BULTMAN DRIVE

Sumter, SC 29150

LEASE



CBCWORLDWIDE.COM

Jay Davis  
 803.934.6597  
 jdavis@cbccornerstone.com

Heather Tickle  
 803.778.1139  
 htickle@cbccornerstone.com





# 545 BULTMAN DRIVE

Sumter, SC 29150

LEASE

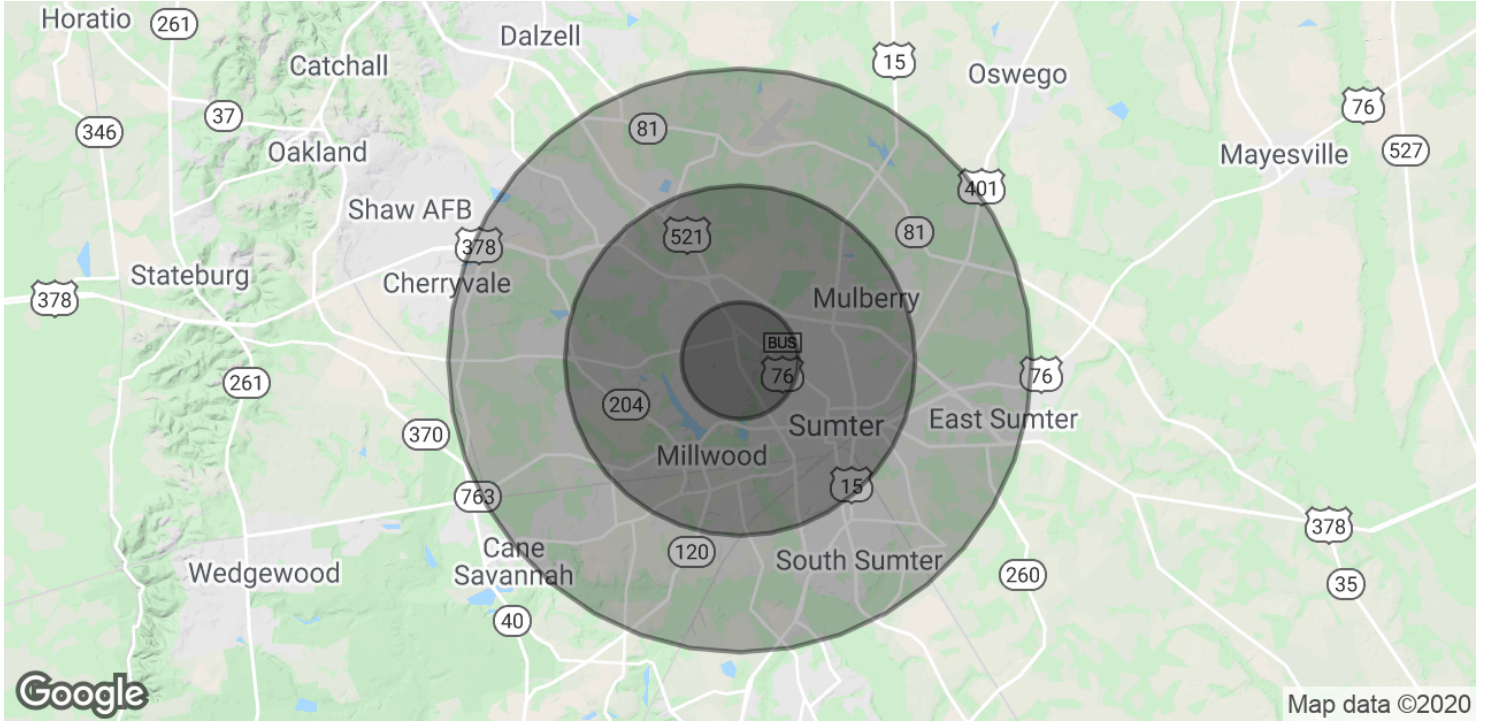

POPULATION	1 MILE	3 MILES	5 MILES
Total Population	5,540	34,675	59,588
Median age	38.8	37.1	36.9
Median age (Male)	35.0	33.4	34.1
Median age (Female)	42.3	39.3	38.7
HOUSEHOLDS & INCOME	1 MILE	3 MILES	5 MILES
Total households	2,309	13,273	22,263
# of persons per HH	2.4	2.6	2.7
Average HH income	\$52,743	\$51,671	\$51,965
Average house value	\$70,196	\$137,788	\$148,674

\* Demographic data derived from 2010 US Census

CBCWORLDWIDE.COM

Jay Davis  
 803.934.6597  
 jdavis@cbccornerstone.com

Heather Tickle  
 803.778.1139  
 htickle@cbccornerstone.com

