



Outparcels, New Inline Space Available Spring 2020

For more information, contact:

**DAVID CRAWFORD**

Vice President  
804 697 3446  
david.crawford@thalhimer.com

**RICHARD THALHIMER**

Senior Vice President  
804 697 3416  
richard.thalhimer@thalhimer.com

Thalhimer Center  
11100 W. Broad Street  
Glen Allen, VA 23060  
www.thalhimer.com

**Property Features**

- PUBLIX UNDER CONSTRUCTION
- 4 RETAIL PADS AVAILABLE
- 2 SPACES REMAIN – 1,120 SF & 1,785 SF
- Fronting Midlothian Turnpike & Charter Colony Parkway
- Signalized intersection with good visibility
- 1 mile from Route 288
- 35,000 VPD - Midlothian Turnpike
- 1 Mile Radius Est. Household Income – Over \$120K
- Parking: 370 spaces (5.03/1,000)



**Join Tenants**



**Demographics**

	1 Mile	3 Miles	5 Miles
Population	4,332	38,720	91,606
Avg. HH Income	\$109,922	\$137,225	\$122,901
Daytime Population	3,544	19,467	43,048

For more information, contact:

**DAVID CRAWFORD**

Vice President  
804 697 3446  
david.crawford@thalhimer.com

**RICHARD THALHIMER**

Senior Vice President  
804 697 3416  
richard.thalhimer@thalhimer.com

Thalhimer Center  
11100 W. Broad Street  
Glen Allen, VA 23060  
www.thalhimer.com

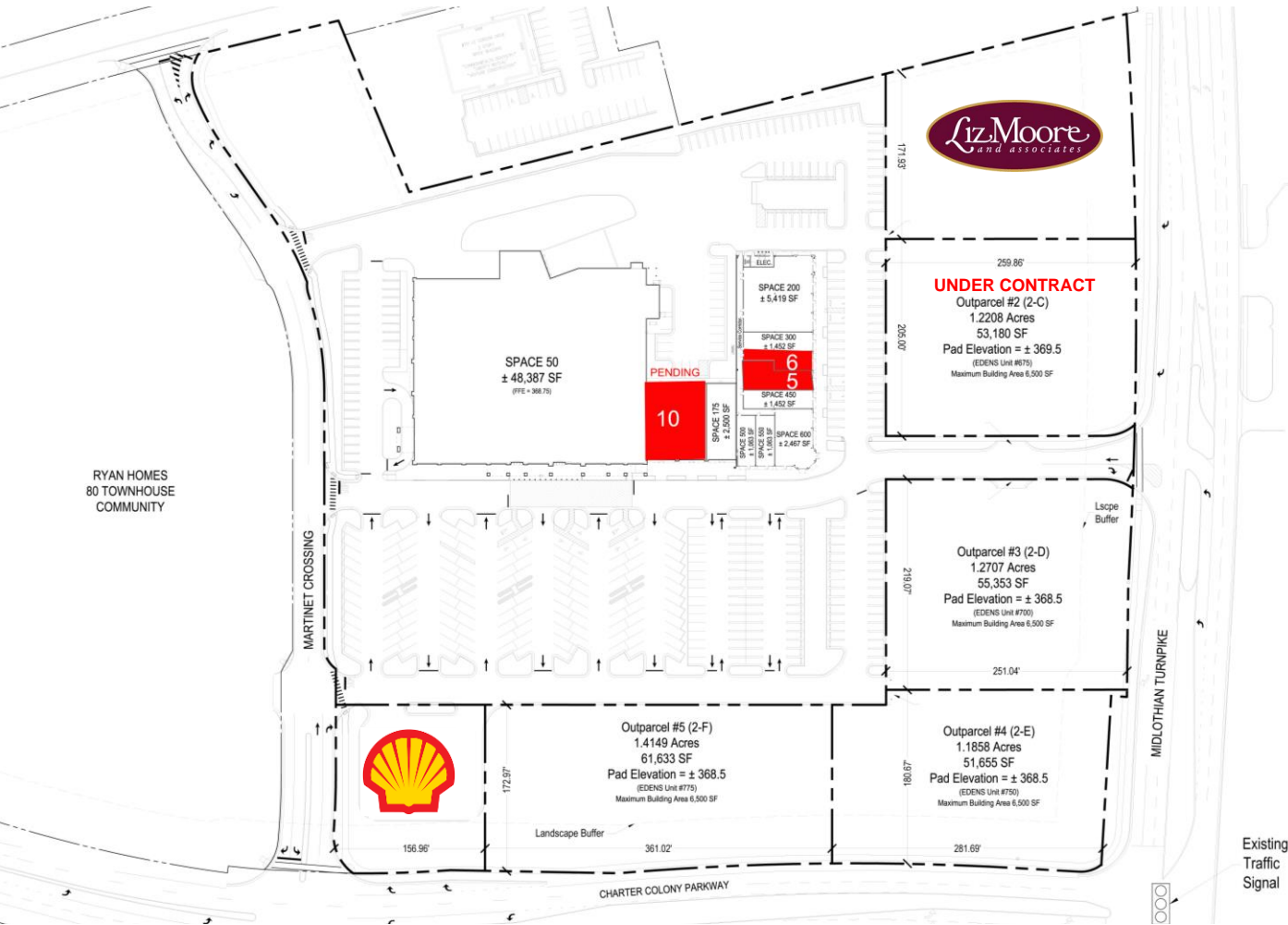

**Tenant List**

#	Tenant	SF
1	Moe's Southwest Grill	2,467
2	Black Swan Salon	1,063
3	The Joint Chiropractic	1,063
4	Jimmy John's	1,425
5	AVAILABLE	1,785
6	AVAILABLE	1,120
7	Marco's Pizza	1,452
8	O'Toole's Restaurant	5,419
9	Bliss Nails	2,500
10	PENDING	

**Available Outparcels**

Outparcel 1	Liz Moore & Associates
Outparcel 2	1.22 acres (Under Contract)
Outparcel 3	1.27 acres
Outparcel 4	1.19 acres
Outparcel 5	1.41 acres
Outparcel Fuel Pad	Shell Gas

For more information, contact:

**DAVID CRAWFORD**

Vice President  
804 697 3446  
david.crawford@thalhimer.com

**RICHARD THALHIMER**

Senior Vice President  
804 697 3416  
richard.thalhimer@thalhimer.com

Thalhimer Center  
11100 W. Broad Street  
Glen Allen, VA 23060  
www.thalhimer.com



RETAIL FOR LEASE & PAD SITES FOR SALE

# Publix at Charter Colony

Midlothian Turnpike at Charter Colony Parkway | Chesterfield County, Virginia

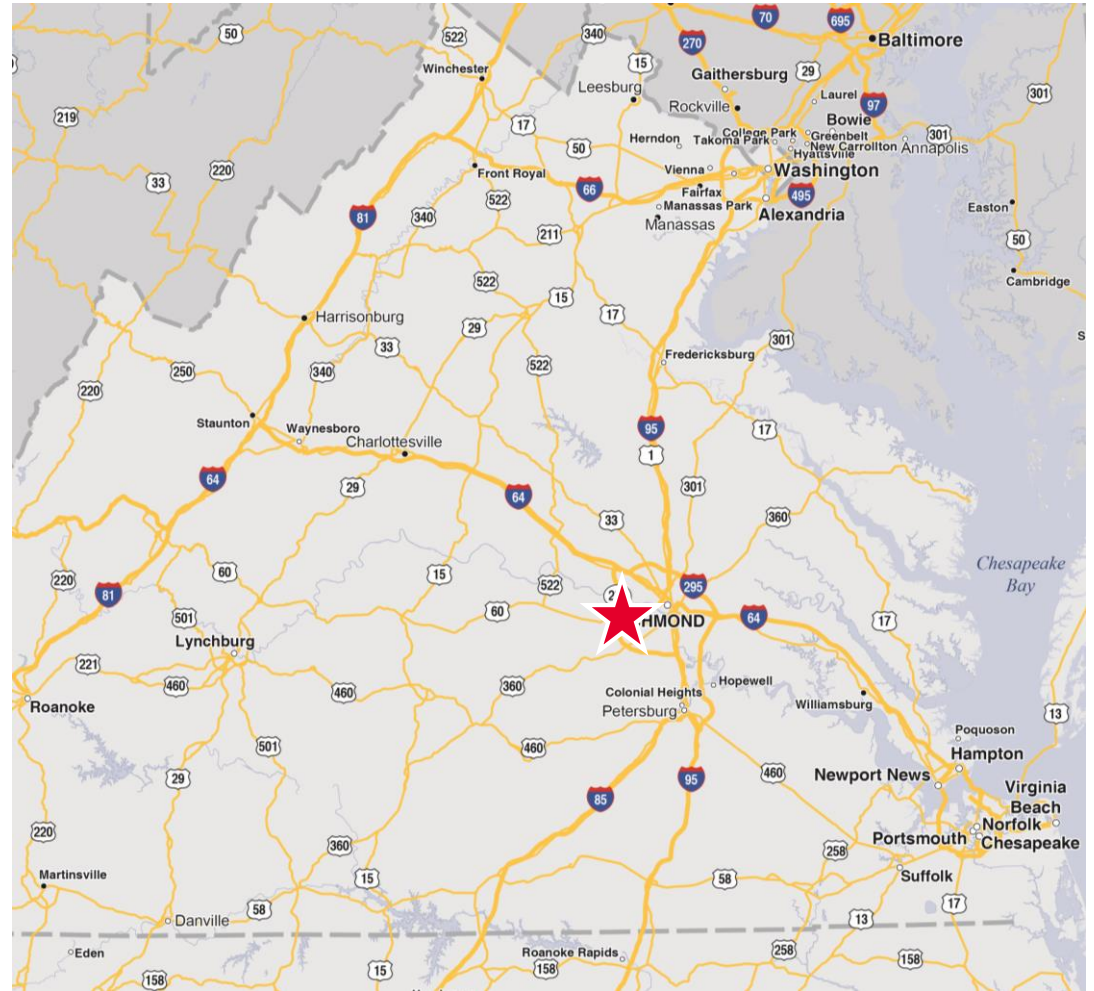
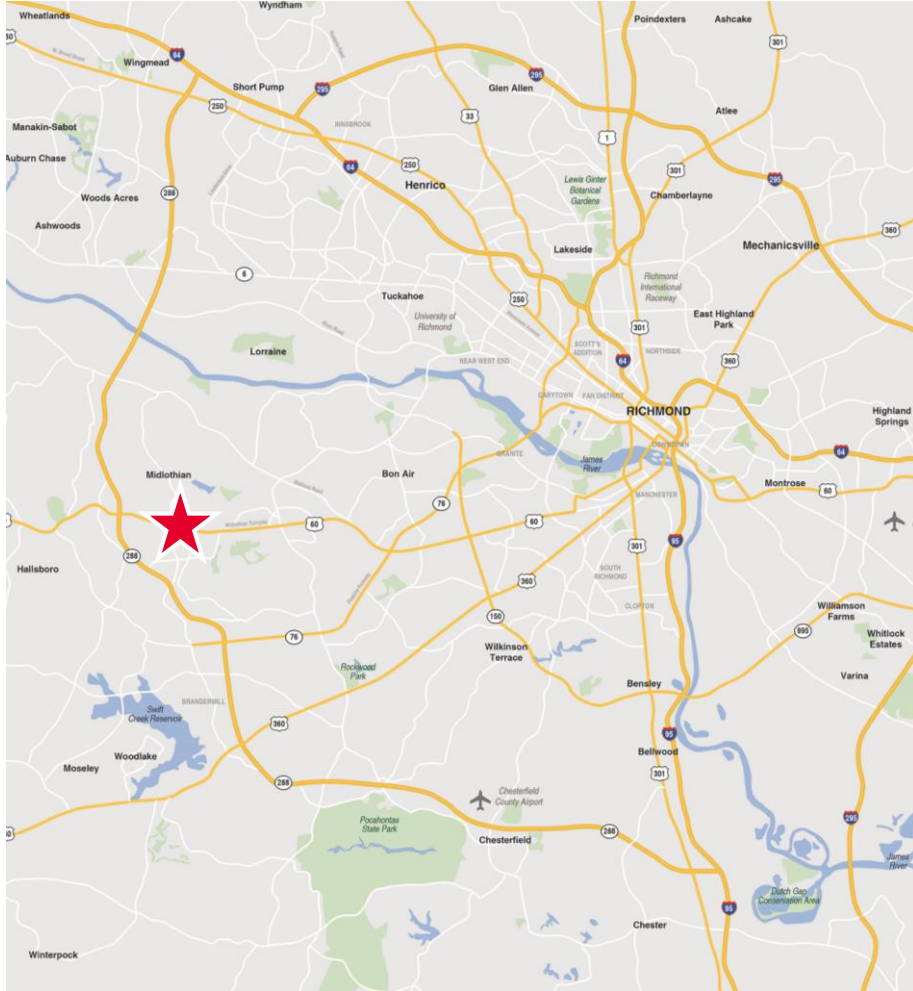

For more information, contact:

**DAVID CRAWFORD**

Vice President  
804 697 3446  
david.crawford@thalhimer.com

**RICHARD THALHIMER**

Senior Vice President  
804 697 3416  
richard.thalhimer@thalhimer.com

Thalhimer Center  
11100 W. Broad Street  
Glen Allen, VA 23060  
www.thalhimer.com

*Independently Owned and Operated / A Member of the Cushman & Wakefield Alliance*

*Cushman & Wakefield | Thalhimer © 2015. No warranty or representation, express or implied, is made to the accuracy or completeness of the information contained herein, and same is submitted subject to errors, omissions, change of price, rental or other conditions, withdrawal without notice, and to any special listing conditions imposed by the property owner(s). As applicable, we make no representation as to the condition of the property (or properties) in question.*