

Walmart Shadow Center For Lease

FAYETTE TOWN CENTER

114 Fayette Town Rd, Fayetteville, WV 25840



For More Information:

JOHN CUSUMANO

314.628.8499

john@mrpstl.com

AJ ANTHON

636.707.1244

aj@mrpstl.com

MRP
CAPITAL GROUP

Fayette Town Center

PROPERTY SUMMARY

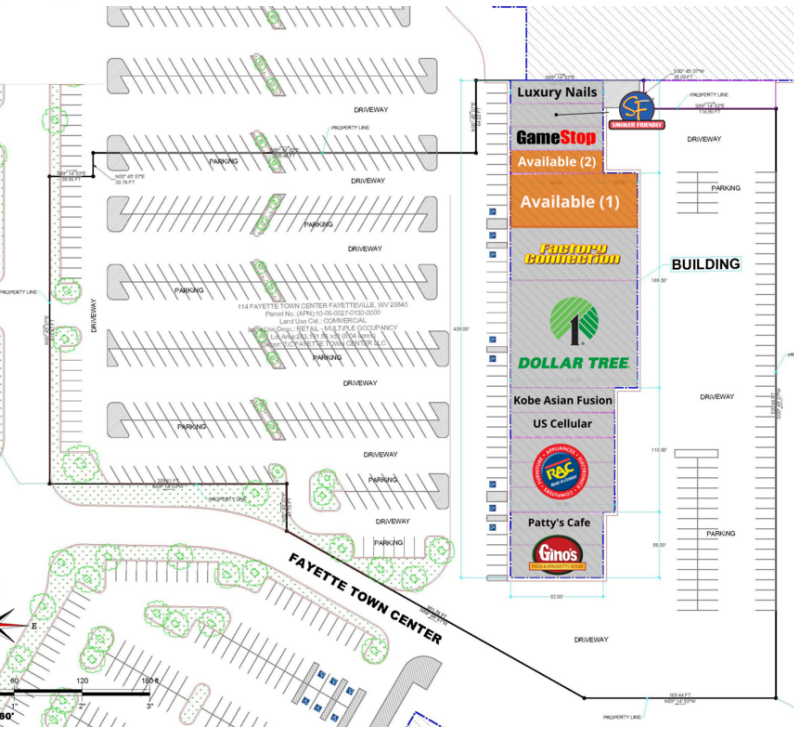

PROPERTY DESCRIPTION

Fayette Town Center is a 37,100 SF shopping center located in Fayetteville - connected to the neighboring Walmart Supercenter. Dollar Tree performs above average at this location. There has been steady development surrounding this shopping center, including CVS, Taco Bell, and KFC. Fayetteville's location within the Appalachian Mountains makes it a tourism destination for neighboring communities. Additionally, Fayetteville has a large draw in the summer months as a popular white-water rafting and outdoors destination.

LOCATION DESCRIPTION

Fayetteville is a town in and the county seat of Fayette County, West Virginia. Located less than a mile away from Fayetteville is the New River Gorge, which attracts outdoor recreation enthusiasts. The scenic cliffs that line the New River Gorge are popular for rock climbing. The New River offers Class I-IV whitewater rafting and kayaking. Hiking and biking trails in the area are also available. The New River Gorge National River, managed by the U.S. National Park Service, operates a visitors center and offers many educational programs in the area.

Fayetteville was listed as one of the 2006 "Top 10 Coolest Small Towns in America" by Budget Travel Magazine, and as "Best River Town 2013" by Blue Ridge Outdoors magazine.



PROPERTY HIGHLIGHTS

- 1,400-3,500 SF Available
- Walmart Supercenter and Lowe's anchored Shadow Center
- Frontage along Highway 19
- Popular tourism destination in the Appalachian Mountains

SPACES

SPACE SIZE

| | |
|---------------|----------|
| Available (2) | 1,400 SF |
| Available (1) | 3,500 SF |

DEMOGRAPHICS

3 MILES

5 MILES

10 MILES

| | | | |
|-------------------|----------|----------|----------|
| Total Households | 2,264 | 7,633 | 14,088 |
| Total Population | 5,481 | 17,821 | 34,539 |
| Average HH Income | \$43,601 | \$43,046 | \$42,803 |

JOHN CUSUMANO
314.628.8499
john@mrpstl.com

AJ ANTHON
636.707.1244
aj@mrpstl.com

MRP
CAPITAL GROUP

RETAILER MAP



Fayette Town Center

AERIAL MAP



JOHN CUSUMANO
314.628.8499
john@mrpstl.com

AJ ANTHON
636.707.1244
aj@mrpstl.com

MRP
CAPITAL GROUP