

500 Elliott Avenue W

Seattle, WA

Owner-User
Commercial
Office Condo

±2,900 SF office, condo

Built in 2000

Lower Queen Anne location

5 private offices, reception area,
large conference room, copy/
work room, kitchen, restroom/
shower, and bull pen

Sale price: \$990,000

3 on-site parking stalls

Amenities nearby

Floor plan on reverse

Call broker for more details and
to arrange tour



Location

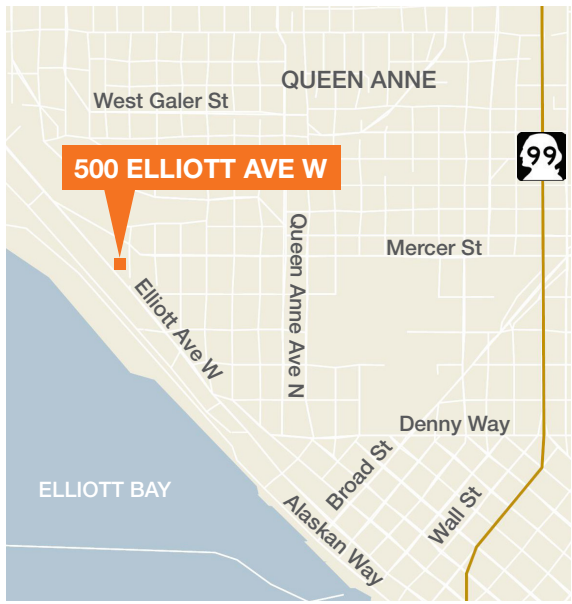

Contact

Corey Sollom
206.296.9620
csollom@kiddermathews.com

Rod Keefe
206.296.9642
rkeefe@kiddermathews.com

500 Elliott Avenue W

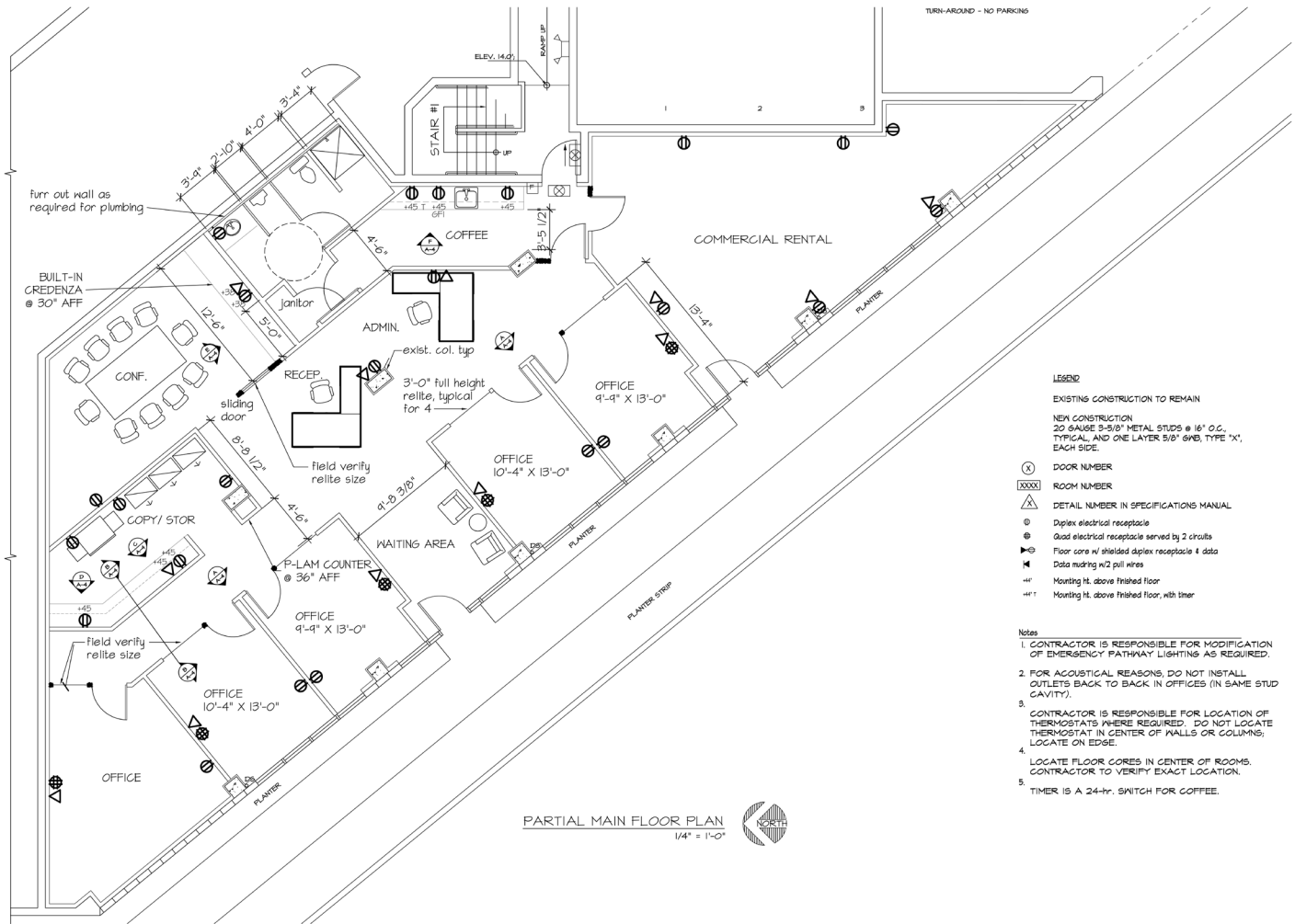

- LEGEND**
- EXISTING CONSTRUCTION TO REMAIN
- NEW CONSTRUCTION
20 GAUGE 3-5/8" METAL STUDS @ 16" O.C., TYPICAL, AND ONE LAYER 5/8" GYB, TYPE "X", EACH SIDE.
- (X) DOOR NUMBER
 - (XXXX) ROOM NUMBER
 - (#) DETAIL NUMBER IN SPECIFICATIONS MANUAL
 - (⊕) Duplex electrical receptacle
 - (⊕) Quad electrical receptacle served by 2 circuits
 - (⊕) Floor core n/ shielded duplex receptacle 4 data
 - (⊕) Data rading n/2 pull wires
 - (H) Mounting ht. above finished floor
 - (H1) Mounting ht. above finished floor, with timer
- Notes**
1. CONTRACTOR IS RESPONSIBLE FOR MODIFICATION OF EMERGENCY PATHWAY LIGHTING AS REQUIRED.
 2. FOR ACOUSTICAL REASONS, DO NOT INSTALL OUTLETS BACK TO BACK IN OFFICES (IN SAME STUD CAVITY).
 3. CONTRACTOR IS RESPONSIBLE FOR LOCATION OF THERMOSTATS WHERE REQUIRED. DO NOT LOCATE THERMOSTAT IN CENTER OF WALLS OR COLUMNS; LOCATE ON EDGE.
 4. LOCATE FLOOR CORES IN CENTER OF ROOMS. CONTRACTOR TO VERIFY EXACT LOCATION.
 5. TIMER IS A 24-HR. SWITCH FOR COFFEE.

PARTIAL MAIN FLOOR PLAN
1/4" = 1'-0"

Contact

Corey Sollom
206.296.9620
csollom@kiddermathews.com

Rod Keefe
206.296.9642
rkeefe@kiddermathews.com

This information supplied herein is from sources we deem reliable. It is provided without any representation, warranty or guarantee, expressed or implied as to its accuracy. Prospective Buyer or Tenant should conduct an independent investigation and verification of all matters deemed to be material, including, but not limited to, statements of income and expenses. Consult your attorney, accountant, or other professional advisor.