



MAIN STREET PROPERTY FOR LEASE

3604-3614 Main Street, Kansas City, Missouri



LEASE RATE: \$10-\$14/SF NNN | 5,000 - 15,000 SF

DEMOGRAPHICS

| | 1 mile | 3 miles | 5 miles |
|-----------------------|----------|----------|----------|
| Estimated Population | 21,055 | 116,612 | 269,870 |
| Avg. Household Income | \$57,806 | \$73,445 | \$75,036 |

- B3-2 Zoning allowing multiple uses
- 12' clear height in 10,000 SF
- 25 existing parking spaces
- Two drive-in doors with additional storage are in the basement
- In the direct path of the Street Car extension
- Potential Redevelopment Opportunity for the right user

 [CLICK HERE TO VIEW MORE LISTING INFORMATION](#)

For More Information Contact:

Exclusive Agents
 DANIEL BROCATO | 816.412.7303 | dbrocato@blockandco.com
 MARSHAL BLOUNT | 816.412.7342 | mblount@blockandco.com
 PHIL PECK, CCIM | 816.412.7364 | ppeck@blockandco.com





MAIN STREET PROPERTY FOR LEASE

3604-3614 Main Street, Kansas City, Missouri

5,000 - 15,000 SF
AVAILABLE
FOR LEASE

AERIAL



AERIAL





MAIN STREET PROPERTY FOR LEASE

3604-3614 Main Street, Kansas City, Missouri

5,000 - 15,000 SF
AVAILABLE
FOR LEASE

PLAN

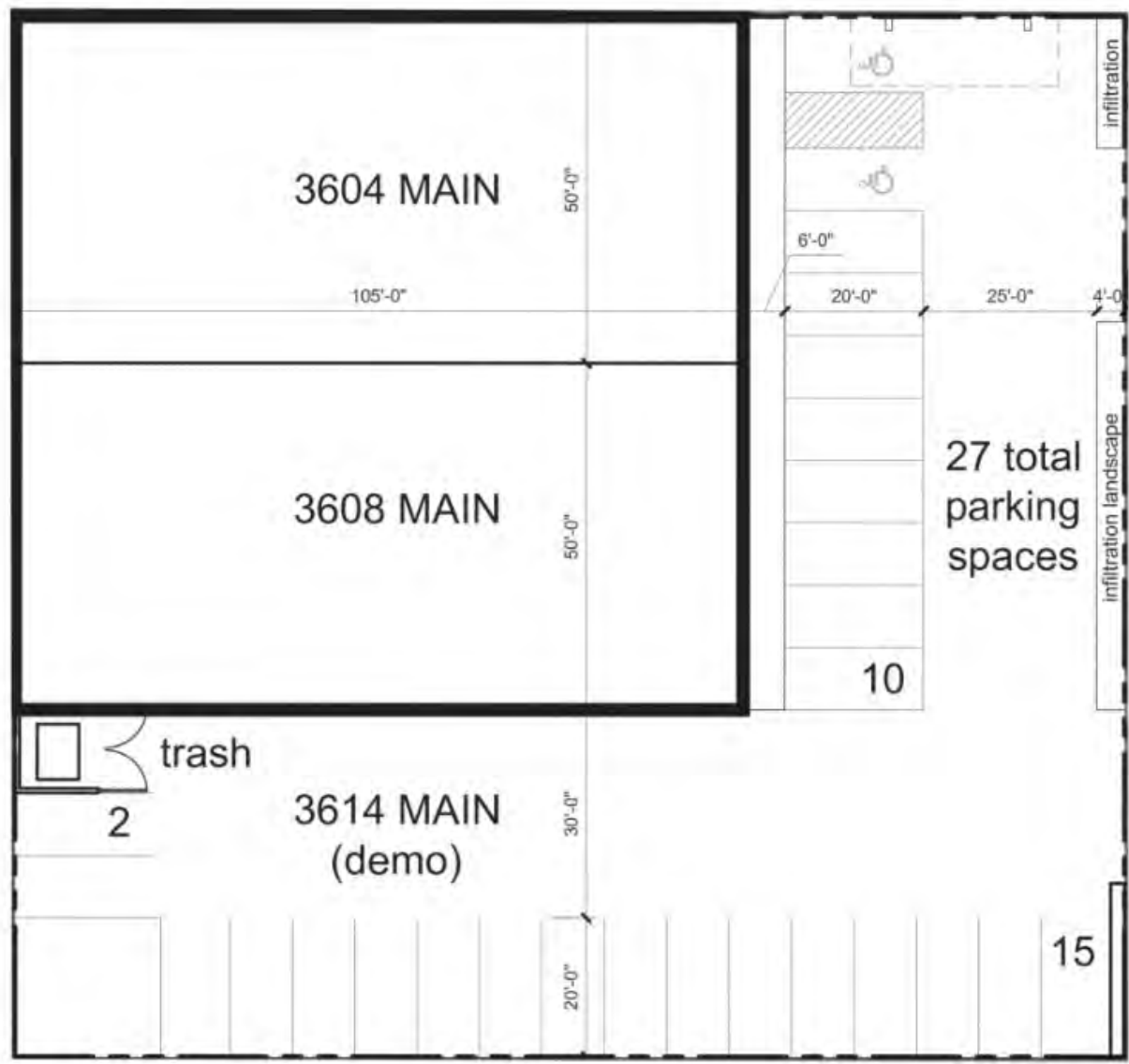



MAIN STREET PROPERTY FOR LEASE

3604-3614 Main Street, Kansas City, Missouri

5,000 - 15,000 SF
AVAILABLE
FOR LEASE

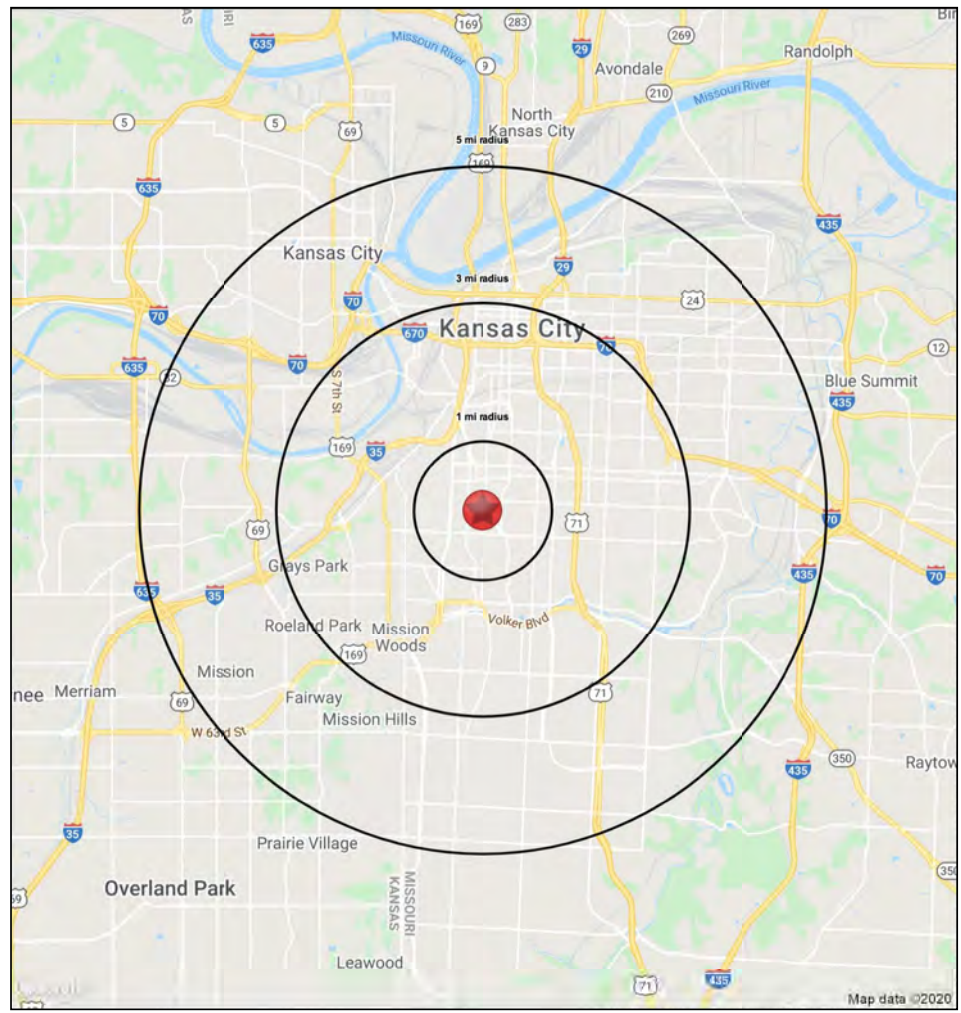
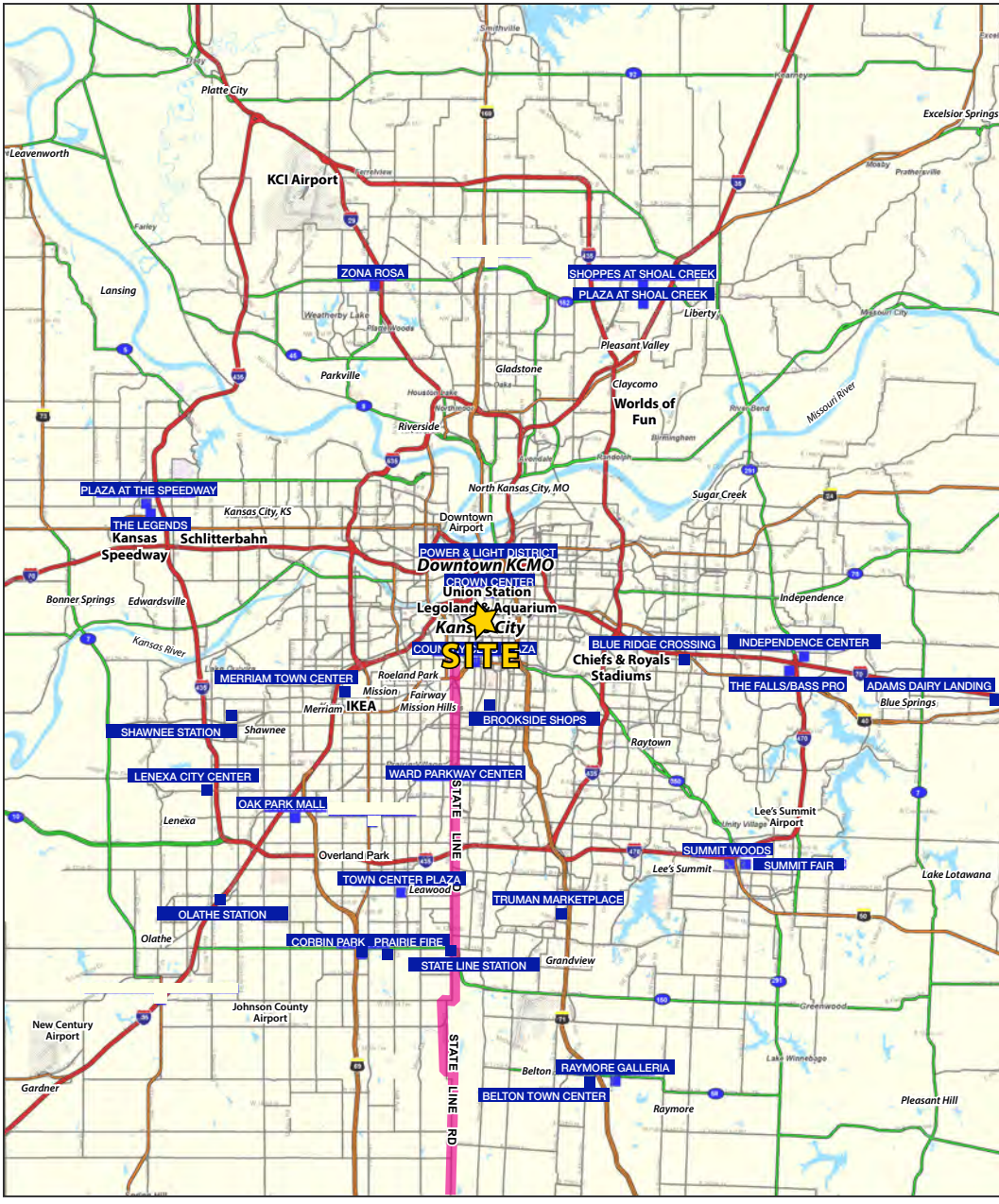

Block & Company, Inc., Realtors | 605 W. 47th Street, Ste. 200, Kansas City, MO 64112 | 816.753.6000 | www.blockandco.com



All information furnished regarding property for sale or lease is from sources deemed reliable, but no warranty or representation is made as to the accuracy thereof and the same is subject to errors, omissions, changes of prices, rental or other conditions, prior sale or lease or withdrawal without notice.



MAIN STREET PROPERTY FOR LEASE

3604-3614 Main Street, Kansas City, Missouri

3604 Main Street

Kansas City, MO 64111

1 mi radius 3 mi radius 5 mi radius

| | | 1 mi radius | 3 mi radius | 5 mi radius |
|----------------------------|---|-------------|-------------|-------------|
| POPULATION | 2020 Estimated Population | 21,055 | 116,612 | 269,870 |
| | 2025 Projected Population | 21,861 | 122,600 | 283,753 |
| | 2010 Census Population | 18,395 | 105,149 | 253,797 |
| | 2000 Census Population | 20,395 | 116,616 | 275,889 |
| | Projected Annual Growth 2020 to 2025 | 0.8% | 1.0% | 1.0% |
| | Historical Annual Growth 2000 to 2020 | 0.2% | - | -0.1% |
| | 2020 Median Age | 34.2 | 34.9 | 34.6 |
| HOUSEHOLDS | 2020 Estimated Households | 12,444 | 59,291 | 122,468 |
| | 2025 Projected Households | 12,516 | 60,860 | 126,582 |
| | 2010 Census Households | 10,162 | 49,529 | 107,965 |
| | 2000 Census Households | 10,856 | 53,458 | 115,677 |
| | Projected Annual Growth 2020 to 2025 | 0.1% | 0.5% | 0.7% |
| | Historical Annual Growth 2000 to 2020 | 0.7% | 0.5% | 0.3% |
| RACE AND ETHNICITY | 2020 Estimated White | 62.2% | 47.6% | 49.3% |
| | 2020 Estimated Black or African American | 23.6% | 39.4% | 32.7% |
| | 2020 Estimated Asian or Pacific Islander | 2.5% | 3.2% | 3.8% |
| | 2020 Estimated American Indian or Native Alaskan | 0.7% | 0.6% | 0.6% |
| | 2020 Estimated Other Races | 11.0% | 9.2% | 13.6% |
| | 2020 Estimated Hispanic | 14.1% | 12.2% | 20.1% |
| INCOME | 2020 Estimated Average Household Income | \$57,806 | \$73,445 | \$75,036 |
| | 2020 Estimated Median Household Income | \$50,387 | \$54,541 | \$55,742 |
| | 2020 Estimated Per Capita Income | \$34,352 | \$37,635 | \$34,273 |
| EDUCATION (AGE 25+) | 2020 Estimated Elementary (Grade Level 0 to 8) | 2.7% | 3.2% | 6.2% |
| | 2020 Estimated Some High School (Grade Level 9 to 11) | 5.0% | 7.5% | 8.9% |
| | 2020 Estimated High School Graduate | 16.8% | 22.2% | 24.1% |
| | 2020 Estimated Some College | 19.2% | 19.9% | 19.1% |
| | 2020 Estimated Associates Degree Only | 5.9% | 5.8% | 5.9% |
| | 2020 Estimated Bachelors Degree Only | 28.6% | 23.8% | 21.0% |
| | 2020 Estimated Graduate Degree | 21.7% | 17.5% | 14.8% |
| BUSINESS | 2020 Estimated Total Businesses | 2,295 | 10,544 | 16,808 |
| | 2020 Estimated Total Employees | 31,400 | 185,829 | 263,501 |
| | 2020 Estimated Employee Population per Business | 13.7 | 17.6 | 15.7 |
| | 2020 Estimated Residential Population per Business | 9.2 | 11.1 | 16.1 |

