

Commercial



Space Available

SIZE:	1,150-2,510 SF
YEAR BUILT:	2006
LEASE TYPE:	Gross
LEASE TERM:	Negotiable
AVAILABLE:	Immediate

PROPERTY HIGHLIGHTS

Class A building built out in multiple styles ranging from lab, medical, to classroom/instructional space.

Units available from 1,150 – 2,510 sq ft.

Property has abundant parking at 11.93 per 1,000 sq ft. Hilltop setting with 360° panoramic glass provides premium views in every unit.

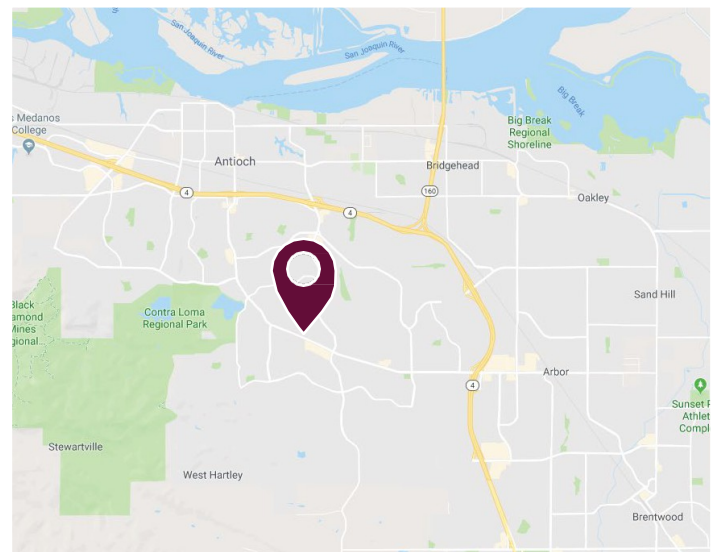

Matt Hagar, MSRE, CCIM |
BRE# 01896662 | 925-380-9006
Matt@InteroWC.com

590 Ygnacio Valley Road Ste 102
Walnut Creek, CA 94596
925-278-1282 | InteroWC.com

INTERO

2157 Country Hills Drive | Antioch, CA 94531

Commercial



Commercial

FLOORPLAN - 1ST FLOOR

Occupied

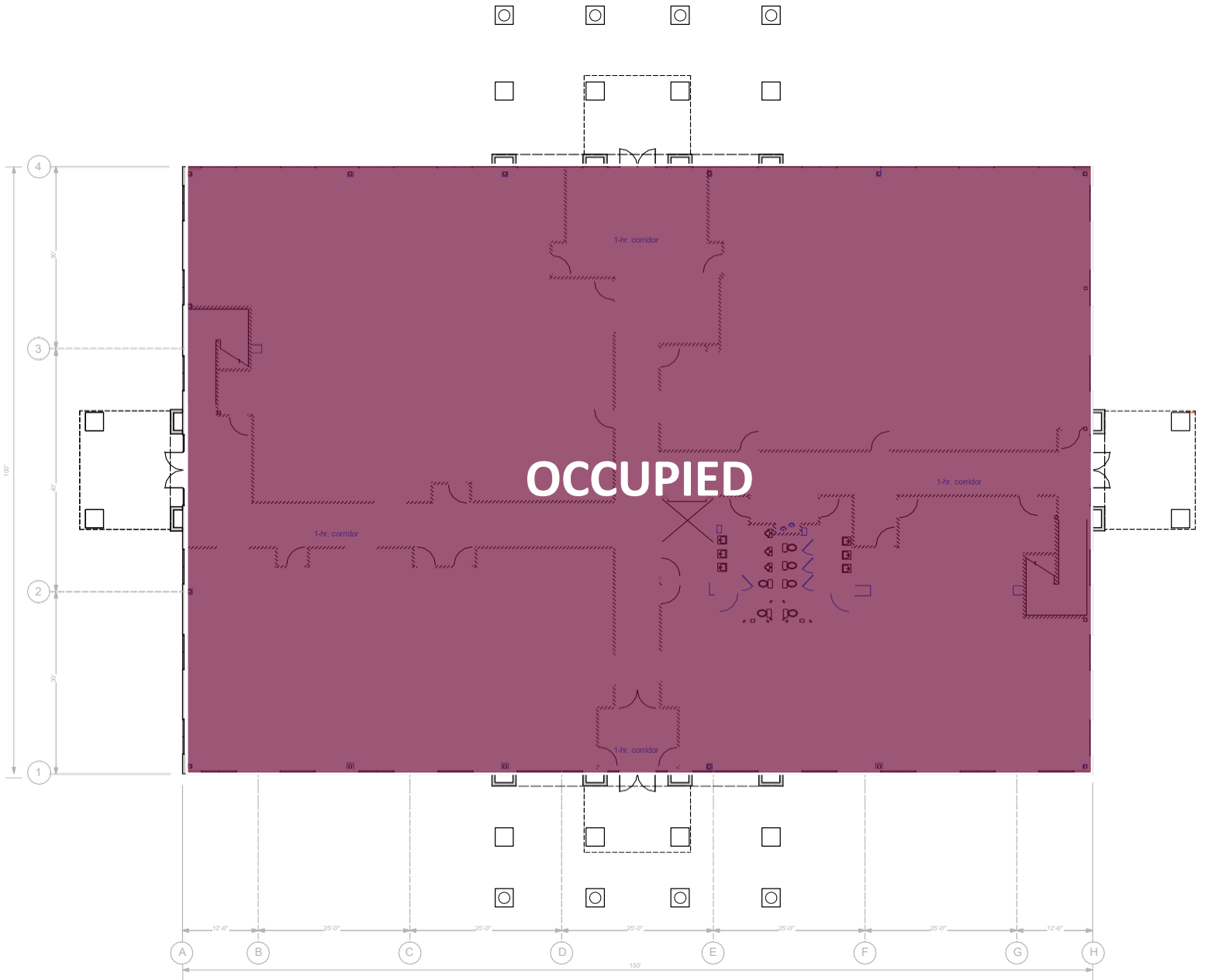

Commercial

FLOORPLAN - 2ND FLOOR Available

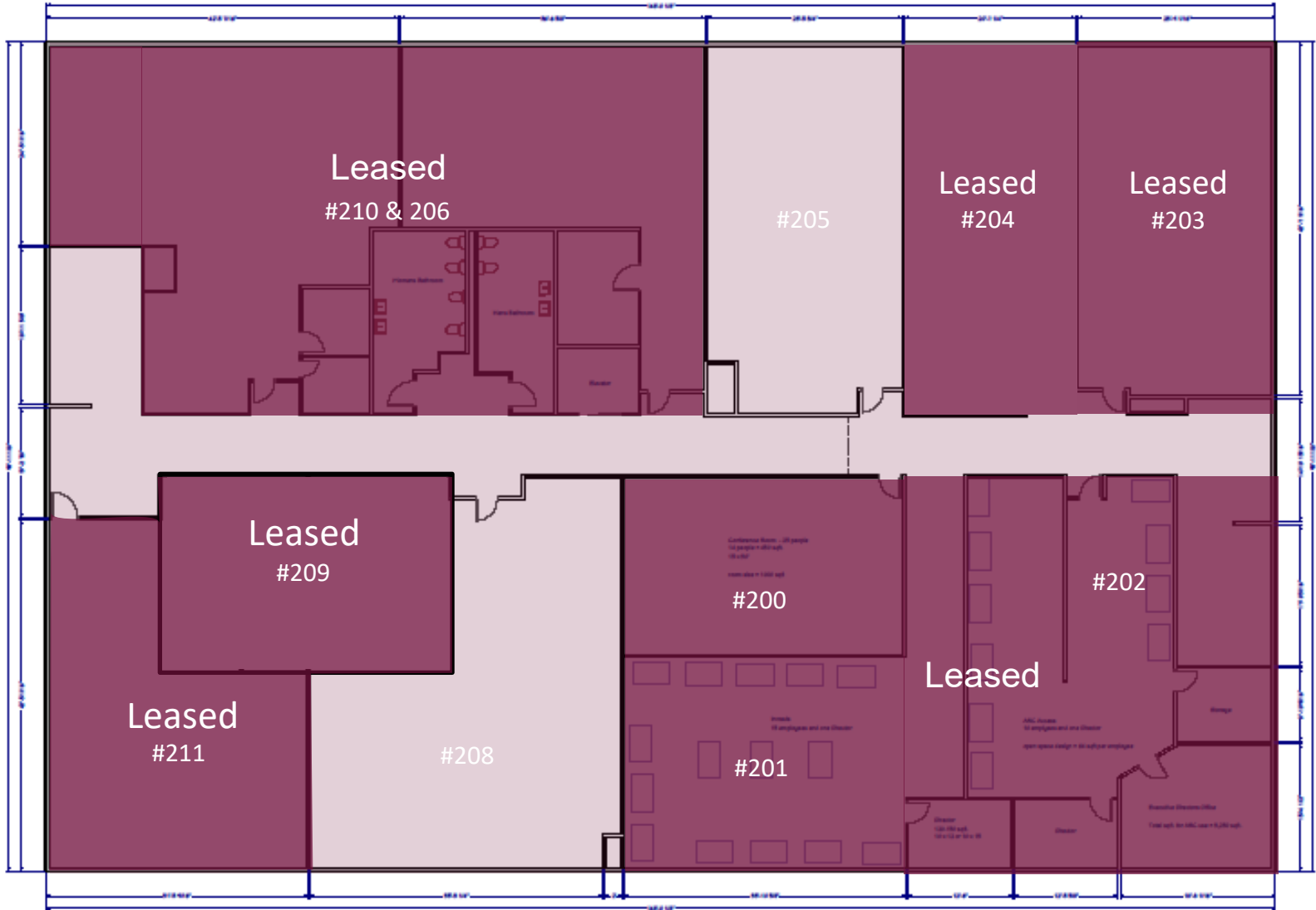

Suite	Rentable Sq Ft
204	900
203	975
205	1,150
211	900
209	790

Suite	Rentable Sq Ft
208	1,360
210	1,560
206	860

*All measurements are approximated



2019 Summary	1 Mile	3 Miles	5 Miles	2024 Summary	1 Mile	3 Miles	5 Miles
Population	20,643	90,611	187,405	Population	21,281	94,533	197,263
Households	5,846	27,583	57,670	Households	6,008	28,642	60,382
Families	4,891	21,999	45,349	Families	5,026	22,856	47,520
Average Household Size	3.51	3.27	3.23	Average Household Size	3.52	3.28	3.25
Owner Occupied Housing Units	4,817	20,650	41,585	Owner Occupied Housing Units	4,986	21,758	44,127
Renter Occupied Housing Units	1,029	6,933	16,085	Renter Occupied Housing Units	1,022	6,884	16,255
Median Age	36.3	35.9	35.1	Median Age	37.1	36.6	35.7
Median Household Income	\$108,605	\$89,385	\$86,785	Median Household Income	\$126,052	\$106,089	\$104,073
Average Household Income	\$134,606	\$111,776	\$109,398	Average Household Income	\$162,392	\$135,591	\$131,855

ABOUT ANTIOCH, CA

Antioch is the second largest city in Contra Costa County, California, United States. Located in the East Bay region of the San Francisco Bay Area along the San Joaquin-Sacramento River Delta, it is a suburb of San Francisco and Oakland. With a population of over 100,000 people, Antioch has become the heart of Eastern Contra Costa County, offering a variety of employment, shopping and vast recreational activities. Land remains plentiful and affordable, compared with other parts of the Bay Area. Retail and office space in Antioch typically leases for 20 to 30 percent less than comparable space in central Contra Costa County.



Matt Hagar, MSRE, CCIM

BRE# 01896662 | 925-380-9006

Matt@InteroWC.com

590 Ygnacio Valley Road Ste 102

Walnut Creek, CA 94596

925-278-1282 | InteroWC.com