

Publix #1637 - Publix at Lake Crossing

5443 Platt Springs Road
Lexington, SC 29073
Lat 33.908, Long -81.224

FOR LEASE



LAST TWO AVAILABLE SUITES - 1,400 – 2,800 SF

PROPERTY HIGHLIGHTS

- Located in High Growth Market of Lexington, SC
- Publix-Anchored Center with 700,000+ Visitors Annually
- Excellent Opportunity for Restaurants, Medical and Service Oriented Tenants
- Suites Available from 1,400 SF – 2,800 SF
- Traffic Count: 32,300 VPD

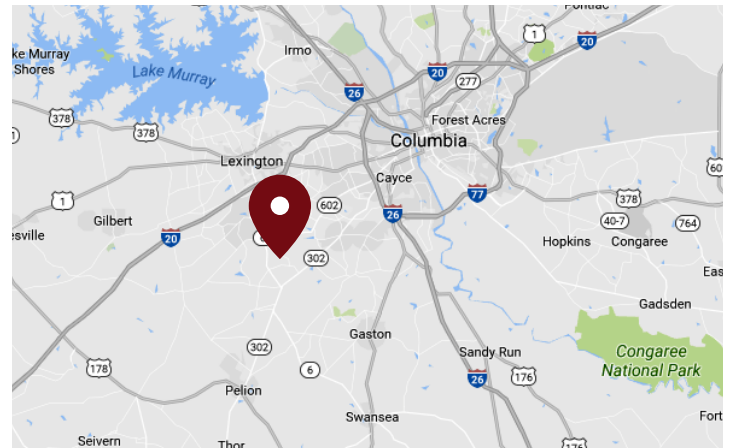

| DEMOGRAPHICS | 1 Mile | 3 Miles | 5 Miles |
|--------------------|----------|----------|----------|
| Total Population | 3,281 | 23,206 | 56,788 |
| Daytime Population | 2,844 | 18,034 | 48,473 |
| Total Households | 1,256 | 7,885 | 21,329 |
| Avg. HH Income | \$70,384 | \$68,562 | \$71,916 |

Data provided by Placer Labs Inc. (www.placer.ai) & Esri

Jill Ecuyer

Office: 704.208.0239 | Cell: 704.609.0010 | jecuyer@crossmanco.com
5950 Fairview Road, Suite 610, Charlotte, NC

Licensed Real Estate Broker. No warranty expressed or implied has been made to the accuracy of the information provided herein, no liability assumed for error or omission.



www.crossmanco.com

Publix #1637 - Publix at Lake Crossing

5443 Platt Springs Road
 Lexington, SC 29073
 Lat 33.908, Long -81.224

SITE PLAN

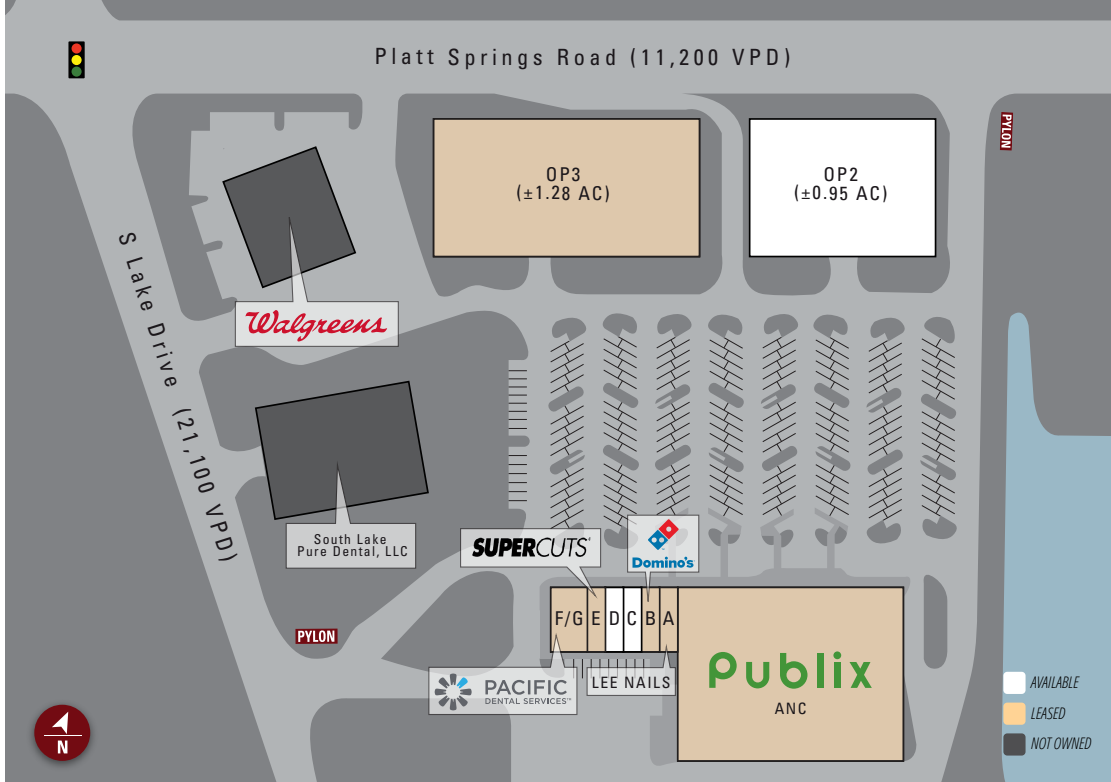

| Suite | Tenant | Size |
|-------|----------------|----------|
| ANC | Publix | 45,600 |
| A | Lee Nails | 1,400 |
| B | Domino's | 1,400 |
| C | AVAILABLE | 1,400 |
| D | AVAILABLE | 1,400 |
| E | Supercuts | 1,400 |
| F/G | Pacific Dental | 2,800 |
| OP2 | AVAILABLE | ±0.95 AC |
| OP3 | *PENDING* | ±1.28 AC |

TOTAL 55,400



Jill Ecuyer

Office: 704.208.0239 | Cell: 704.609.0010 | jecuyer@crossmanco.com
 5950 Fairview Road, Suite 610, Charlotte, NC

Licensed Real Estate Broker. No warranty expressed or implied has been made to the accuracy of the information provided herein, no liability assumed for error or omission.



www.crossmanco.com

Publix #1637 - Publix at Lake Crossing

5443 Platt Springs Road
Lexington, SC 29073
Lat 33.908, Long -81.224

FOOT TRAFFIC OVERVIEW

EST. # OF CUSTOMERS ANNUALLY

 **132,700**

EST. # OF VISITS ANNUALLY

 **696,400**

AVG. VISITS / CUSTOMER

 **5.25**

AVG. LENGTH-OF-STAY / VISIT

 **36 MIN**

TOP 3 DAYS



| | |
|----------|---------|
| Saturday | 125,024 |
| Sunday | 124,852 |
| Friday | 103,402 |

OF VISITS

TOP 3 HOURS



| | |
|--------|---------|
| 5-6 PM | 137,089 |
| 4-5 PM | 129,699 |
| 6-7 PM | 119,927 |

OF VISITS

Data provided by Placer Labs Inc. (www.placer.ai) Nov 1, 2019 - Oct 31, 2020

SITE VISIT DENSITY

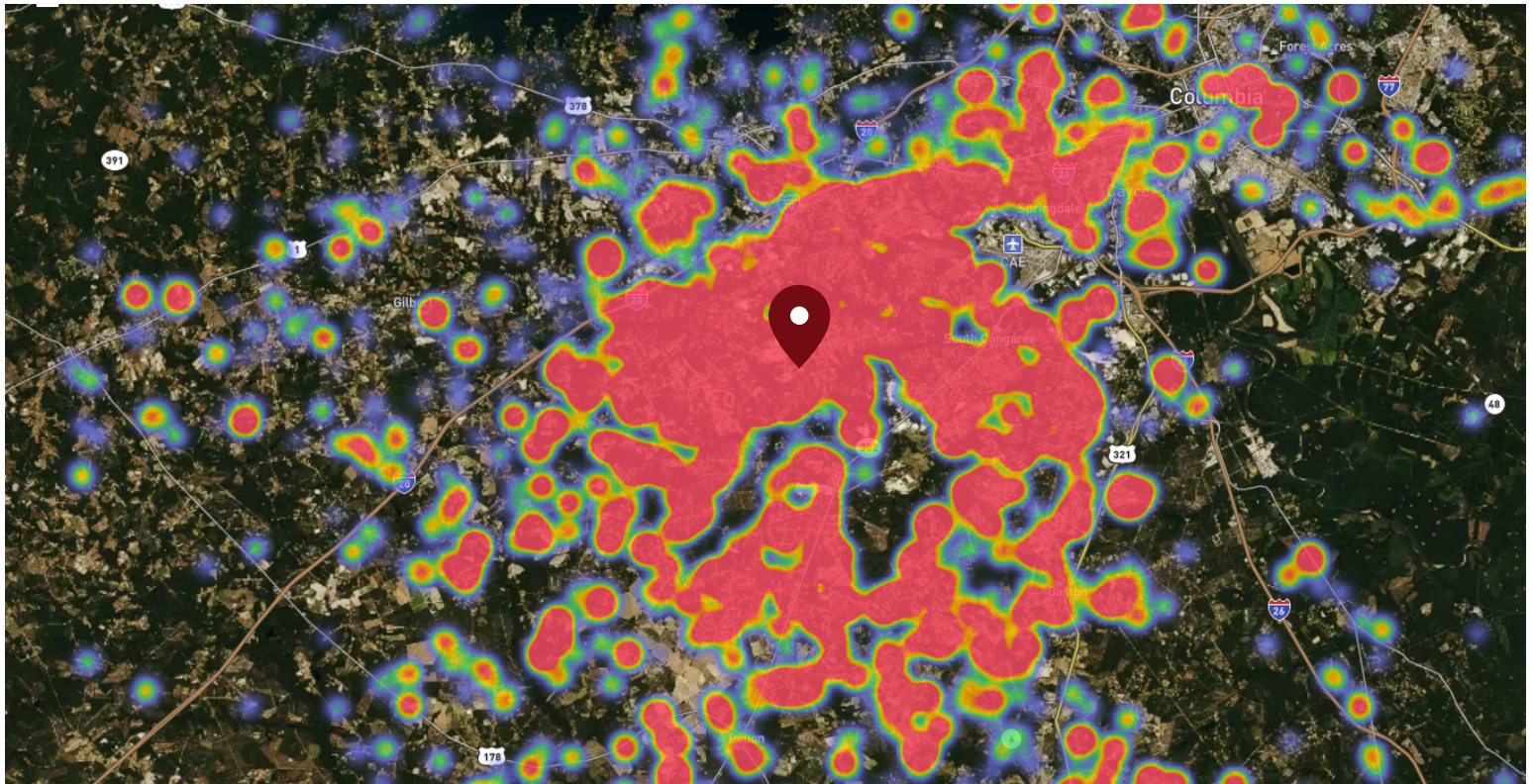

Red, orange, and yellow colors represent the location of 60% of site visitors

Data provided by Placer Labs Inc. (www.placer.ai)

Jill Ecuyer

Office: 704.208.0239 | Cell: 704.609.0010 | jecuyer@crossmanco.com
5950 Fairview Road, Suite 610, Charlotte, NC

Licensed Real Estate Broker. No warranty expressed or implied has been made to the accuracy of the information provided herein, no liability assumed for error or omission.



www.crossmanco.com