

2514 S. BUCKNER BLVD.

FOR LEASE

DALLAS, TEXAS

S. BUCKNER BLVD. BETWEEN SCYENE AND BRUTON

MIKE SMITH

KIMBERLY SON



HIGHLIGHTS

- Building is 3,200 SF; Primarily used for retail and office space.
- Approximately 21 parking spaces.
- Zoning: Planned Development District 366

LEASING | TENANT REPRESENTATION | LAND | INVESTMENT SALES | PROPERTY MANAGEMENT



SCYENE RD

JIM MILLER RD



Piedmont Global Academy

San Jacinto Elementary School

SITE



BRUTON RD

BUCKNER BLVD

VENTURE
COMMERCIAL

214.378.1212
8235 Douglas Ave, Suite 720
Dallas, TX 75225

2514 BUCKNER BLVD
DALLAS, TX

The information contained herein was obtained from sources deemed to be reliable. However, Venture makes no guarantees, warranties, or representations as to the completeness or accuracy thereof. MAY 128

2514 S. BUCKNER BLVD.

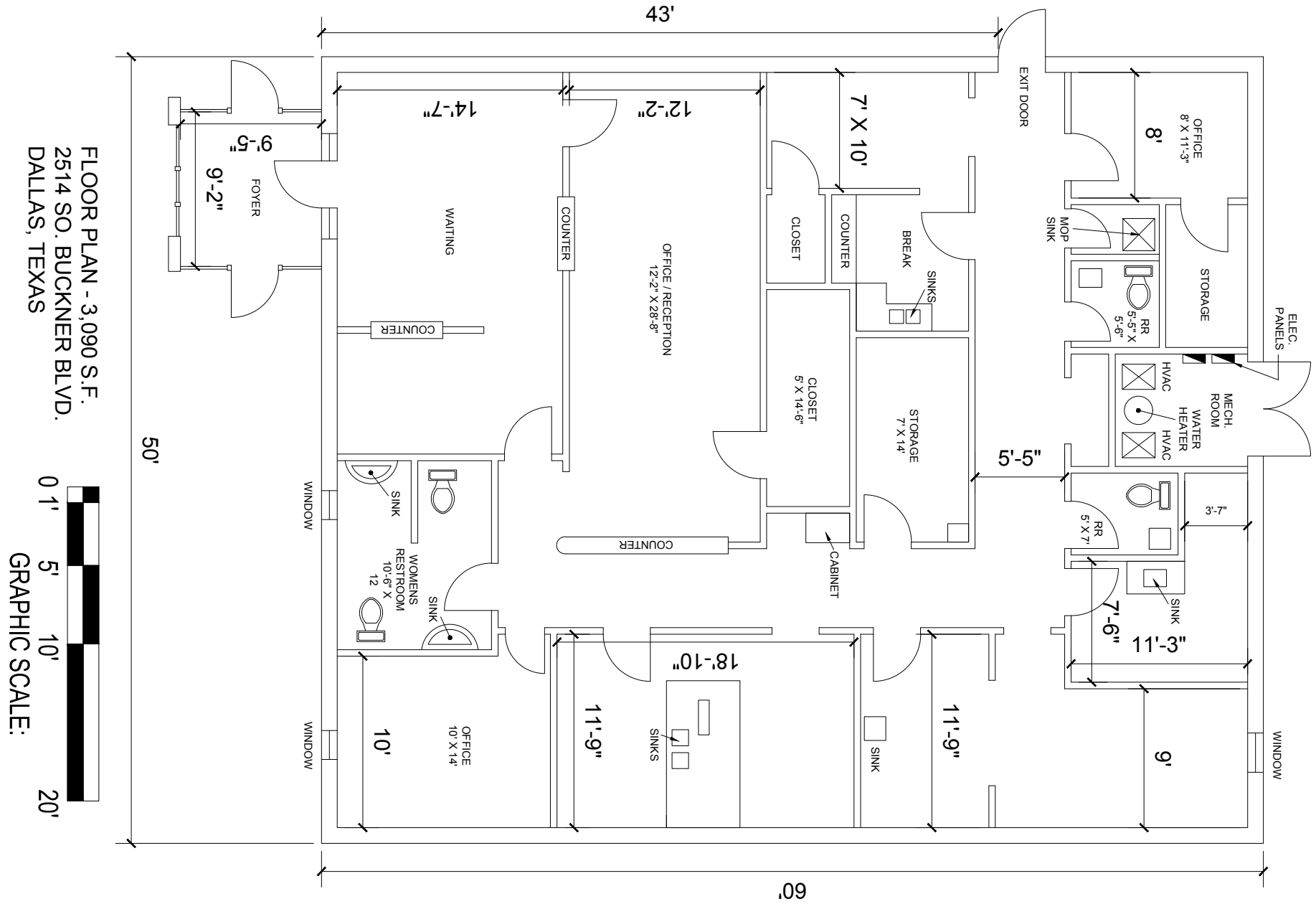

DEMOGRAPHICS	1 MILE	3 MILE	5 MILE
2017 EST POPULATION	17,978	122,125	288,064
2017 EST DAYTIME POPULATION	9,243	67,627	155,026
2017 EST AVG HH INCOME	\$42,637	\$45,303	\$50,722

