



For Lease
1709 Chestnut Place
 Denver, Colorado



For more information:
Dorit Makovsky Fischer
 303 565 3025
 dfischer@shamesmakovsky.com
Hayden Hirschfeld
 303 565 3048
 hhirschfeld@shamesmakovsky.com
Cory Dulberg
 303 565 3039
 cdulberg@shamesmakovsky.com

1400 Glenarm Place, Suite 100
 Denver, CO 80202
 303 534 5005
naishamesmakovsky.com



For Lease
Union Station TOD
 Street-Level Retail



The Grand Denver

1709 & 1777 Chestnut Place | Denver, Colorado 80202

Project Overview

- Ground floor retail opportunity in new construction Class A multifamily development in Union Station
- Centrally located at the intersection of 17th Street & Chestnut Place, directly attached to the Light Rail Plaza
- 4 retail spaces available ranging in size from 1,301 SF 2,828 SF
- Significant growth in population and new developments
- Preferred uses: specialty fitness, chef-driven restaurants, healthy fast casual, bar or cafe, lifestyle soft goods
- Walk Score of 89, Transit Score of 93, Bike Score of 87

Contact Broker for Lease Rates

NO WARRANTY OR REPRESENTATION, EXPRESS OR IMPLIED, IS MADE AS TO THE ACCURACY OF THE INFORMATION CONTAINED HEREIN, AND THE SAME IS SUBMITTED SUBJECT TO ERRORS, OMISSIONS, CHANGE OF PRICE, RENTAL OR OTHER CONDITIONS, PRIOR SALE, LEASE OR FINANCING, OR WITHDRAWAL WITHOUT NOTICE, AND OF ANY SPECIAL LISTING CONDITIONS IMPOSED BY OUR PRINCIPALS NO WARRANTIES OR REPRESENTATIONS ARE MADE AS TO THE CONDITION OF THE PROPERTY OR ANY HAZARDS CONTAINED THEREIN ARE ANY TO BE IMPLIED.

For more information:
Dorit Makovsky Fischer
 303 565 3025
 dfischer@shamesmakovsky.com
Hayden Hirschfeld
 303 565 3048
 hhirschfeld@shamesmakovsky.com
Cory Dulberg
 303 565 3039
 cdulberg@shamesmakovsky.com

1400 Glenarm Place, Suite 100
 Denver, CO 80202
 303 534 5005
naishamesmakovsky.com

For Lease
1709 Chestnut Place
 Denver, Colorado

Project Overview

The Grand Denver is a brand new high-rise mixed-use multifamily development in Denver's premier Downtown neighborhood, Union Station.

Designed by Shears Adkins Rockmore, the two glass & brick clad towers boasts 508 apartments adjoined by a landscaped court and accessed via a common private lane.

Common areas include a pool and rooftop club room, over 8,000 SF of street-level retail, EV charging stations, 458 parking spaces, and 100 bicycle stalls.

The site is adjacent to Commons Park, a Whole Foods Market, and anchors the western end of Denver's three block long transportation hub, Union Station, providing access to RTD Light Rail, local and regional buses, and the Colorado A-Line rail connection to Denver International Airport.

Development Facts

- Plaza (S. Tower): Completed Early 2018
 - » 107 apartment units
 - » 164 parking spaces
 - » 3 street-level retail spaces
- Tower (N. Tower): Spring 2018 Delivery
 - » Tower: 401 apartment units
 - » 294 parking spaces
 - » 1 street-level retail space

Available Retail Suites

- South Tower: Completed Early 2018
 - » Suite R1: 2,335 SF
 - » Suite R2: 2,828 SF
 - » Suite R3-A: 1,301 SF
- North Tower: Spring 2018 Delivery
 - » Suite R4: 1,153 SF



1400 Glenarm Place, Suite 100
 Denver, CO 80202
 303 534 5005
naishamesmakovsky.com



For Lease
1709 Chestnut Place
 Denver, Colorado

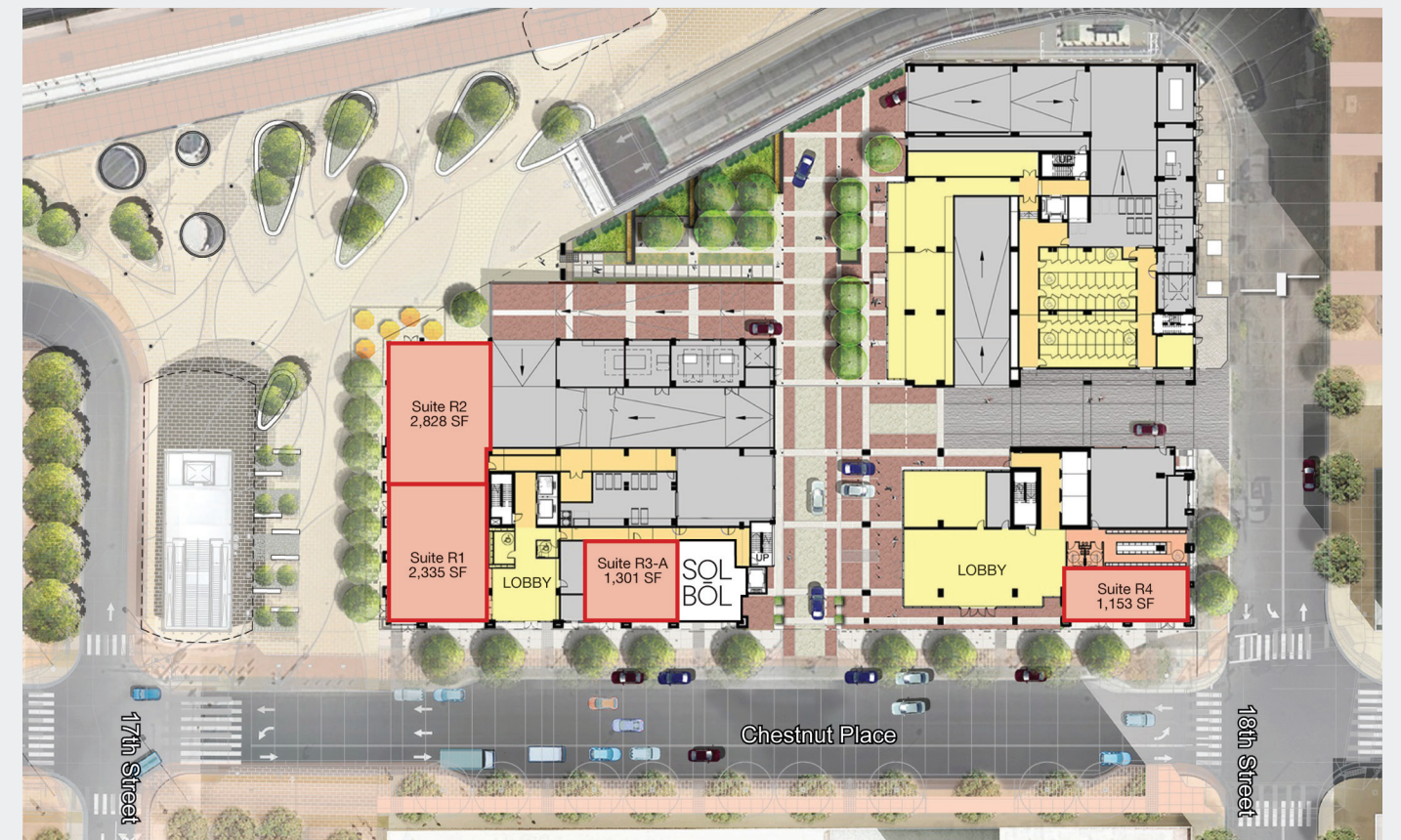

For more information:

Dorit Makovsky Fischer
 303 565 3025
dfischer@shamesmakovsky.com

Hayden Hirschfeld
 303 565 3048
hhirschfeld@shamesmakovsky.com

Cory Dulberg
 303 565 3039
cdulberg@shamesmakovsky.com