

PARK 25

11102 25TH AVE E | BUILDING C | TACOMA, WA 98445

AVAILABLE NOW

3,280 - 6,560
SF AVAILABLE

INDUSTRIAL SPACE WITH OFFICE



AVAILABLE SUITES

Suite	Total SF	Office SF	Comment
A	3,280 SF	60 SF	1 Restroom & 1 GL door
C	3,280 SF	510 SF	1 Restroom & 1 GL door

NNN: \$0.27/SF | CALL FOR RATES

PROPERTY FEATURES

- Quality construction
- Grade-level loading
- Sprinklered
- Ample parking (5 spaces per unit)
- Great access to Hwy-512
- Landlord will consider long term deal

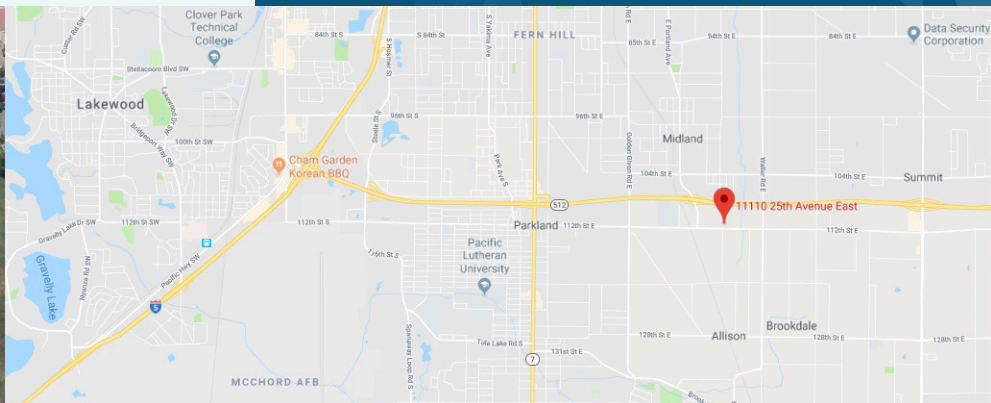

NICK RATZKE
253 779 2414
nratzke@neilwalter.com

BRIANA HICKEY
253 779 2424
bhickey@neilwalter.com

DPi
Davis Property & Investment

W NEIL WALTER
C O M P A N Y

All square footage references are approximate. The information contained herein is from sources deemed reliable. Prospective Buyer or Tenant should conduct an independent investigation and verification of all matters.

SUITE C

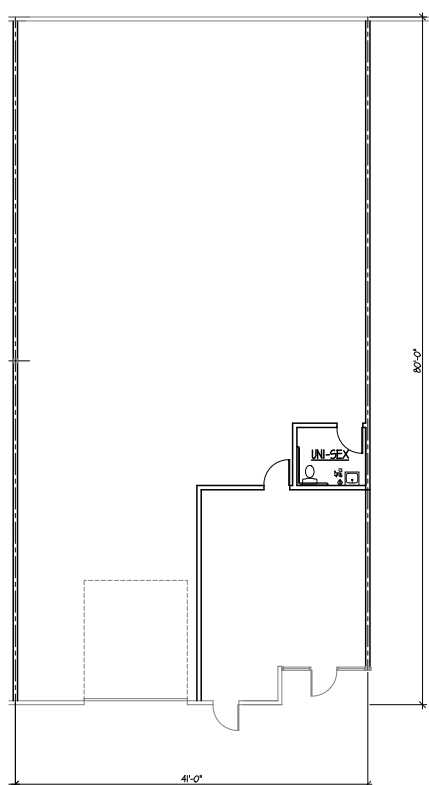

SUITE A

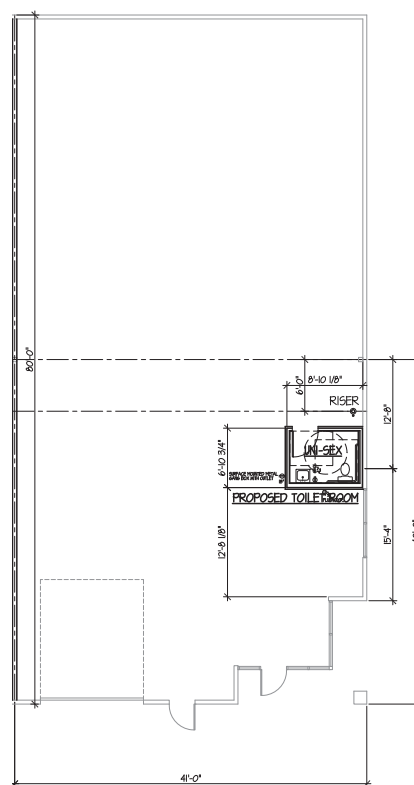

All square footage references are approximate. The information contained herein is from sources deemed reliable. Prospective Buyer or Tenant should conduct an independent investigation and verification of all matters.