

**INDUSTRIAL
SPACE FOR
LEASE**

**2,070 -
23,628 SF**

**EXCELLENT
LOADING
ACCESS**

**HIGH-IMAGE
OFFICES**

Professionally managed by:
VENTURE ONE
REAL ESTATE

TRANSWESTERN
REAL ESTATE
SERVICES

YORKBROOK BUSINESS PARK

121-158 Eisenhower Lane, Lombard, IL 60148

[Property Website](#)



Specifications:

- Gross Building Size: 74,708 SF
- Available Unit Size: 2,070 SF
- Office Size: 902 SF
- Ceiling Height: 15'
- Loading: 1 DID
- Year Built: 1975
- Construction: Masonry
- Heating: Gas
- Lease Rate: \$1,725/Month

Highlights:

- Professionally owned and managed
- On-site property management
- Well-maintained facility
- Great access to I-355 & I-88

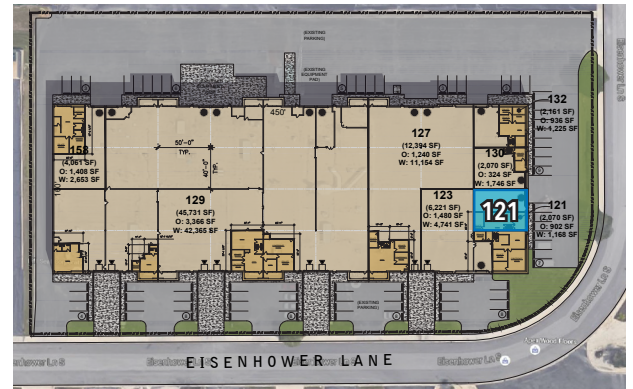

Leasing Information:

Justin Lerner, SIOR
Executive Vice President
847.588.5665
justin.lerner@transwestern.com

Joe Karmin
Executive Vice President
847.588.5670
joe.karmin@transwestern.com

Ross Lehrman
Senior Associate
847.588.5671
ross.lehrman@transwestern.com

The information provided herein was obtained from sources believed reliable; however, Transwestern makes no guarantees, warranties or representations as to the completeness of accuracy thereof. The presentation of this property is submitted subject to errors, omissions, change of price or conditions, prior to sale or lease, or withdrawal without notice. Copyright © 2020 Transwestern.

INDUSTRIAL
SPACE FOR
LEASE

2,070 -
23,628 SF

EXCELLENT
LOADING
ACCESS

HIGH-IMAGE
OFFICES

Professionally managed by:
VENTURE ONE
REAL ESTATE

TRANSWESTERN
REAL ESTATE
SERVICES

YORKBROOK BUSINESS PARK

301-307 Eisenhower Lane, Lombard, IL 60148

[Property Website](#)



Specifications:

- Gross Building Size: 31,446 SF
- Unit 301: 7,918 SF (727 SF Office)
- Unit 303: 7,855 SF (866 SF Office)
- Unit 305: 7,855 SF (578 SF Office)
- Ceiling Height: 15'
- Loading: 1 Dock & 1 DID per unit
- Construction: Masonry
- Year Built: 1981
- Heating: Gas

- Unit 301 Lease Rate: \$6,095/Month
- Unit 303 Lease Rate: \$6,095/Month
- Unit 305 Lease Rate: \$6,095/Month
- Unit 301-305 Lease Rate: STO

Highlights:

- Professionally owned and managed
- On-site property management
- Well-maintained facility
- Great access to I-355 & I-88



Leasing Information:

Justin Lerner, SIOR
Executive Vice President
847.588.5665
justin.lerner@transwestern.com

Joe Karmin
Executive Vice President
847.588.5670
joe.karmin@transwestern.com

Ross Lehrman
Senior Associate
847.588.5671
ross.lehrman@transwestern.com

The information provided herein was obtained from sources believed reliable; however, Transwestern makes no guarantees, warranties or representations as to the completeness of accuracy thereof. The presentation of this property is submitted subject to errors, omissions, change of price or conditions, prior to sale or lease, or withdrawal without notice. Copyright © 2020 Transwestern.

INDUSTRIAL
SPACE FOR
LEASE

2,070 -
23,628 SF

EXCELLENT
LOADING
ACCESS

HIGH-IMAGE
OFFICES

Professionally managed by:
VENTURE ONE
REAL ESTATE

TRANSWESTERN
REAL ESTATE
SERVICES

YORKBROOK BUSINESS PARK

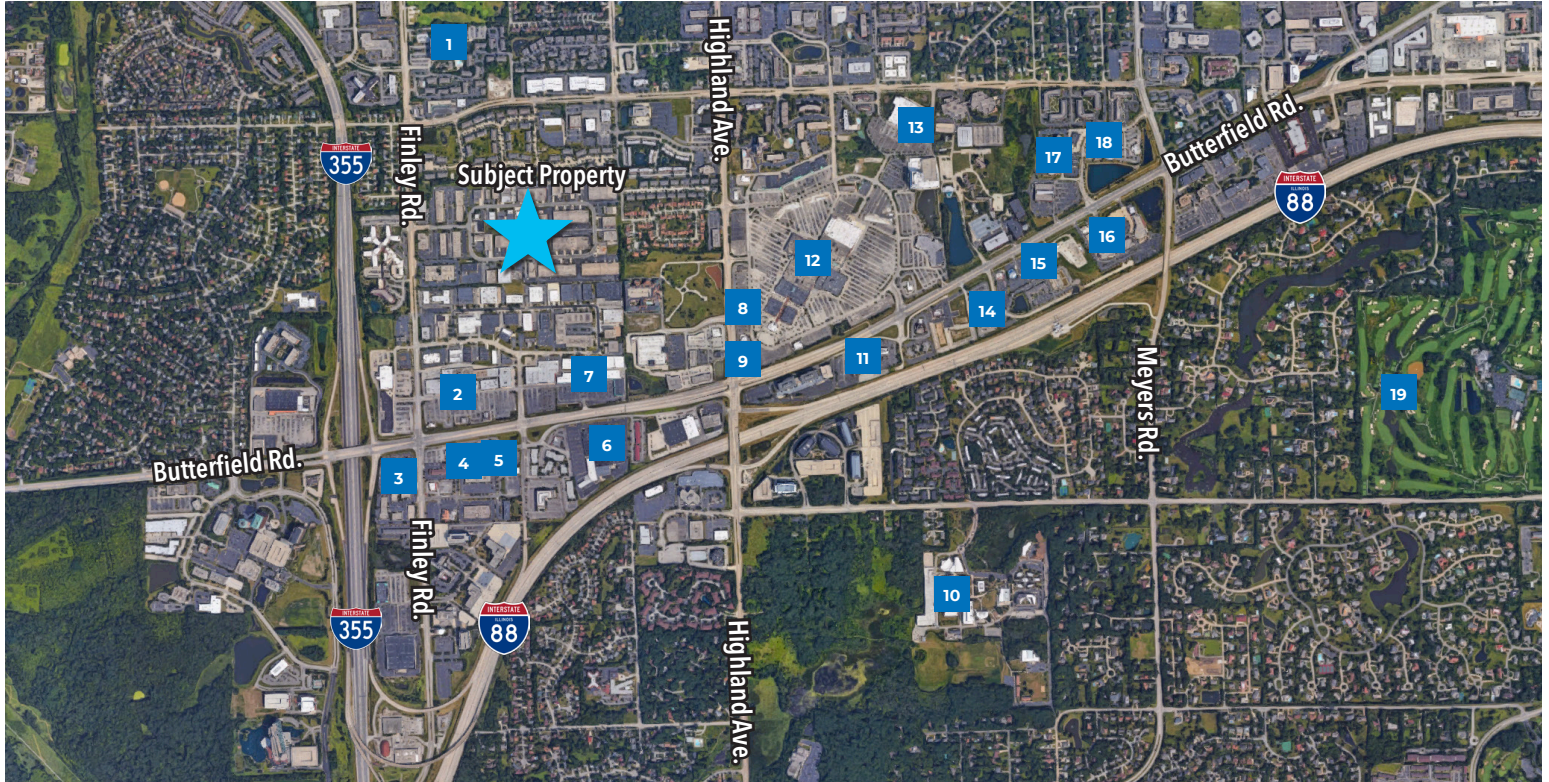

Surrounding Amenities & Services

- | | | | |
|--|---------------------------------|------------------------------------|------------------------------------|
| 1 Four Seasons Park | 6 Olive Garden | 11 Miller's Ale House | 16 Oak Brook Promenade |
| 2 Finley Square Shopping Center | 7 Butterfield Plaza | 12 Yorktown Shopping Center | 17 Uncle Julio's |
| 3 Chama Gaucha Brazilian Steakhouse | 8 Rock Bottom | 13 Target | 18 Hyatt Place |
| 4 Red Lobster | 9 Bucca di Beppo | 14 Embassy Suites by Hilton | 19 Butterfield Country Club |
| 5 Brickhouse Tavern and Tap | 10 Midwestern University | 15 Benihana | |

Leasing Information:

Justin Lerner, SIOR
Executive Vice President
847.588.5665
justin.lerner@transwestern.com

Joe Karmin
Executive Vice President
847.588.5670
joe.karmin@transwestern.com

Ross Lehrman
Senior Associate
847.588.5671
ross.lehrman@transwestern.com