

LAND For Sale

Location: 1650 Yule Road
Side of Street:
City: Addison Twp., MI
Cross Streets: Between Dequindre & Townsend Roads
County: Oakland

Acreage: 228.46
Zoning: Res./Agr.
Improvements: N/A
Dimensions:

UTILITIES

Sanitary Sewer: No
Storm Sewer: No
Water: Yes
Gas: Yes
Outside Storage: No
Rail Siding: No

ADJACENT LAND

North: Res./Agr.
South: Res./Agr.
East: Res./Agr.
West: Res./Agr.

PRICING INFORMATION

Asking Price: \$8,225,000.00
Per Acre: \$36,001.93
Per SqFt: \$0.83
Terms: Cash or Possible Land Contract Terms
Parcel #: 05-25-100-018/See Agent
Assessor Number: N/A
Taxes: \$29,661.73 (2020)

TRAFFIC INFORMATION

Yr: 2020 Count: 575 Dequindre Rd. S. of 34 Mile Rd.
Yr: 2020 Count: 838 Dequindre Rd. N. of 34 Mile Rd.
Yr: 2020 Count: 443 Mack Rd. W. of Dequindre Rd.
Yr: 2020 Count: 636 34 Mile Rd. E. of Dequindre Rd.

DEMOGRAPHICS

	Population	Median HH Income
1 Mile Radius	518	\$104,245
3 Mile Radius	6,088	\$104,403
5 Mile Radius	20,631	\$160,461

Comments: Beautiful property in northern Oakland County. Ideal single-family future development.

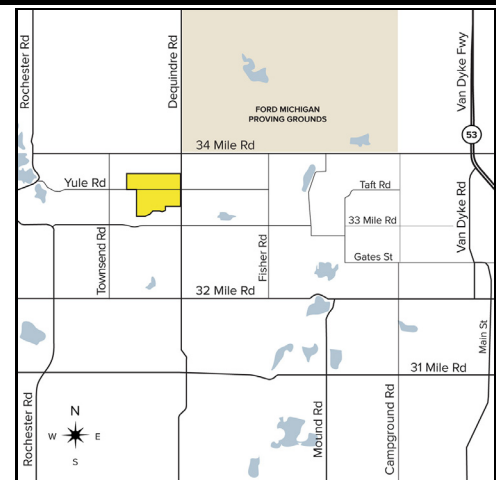

Broker: SIGNATURE ASSOCIATES

Agent(s):

Angela Thomas, (248) 799-3159, aeres@signatureassociates.com
 Erica Dunlap, (248) 799-3159, aeres@signatureassociates.com
 Nicole Voisard, (248) 799-3159, aeres@signatureassociates.com

Information is subject to verification and no liability for errors or omissions is assumed. Price and terms are subject to modification.