



CORFAC INTERNATIONAL



## FOR SALE OR LEASE

20919-20927 JOHN R ROAD  
HAZEL PARK, MICHIGAN

## FOR MORE INFORMATION:

Jason Capitani, SIOR, CCIM  
248.637.7684  
jcapitani@Lmcap.com

Brandon Abdelnour  
248.637.3526  
babdelnour@Lmcap.com

## PROPERTY FEATURES:

- Triplex Building Currently Adjoined for Single Occupant
- Divisible into Units Starting at 1,400 SQ FT
- Main Road Exposure
- Seconds from I-75
- Nicely Finished Offices
- Abundant Parking
- LB-M Zoning Allows for Local Business, Commercial, Retail, and Light Manufacturing

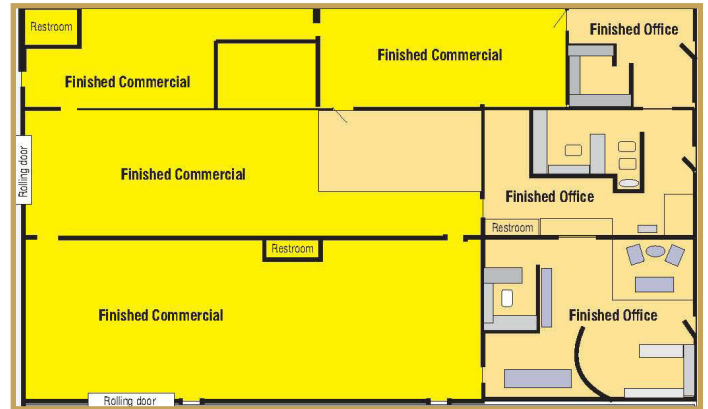

## CONNECT WITH US:



facebook.com/L.MasonCapitaniInc.CORFACInternational  
linkedin.com/company/l.-mason-capitani-inc.

248.637.9700 | [www.Lmcap.com](http://www.Lmcap.com)



## CORFAC INTERNATIONAL

2301 West Big Beaver  
Suite 950  
Troy, MI 48084-3329

(248) 637-9700  
Facsimile (248) 637-9897  
www.Lmcap.com

### EXTERIOR SITE DATA



CLASSIFICATION: Industrial Building

LOCATION: 20919-20927 John R. Rd

CITY: Hazel Park

TOTAL SF 5,800 AVAILABLE SF 5,800

INTERSECTION: John R Rd. / E. 8 Mile FACTORY: 4,600 OFFICE: 1,200

COUNTY: Oakland FREE STANDING: \_\_\_\_\_ AGE: 1961

ACREAGE: 0.57 FRONTAGE: 123.00 DEPTH: 100.00

PARKING: 20 EXPANDABLE: \_\_\_\_\_ STORAGE: \_\_\_\_\_

RAILSIDING: \_\_\_\_\_ X-WAY DISTANCE: 0.4 Mile to I-75 ZONING: Comm./Mfg

### INTERIOR SITE DATA

CLEARANCE MIN: 12 MAX: 12 BAY SIZE: varies LAVATORIES: 3

CRANES: \_\_\_\_\_ CRANE LIST: \_\_\_\_\_ UNDERHOOK: \_\_\_\_\_

POWER: 208/240 AMPS: \_\_\_\_\_ BUSS: \_\_\_\_\_ LIGHTS: Fluorescent

TRUCKWELL: (int) \_\_\_\_\_ + (ext) \_\_\_\_\_ GRADE DOOR: 10' X 10'; 11' X 8'

HEATING: Gas Forced Air A/C: 100% SPRINKLERED: \_\_\_\_\_

AIRLINES: \_\_\_\_\_ COMPRESSOR: \_\_\_\_\_ FLOOR DRAINS: Yes

### ECONOMIC DATA

SALE PRICE: \$308,000.00 PRICE/SF.: \$53.10

LEASE: \$6.95 Gross LEASE/MONTH: \$3,359.17 TAXES: \$8,702.68

ADDITIONAL INFORMATION: Former triplex building currently adjoined for a single occupant. Nicely finished offices. Divisible into units of 1,456 sq ft, 1,952 sq ft and 2,392 sq ft.

AGENT: B. Abdelnour\J. Capitani

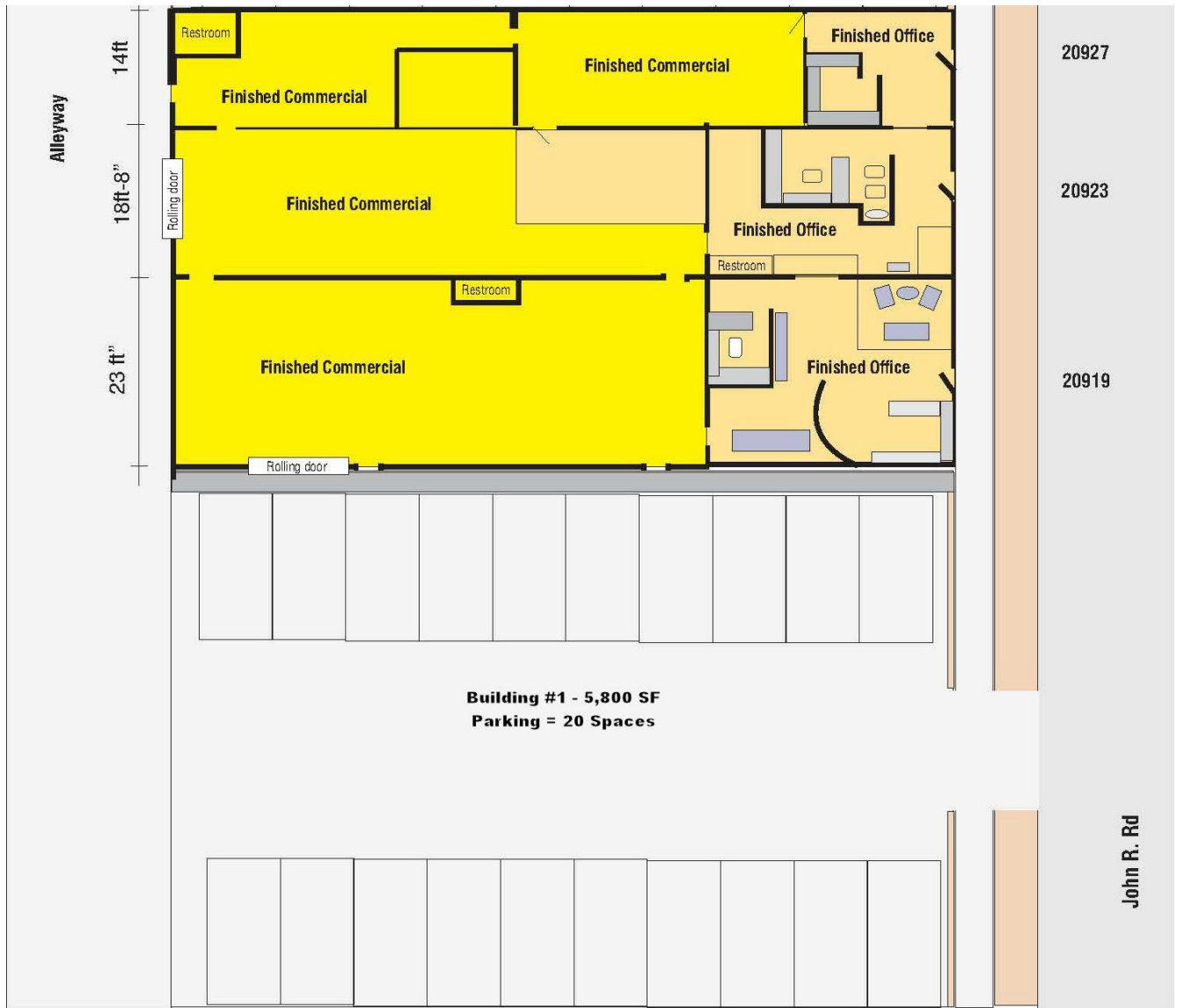

CORFAC INTERNATIONAL

2301 West Big Beaver Rd  
Suite 950  
Troy, Michigan 48084

For More Information, Contact:

Brandon Abdelnour  
[babdelnour@Lmcap.com](mailto:babdelnour@Lmcap.com)

Jason Capitani, SIOR, CCIM  
[jcapitani@Lmcap.com](mailto:jcapitani@Lmcap.com)

248.637.9700  
[www.Lmcap.com](http://www.Lmcap.com)

20919-20927 John R Road  
Hazel Park, Michigan

Floor Plan

5,800 SF

(Drawing Not to Scale - Measurements  
Approximate)