



GOODMANREALESTATE.COM
216.381.8200

STREETSBORO CROSSING

Streetsboro, Ohio



HIGHLIGHTS

- 347,000 SF shopping center anchored by Target, Giant Eagle, Lowe's, and Pet Supplies Plus
- One of the fastest growing areas in northeast Ohio with a trade area in excess of 100,000 people
- Regional location at the intersection of three state highways
- Anchor opportunity available adjacent to Target - up to 43,000 SF divisible
- Multiple outparcels available

DEMOGRAPHICS

POPULATION	3 MILE	5 MILE	7 MILE
2021 Projection	18,626	48,502	127,586
2016 Estimate	18,476	48,178	127,026
INCOME	3 MILE	5 MILE	7 MILE
2016 Average	\$74,125	\$97,606	\$86,598
2016 Median	\$62,882	\$78,254	\$65,180
DAYTIME POPULATION	3 MILE	5 MILE	7 MILE
2016 Employees	12,717	27,149	69,282

LEASING INFORMATION

www.goodmanrealestate.com
216.381.8200

CLEVELAND THE OFFICES AT LEGACY VILLAGE
25333 CEDAR ROAD, SUITE 315
CLEVELAND, OH 44124

COLUMBUS CORPORATE HILL II, SUITE 108
100 W. OLD WILSON BRIDGE ROAD
COLUMBUS, OH 43085

STEVE ALTEMARE

Senior Vice President
steve@goodmanrealestate.com

ZACHARY SOGOLOFF

Senior Vice President
zach@goodmanrealestate.com



LEASING INFORMATION

www.goodmanrealestate.com
216.381.8200

STEVE ALTEMARE
Senior Vice President
steve@goodmanrealestate.com
ZACHARY SOGOLOFF
Senior Vice President
zack@goodmanrealestate.com

STREETSBORO CROSSING

Streetsboro, Ohio



STREETSBORO CROSSING

Streetsboro, Ohio

State Routes 303, 14, & 43

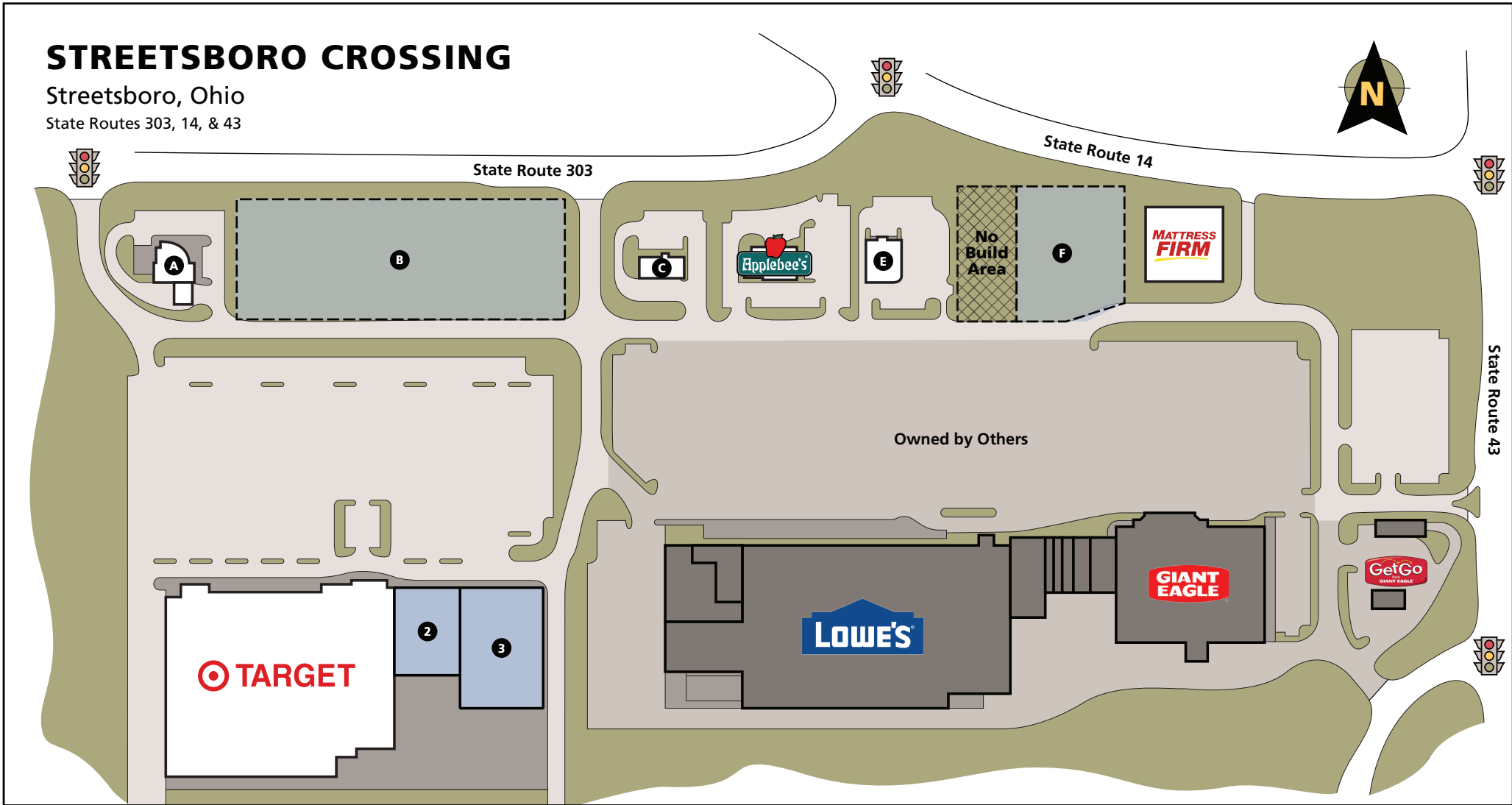

Goodman Real Estate Services Group LLC
 Legacy Village
 25333 Cedar Road, Suite 305
 Lyndhurst, Ohio 44124
 Tel: (216) 381-8200 Fax: (216) 381-8211

For Leasing Information

Please call **(216) 381-8200**
 or visit goodmanrealestate.com

Owned by:
Visconsi Companies, Ltd.

Key

- Available
- Leased
- Not Part

Unit	Tenant	Size (Sq. Ft.)	Unit	Tenant	Size (Sq. Ft.)
1	Target	126,875	E	KeyBank	4,433
2	Available	17,500	F	Available	1.71 Acres
3	Available	22,500			
Outlots					
A	Home Savings Bank	4,346	SITE SUMMARY 375,000 SQ. FT.		
B	Available	2.92 Acres			
C	Kent Credit Union	3,210			
D	Applebee's	4,738			

Disclaimer: The information above has been obtained from sources believed to be reliable. Goodman Real Estate Services Group LLC and its agents, associates, and employees make no guarantee, warranty, or representation about it.