



For Lease: 8,000 - 16,000 SF Available

First Park West Chester II

9810-9816 Windisch Road | West Chester, OH 45069

First Park West Chester II is a 50,000 SF office warehouse building. Great West Chester location with easy access to I-275 and I-75. No earnings tax.

Highlights

Available SF:	8,000 - 16,000
Office SF:	850 - 2,425
Ceiling Height:	20'
Column Spacing:	40' x 50'
Sprinkler System:	Wet
Loading:	5 dock doors 1 drive-in door
Electrical:	120/208v, 450a, 3Phase, 4 wire
Warehouse Lighting:	T5/T8 Hi Bay Fluorescent
Zoning:	M2 Industrial

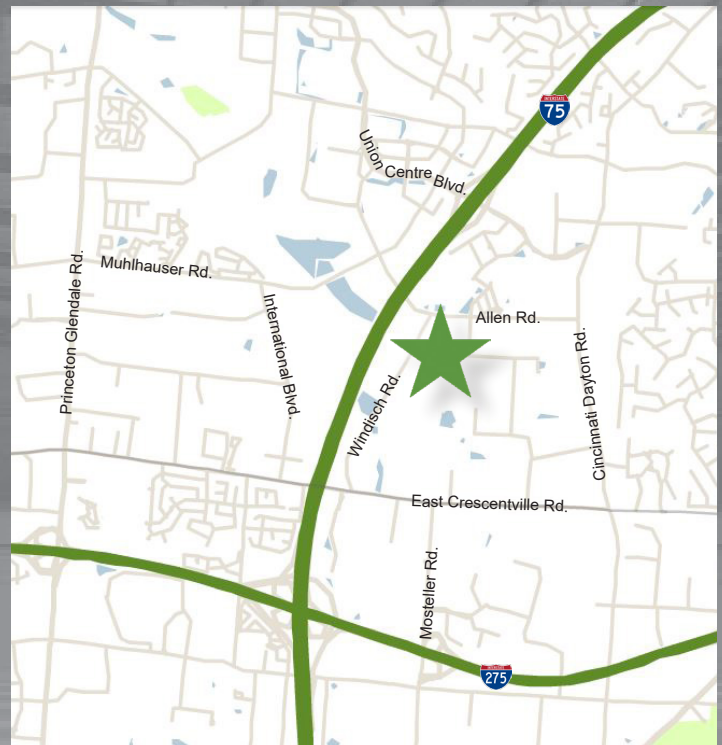

First Park West Chester II

9810-9816 Windisch Road | West Chester, OH 45069

Space Plan

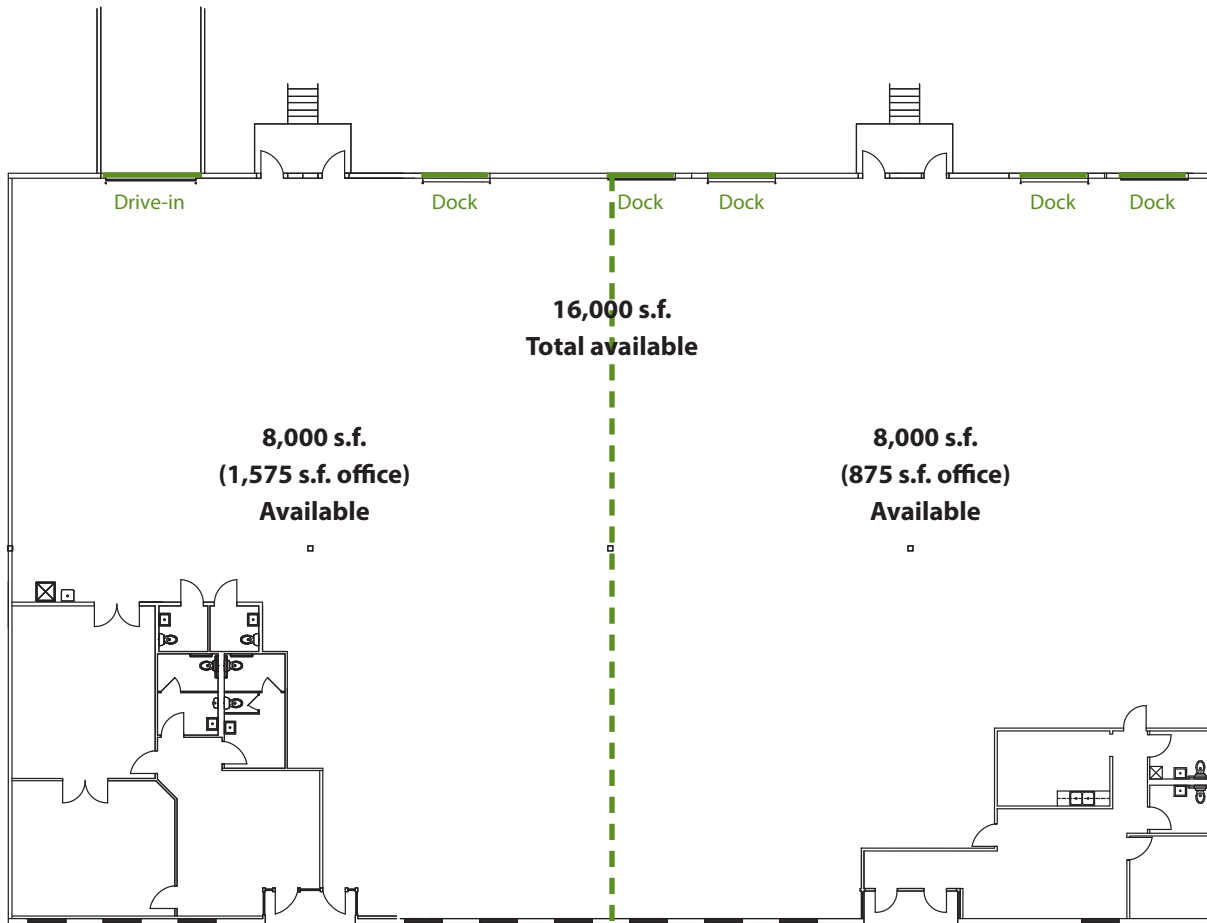

Broker Contact:

Mark G. Volkman, SIOR
Senior Vice President
312 Walnut Street, Suite 3030
Cincinnati, OH 45202
Direct: (513) 252-2123
mark.volkman@am.jll.com



www.jll.com/cincinnati

Owner Contact:

Daniel Meador
Regional Director/Market Leader
1425 Sadlier Circle West Drive
Indianapolis, IN 46239
Direct: (317) 352-8391
dmeador@firstindustrial.com



www.firstindustrial.com