



SOUTHWEST CORNER OF FULTON ST. & BROADWAY

ADJACENT TO FLAGSHIP NEW YORK CITY NOBU AND ANTHROPOLOGIE

- MOST HEAVILY TRAFFICKED RETAIL CORNER IN ALL OF LOWER MANHATTAN.
- MASSIVE EXPOSURE TO AFFLUENT WORK FORCE, LOCAL RESIDENTS AND TOURISTS.
- LOWER MANHATTAN IS AMONG THE MOST VISITED TOURIST DESTINATIONS IN NYC.
- ADJACENT TO THE BUSIEST TRANSPORTATION HUB ON THE EAST COAST.



TOUR	FLOOR	SPACE	CEILING HT	FRONTAGE
	GROUND	4,775 SF	36 FT	75 FT ON BROADWAY
	LOWER LEVEL	5,096 SF	17 FT	70 FT ON FULTON ST.
	TOTAL	9,871 SF		

LEASE TYPE **DIRECT**

POSSESSION **IMMEDIATE**

ASKING RENT **UPON REQUEST**



©2020 CUSHMAN & WAKEFIELD. ALL RIGHTS RESERVED. THE INFORMATION CONTAINED IN THIS COMMUNICATION IS STRICTLY CONFIDENTIAL. THIS INFORMATION HAS BEEN OBTAINED FROM SOURCES BELIEVED TO BE RELIABLE BUT HAS NOT BEEN VERIFIED. NO WARRANTY OR REPRESENTATION, EXPRESS OR IMPLIED, IS MADE AS TO THE CONDITION OF THE PROPERTY (OR PROPERTIES) REFERENCED HEREIN OR AS TO THE ACCURACY OR COMPLETENESS OF THE INFORMATION CONTAINED HEREIN, AND SAME IS SUBMITTED SUBJECT TO ERRORS, OMISSIONS, CHANGE OF PRICE, RENTAL OR OTHER CONDITIONS, WITHDRAWAL WITHOUT NOTICE, AND TO ANY SPECIAL LISTING CONDITIONS IMPOSED BY THE PROPERTY OWNER(S). ANY PROJECTIONS, OPINIONS OR ESTIMATES ARE SUBJECT TO UNCERTAINTY AND DO NOT SIGNIFY CURRENT OR FUTURE PROPERTY PERFORMANCE.

BROADWAY VIEW

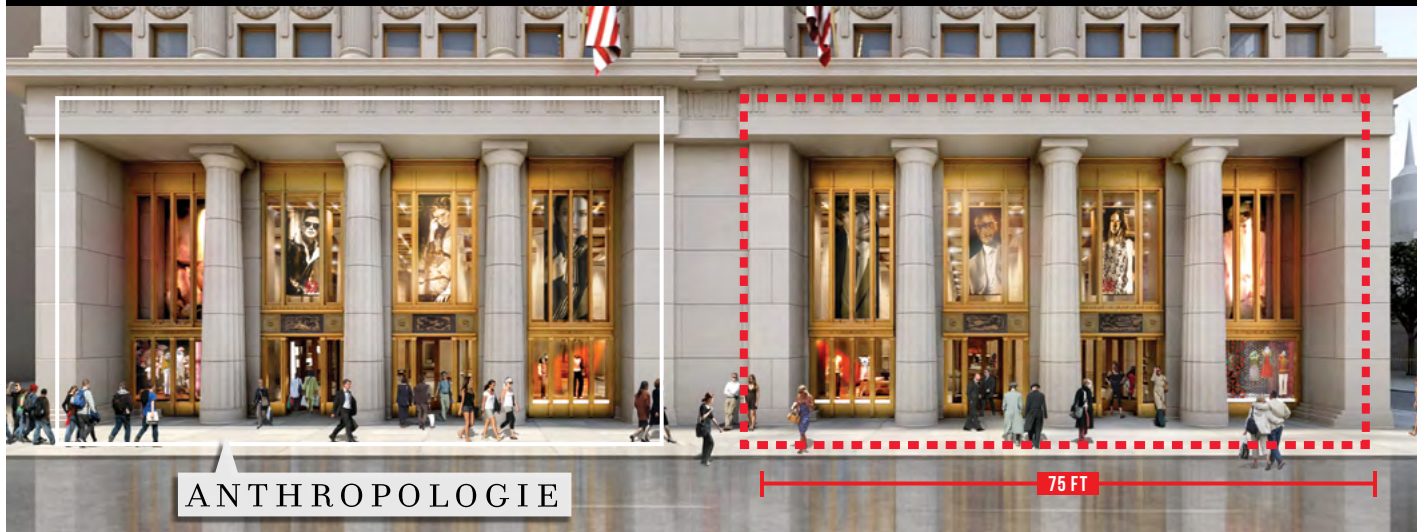

FULTON STREET VIEW



FOR MORE INFORMATION, PLEASE CONTACT:

ALAN SCHMERZLER

212 841 5930 ■ ALAN.SCHMERZLER@CUSHWAKE.COM

STEVEN SOUTENDIJK

212 713 6845 ■ STEVEN.SOUTENDIJK@CUSHWAKE.COM

GROUND FLOOR

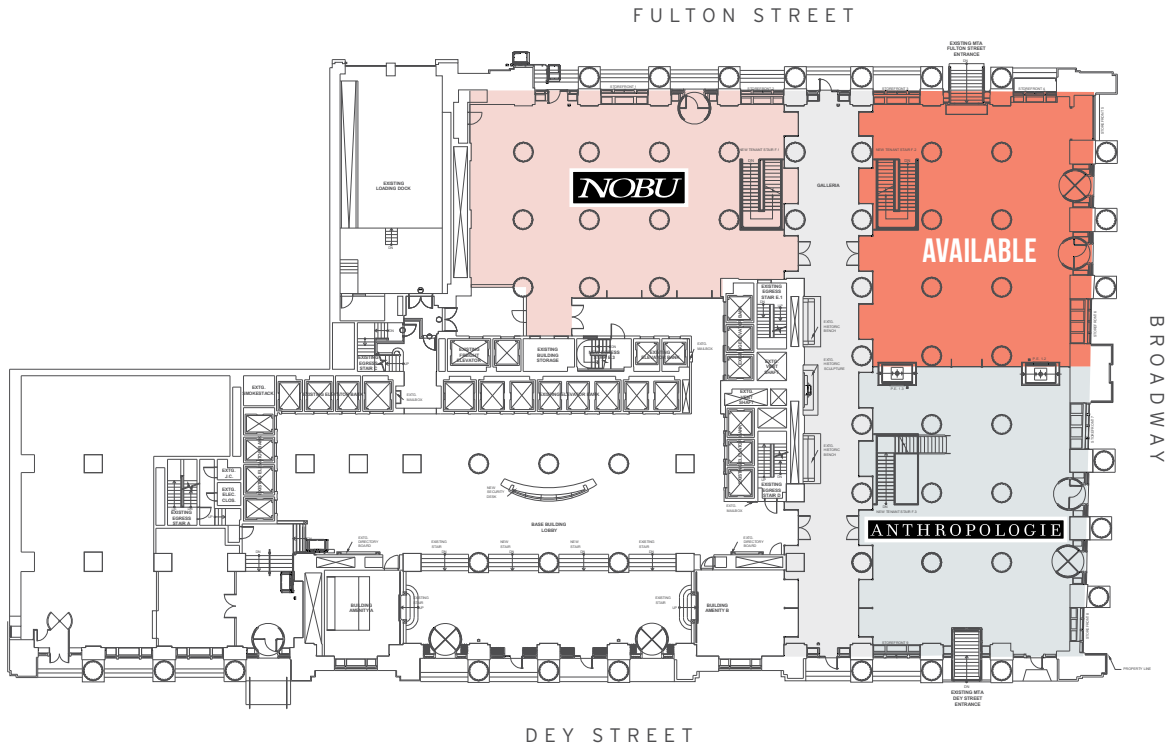

LOWER LEVEL

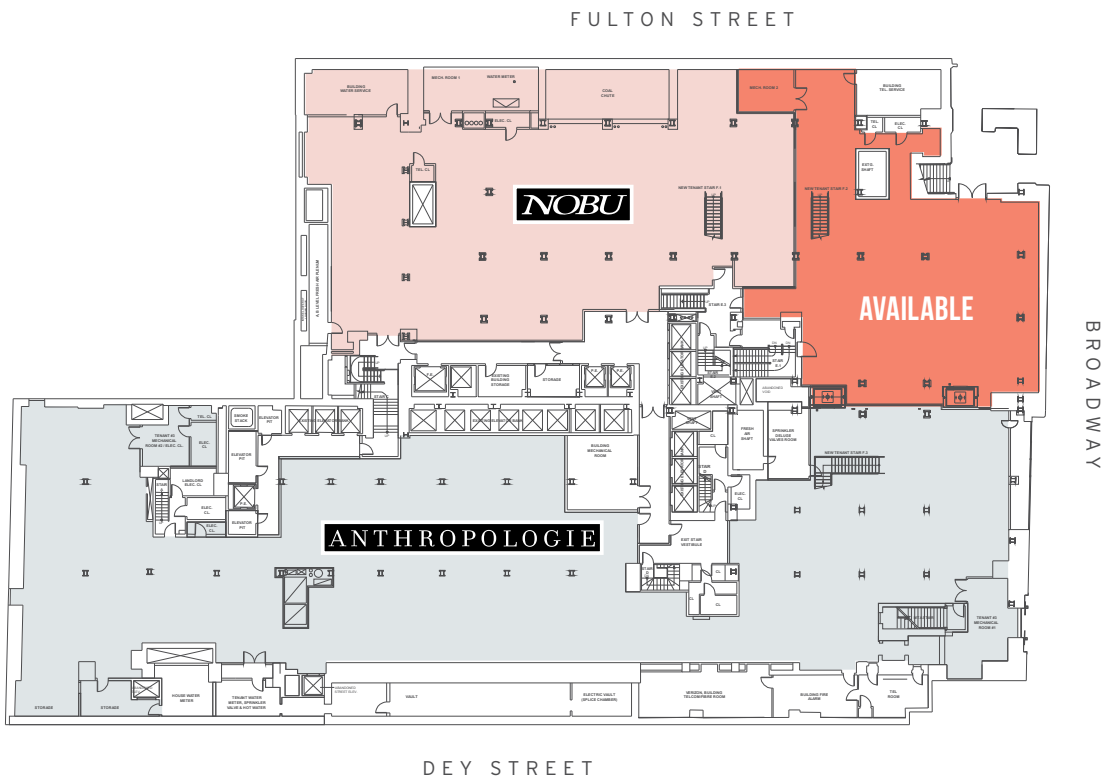

NEIGHBORHOOD STATS

RESIDENTS



\$206,000
AVERAGE HOUSEHOLD INCOME



\$6.5 BILLION
ANNUAL SPENDING POWER



60,000
RESIDENTS

EMPLOYMENT



\$124,000
AVERAGE EMPLOYEE WAGE



88 MILLION SF
OF OFFICE SPACE



267,000 JOBS
HIGHEST LEVEL SINCE 9/11



LOWER MANHATTAN QUICK FACTS



5900 RESIDENTIAL
UNITS

UNDER CONSTRUCTION OR
PLANNED FOR DEVELOPMENT

TOURISTS

14.2 MILLION
TOURISTS IN 2015



24% OF TOURISTS
VISITED LOWER
MANHATTAN IN 2015



14% INCREASE
FROM 2014



48% INCREASE
FROM 2013

HOSPITALITY

5,600
HOTEL ROOMS
IN 26 HOTELS



30%
INCREASE
FROM 2013



8,800
HOTEL ROOMS
IN 44 HOTELS
BY END OF 2019



FOR MORE INFORMATION, PLEASE CONTACT:

ALAN SCHMERZLER

212 841 5930 ■ ALAN.SCHMERZLER@CUSHWAKE.COM

STEVEN SOUTENDIJK

212 713 6845 ■ STEVEN.SOUTENDIJK@CUSHWAKE.COM

NEIGHBORHOOD

